



TEXAS ASSOCIATION OF REALTORS®  
**INFORMATION ABOUT ON-SITE SEWER FACILITY**

USE OF THIS FORM BY PERSONS WHO ARE NOT MEMBERS OF THE TEXAS ASSOCIATION OF REALTORS® IS NOT AUTHORIZED.  
 ©Texas Association of REALTORS®, Inc., 2004

**CONCERNING THE PROPERTY AT**

13502 Palmer Rd  
 Buda, TX 78610

**A. DESCRIPTION OF ON-SITE SEWER FACILITY ON PROPERTY:**

- (1) Type of Treatment System: ☒ Septic Tank ☐ Aerobic Treatment ☐ Unknown
- (2) Type of Distribution System: See attachments ☐ Unknown
- (3) Approximate Location of Drain Field or Distribution System: See attachments ☐ Unknown
- (4) Installer: \_\_\_\_\_ ☒ Unknown
- (5) Approximate Age: 32/24 (septic tank + field A / field B) ☐ Unknown

**B. MAINTENANCE INFORMATION:**

- (1) Is Seller aware of any maintenance contract in effect for the on-site sewer facility? ☐ Yes ☒ No  
 If yes, name of maintenance contractor: \_\_\_\_\_  
 Phone: \_\_\_\_\_ contract expiration date: \_\_\_\_\_  
*Maintenance contracts must be in effect to operate aerobic treatment and certain non-standard on-site sewer facilities.)*
- (2) Approximate date any tanks were last pumped? 2002?
- (3) Is Seller aware of any defect or malfunction in the on-site sewer facility? ☐ Yes ☒ No  
 If yes, explain: \_\_\_\_\_
- (4) Does Seller have manufacturer or warranty information available for review? ☐ Yes ☒ No

**C. PLANNING MATERIALS, PERMITS, AND CONTRACTS:**

- (1) The following items concerning the on-site sewer facility are attached:  
☐ planning materials ☐ permit for original installation ☐ final inspection when OSSF was installed  
☐ maintenance contract ☐ manufacturer information ☐ warranty information ☒ See attachments
- (2) "Planning materials" are the supporting materials that describe the on-site sewer facility that are submitted to the permitting authority in order to obtain a permit to install the on-site sewer facility.
- (3) It may be necessary for a buyer to have the permit to operate an on-site sewer facility transferred to the buyer.

(TAR-1407) 1-7-04

Initialed for Identification by Buyer \_\_\_\_\_ and Seller HH

Page 1 of 2

**D. INFORMATION FROM GOVERNMENTAL AGENCIES:** Pamphlets describing on-site sewer facilities are available from the Texas Agricultural Extension Service. Information in the following table was obtained from Texas Commission on Environmental Quality (TCEQ) on 10/24/2002. The table estimates daily wastewater usage rates. Actual water usage data or other methods for calculating may be used if accurate and acceptable to TCEQ.

<u>Facility</u>	<u>Usage (gal/day) without water- saving devices</u>	<u>Usage (gal/day) with water- saving devices</u>
Single family dwelling (1-2 bedrooms; less than 1,500 sf)	225	180
Single family dwelling (3 bedrooms; less than 2,500 sf)	300	240
Single family dwelling (4 bedrooms; less than 3,500 sf)	375	300
Single family dwelling (5 bedrooms; less than 4,500 sf)	450	360
Single family dwelling (6 bedrooms; less than 5,500 sf)	525	420
Mobile home, condo, or townhouse (1-2 bedroom)	225	180
Mobile home, condo, or townhouse (each add'l bedroom)	75	60

This document is not a substitute for any inspections or warranties. This document was completed to the best of Seller's knowledge and belief on the date signed. Seller and real estate agents are not experts about on-site sewer facilities. Buyer is encouraged to have the on-site sewer facility inspected by an inspector of Buyer's choice.

 3/24/2017  
Signature of Seller Date

**Denise Hazelwood**

\_\_\_\_\_  
Signature of Seller Date

Receipt acknowledged by:

\_\_\_\_\_  
Signature of Buyer Date

\_\_\_\_\_  
Signature of Buyer Date



AUSTIN HEALTH AND HUMAN SERVICES/  
TRAVIS COUNTY HEALTH DEPARTMENT  
PERMIT TO CONSTRUCT SEWERAGE FACILITY

Site Address 7500 Turnersville Road Unique #9669  
Legal Description: Lot 7-A Turnersville Estates, Amending plats of lots 7  
and 8  
Type of Structure: SFRes Size: 3 bdr 1649 sq. ft. Juris. 04  
Owner's Name Denise Hazelwood Date: 8-4-93

AUTHORIZATION IS HEREBY GIVEN TO CONSTRUCT AN ON-SITE SEWERAGE  
FACILITY ON THE ABOVE DESCRIBED PROPERTY WITH THE FOLLOWING  
SPECIFICATIONS

1250 Square Feet of Unlined Evapotranspiration Bed

NOTE: A PLOT PLAN SHOWING APPROXIMATE LOCATION AND DIMENSIONS IS ATTACHED. THIS  
PERMIT MUST BE POSTED.

The issuance of this permit is not a verification that this tract of land has  
been subdivided in accordance with laws and regulations governing  
subdivision of land. It is also not, therefore, a guarantee of the future  
provision of other utility services to this tract of land.

SPECIAL REQUIREMENTS

All installation work in the State of Texas must be performed by  
Texas Dept. of Health Registered Installers as of March 1, 1990.  
The depth of the drainfield must not exceed 18" at any location  
due to potentially high levels of groundwater. Remove any and  
all trees located directly over the existing drainfield. See Plot  
Plan.

Use of EXPLOSIVES is not permitted.

Note: This On-site Sewerage Facility must meet all of the Rules for Travis County, Texas for  
Private Sewerage Facilities including setback distances. If unforeseen and/or adverse conditions are  
encountered (including but not limited to, excessive rock, seepage or high water table), stop  
construction and contact the Health Department. A revised construction permit may be issued.  
THIS PERMIT TO CONSTRUCT SHALL EXPIRE SIX MONTHS FROM ISSUE DATE.

APPROVED:

*Erin L. Conrad, R.S.* DATE *8-5-93*



AUSTIN HEALTH & HUMAN SERVICES  
AND TRAVIS COUNTY HEALTH DEPARTMENT  
ON-SITE SEWERAGE FACILITY DIAGRAM

Date: 8-4-93

Juris: 04

Site Address: 7500 Turnersville Road Unique #9669

Legal Description: Lot 7-A Turnersville Estates, Amend. plats of lts. 7&8

Type of Structure: SFRes Size: 3 bdrm., 1649 sq. ft.

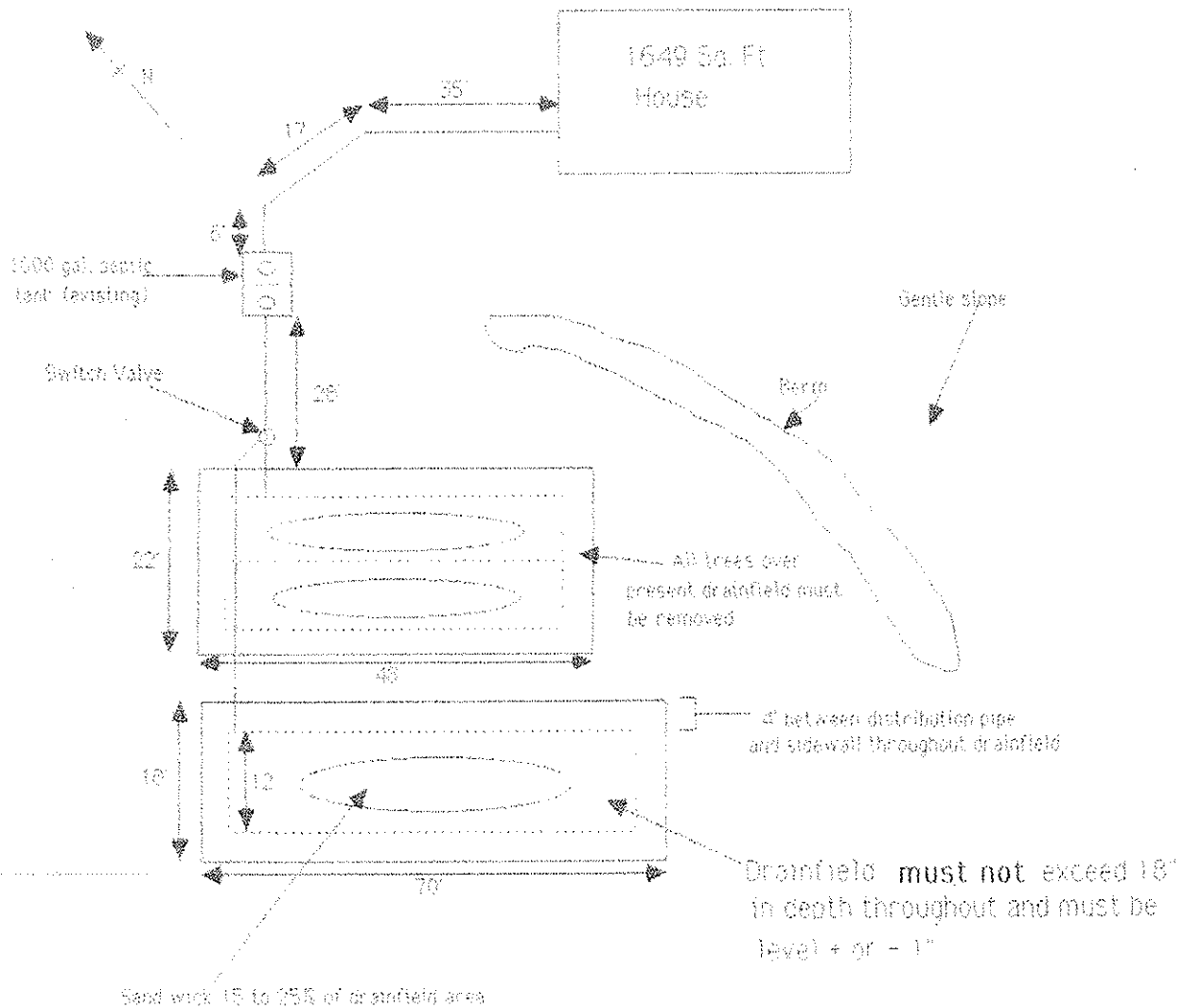

Any of the following will void this License to Operate: modification of the house or building, modification of the on-site sewerage facility, failure of the facility, or placement of structures, driveways or sprinkler systems over the disposal fields.

AUSTIN/TRAVIS COUNTY HEALTH DEPARTMENT  
Environmental Health Services Division  
15 Waller Street  
Austin, Texas 78702  
Telephone: 469-2022

SANITARIAN FIELD INSPECTION REPORT  
FOR  
PRIVATE SEWAGE FACILITIES

Open Pit

Date Aug. 9, 1984 Time 12<sup>06</sup> a.m. APPLICATION NO. 4-061417  
Address 1704 Turnersville Rd. (Buda, Tex.)  
Legal Description Lot #7, Turnersville Estates  
Installer Chad Construction (License 1106-84)  
This report directed to: James Kings (owner)

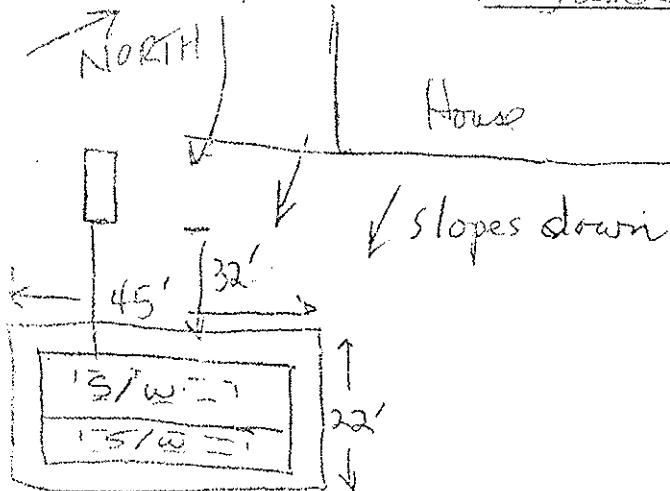

- ① Tank (HCCP) 1000 gallon/2-c
- ② The pit is 30" - 48" deep.
- ③ Pit has level bottom
- ④ Tank is level on sand pad.
- ⑤ Inlet sanitary tee not in place.
- ⑥ Approved for pipe and gravel.

James Kings  
Received by (name & title)

Wilton M. Morgan, R.S.  
Sanitarian

THIS FORM DOES NOT CONSTITUTE A LICENSE TO OPERATE A PRIVATE SEWAGE FACILITY  
IN TRAVIS COUNTY. (FOR ENGINEERED DESIGNED SYSTEMS: THIS REPORT IS NOT A  
SUBSTITUTE FOR ENGINEER'S REVIEW OR INSPECTION.)

469-2022

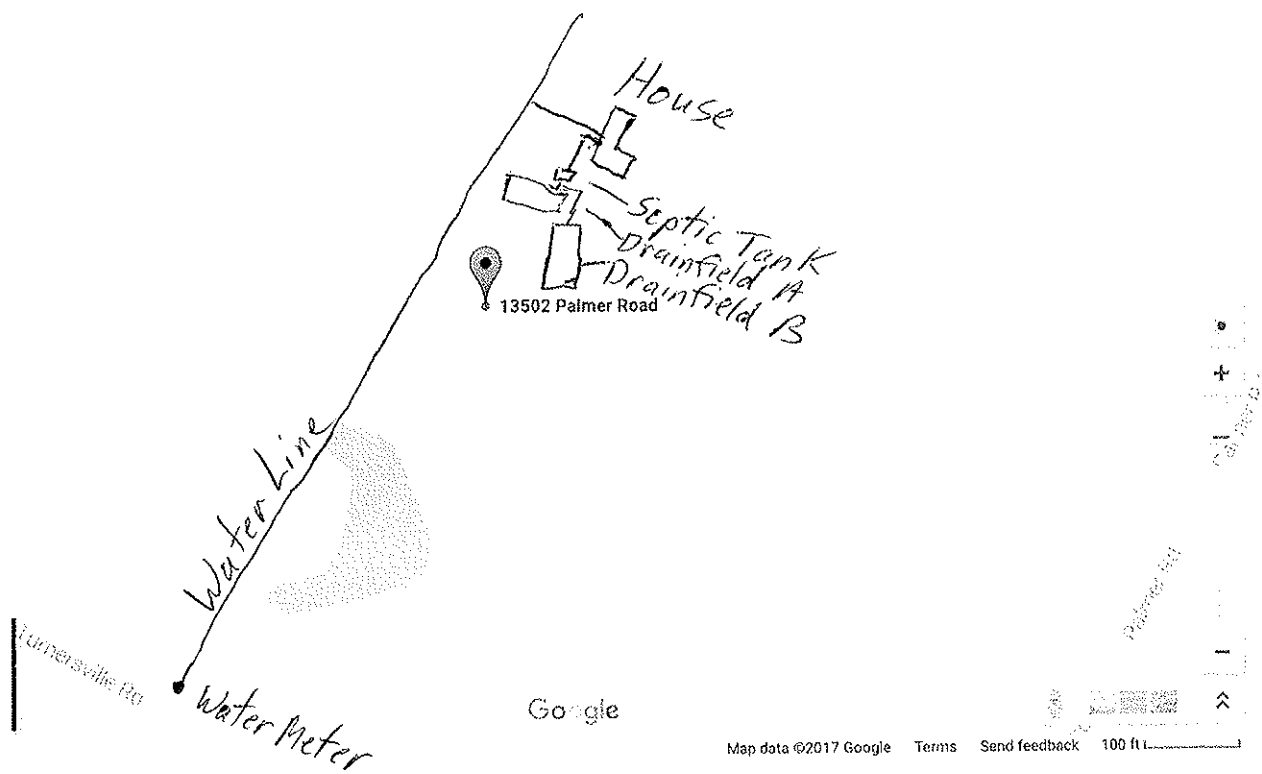

Drawing not to scale.  
(Valve)  
Switch between Septic Tank &  
Drainfields A/B