



TEXAS ASSOCIATION OF REALTORS® SELLER'S DISCLOSURE NOTICE

©Texas Association of REALTORS®, Inc. 2016

Section 5.008, Property Code requires a seller of residential property of not more than one dwelling unit to deliver a Seller's Disclosure Notice to a buyer on or before the effective date of a contract. **This form complies with and contains additional disclosures which exceed the minimum disclosures required by the Code.**

CONCERNING THE PROPERTY AT _____

**6930 CR 146
Bedias, TX 77831**

THIS NOTICE IS A DISCLOSURE OF SELLER'S KNOWLEDGE OF THE CONDITION OF THE PROPERTY AS OF THE DATE SIGNED BY SELLER AND IS NOT A SUBSTITUTE FOR ANY INSPECTIONS OR WARRANTIES THE BUYER MAY WISH TO OBTAIN. IT IS NOT A WARRANTY OF ANY KIND BY SELLER, SELLER'S AGENTS, OR ANY OTHER AGENT.

Seller X is is not occupying the Property. If unoccupied (by Seller), how long since Seller has occupied the Property?
_____ or never occupied the Property

Section 1. The Property has the items marked below: (Mark Yes (Y), No (N), or Unknown (U).)

This notice does not establish the items to be conveyed. The contract will determine which items will & will not convey.

Item	Y	N	U
Cable TV Wiring	<input checked="" type="checkbox"/>	<input type="checkbox"/>	<input type="checkbox"/>
Carbon Monoxide Det.	<input checked="" type="checkbox"/>	<input type="checkbox"/>	<input type="checkbox"/>
Ceiling Fans	<input checked="" type="checkbox"/>	<input type="checkbox"/>	<input type="checkbox"/>
Cooktop	<input checked="" type="checkbox"/>	<input type="checkbox"/>	<input type="checkbox"/>
Dishwasher	<input checked="" type="checkbox"/>	<input type="checkbox"/>	<input type="checkbox"/>
Disposal	<input checked="" type="checkbox"/>	<input type="checkbox"/>	<input type="checkbox"/>
Emergency Escape Ladder(s)	<input type="checkbox"/>	<input type="checkbox"/>	<input checked="" type="checkbox"/>
Exhaust Fans	<input checked="" type="checkbox"/>	<input type="checkbox"/>	<input type="checkbox"/>
Fences	<input checked="" type="checkbox"/>	<input type="checkbox"/>	<input type="checkbox"/>
Fire Detection Equip.	<input checked="" type="checkbox"/>	<input type="checkbox"/>	<input type="checkbox"/>
French Drain	<input type="checkbox"/>	<input type="checkbox"/>	<input checked="" type="checkbox"/>
Gas Fixtures	<input checked="" type="checkbox"/>	<input type="checkbox"/>	<input type="checkbox"/>
Natural Gas Lines	<input type="checkbox"/>	<input type="checkbox"/>	<input type="checkbox"/>

Item	Y	N	U
Liquid Propane Gas:	<input checked="" type="checkbox"/>	<input type="checkbox"/>	<input type="checkbox"/>
-LP Community (Captive)	<input checked="" type="checkbox"/>	<input checked="" type="checkbox"/>	<input type="checkbox"/>
-LP on Property	<input checked="" type="checkbox"/>	<input type="checkbox"/>	<input type="checkbox"/>
Hot Tub	<input type="checkbox"/>	<input checked="" type="checkbox"/>	<input type="checkbox"/>
Intercom System	<input type="checkbox"/>	<input checked="" type="checkbox"/>	<input type="checkbox"/>
Microwave	<input checked="" type="checkbox"/>	<input type="checkbox"/>	<input type="checkbox"/>
Outdoor Grill	<input checked="" type="checkbox"/>	<input type="checkbox"/>	<input type="checkbox"/>
Patio/Decking	<input checked="" type="checkbox"/>	<input type="checkbox"/>	<input type="checkbox"/>
Plumbing System	<input checked="" type="checkbox"/>	<input type="checkbox"/>	<input type="checkbox"/>
Pool	<input type="checkbox"/>	<input type="checkbox"/>	<input checked="" type="checkbox"/>
Pool Equipment	<input type="checkbox"/>	<input checked="" type="checkbox"/>	<input type="checkbox"/>
Pool Maint. Accessories	<input type="checkbox"/>	<input checked="" type="checkbox"/>	<input type="checkbox"/>
Pool Heater	<input type="checkbox"/>	<input checked="" type="checkbox"/>	<input type="checkbox"/>

Item	Y	N	U
Pump: sump grinder	<input type="checkbox"/>	<input type="checkbox"/>	<input checked="" type="checkbox"/>
Rain Gutters	<input type="checkbox"/>	<input checked="" type="checkbox"/>	<input type="checkbox"/>
Range/Stove	<input checked="" type="checkbox"/>	<input type="checkbox"/>	<input type="checkbox"/>
Roof/Attic Vents	<input type="checkbox"/>	<input type="checkbox"/>	<input checked="" type="checkbox"/>
Sauna	<input type="checkbox"/>	<input checked="" type="checkbox"/>	<input type="checkbox"/>
Smoke Detector	<input checked="" type="checkbox"/>	<input type="checkbox"/>	<input type="checkbox"/>
Smoke Detector - Hearing Impaired	<input type="checkbox"/>	<input type="checkbox"/>	<input checked="" type="checkbox"/>
Spa	<input type="checkbox"/>	<input checked="" type="checkbox"/>	<input type="checkbox"/>
Trash Compactor	<input type="checkbox"/>	<input checked="" type="checkbox"/>	<input type="checkbox"/>
TV Antenna	<input type="checkbox"/>	<input checked="" type="checkbox"/>	<input type="checkbox"/>
Washer/Dryer Hookup	<input checked="" type="checkbox"/>	<input type="checkbox"/>	<input type="checkbox"/>
Window Screens	<input checked="" type="checkbox"/>	<input type="checkbox"/>	<input type="checkbox"/>
Public Sewer System	<input type="checkbox"/>	<input checked="" type="checkbox"/>	<input type="checkbox"/>

Item	Y	N	U	Additional Information
Central A/C	<input checked="" type="checkbox"/>	<input type="checkbox"/>	<input type="checkbox"/>	electric gas number of units: _____
Evaporative Coolers	<input type="checkbox"/>	<input checked="" type="checkbox"/>	<input type="checkbox"/>	number of units: _____
Wall/Window AC Units	<input type="checkbox"/>	<input checked="" type="checkbox"/>	<input type="checkbox"/>	number of units: _____
Attic Fan(s)	<input type="checkbox"/>	<input checked="" type="checkbox"/>	<input type="checkbox"/>	if yes, describe: _____
Central Heat	<input checked="" type="checkbox"/>	<input type="checkbox"/>	<input type="checkbox"/>	electric <input checked="" type="checkbox"/> gas number of units: <u>1</u>
Other Heat	<input type="checkbox"/>	<input checked="" type="checkbox"/>	<input type="checkbox"/>	if yes, describe: _____
Oven	<input checked="" type="checkbox"/>	<input type="checkbox"/>	<input type="checkbox"/>	number of ovens: <u>1</u> <input checked="" type="checkbox"/> electric gas other: _____
Fireplace & Chimney	<input type="checkbox"/>	<input checked="" type="checkbox"/>	<input type="checkbox"/>	wood gas logs mock other: _____
Carport	<input checked="" type="checkbox"/>	<input type="checkbox"/>	<input type="checkbox"/>	<input checked="" type="checkbox"/> attached not attached
Garage	<input type="checkbox"/>	<input checked="" type="checkbox"/>	<input type="checkbox"/>	attached not attached
Garage Door Openers	<input type="checkbox"/>	<input checked="" type="checkbox"/>	<input type="checkbox"/>	number of units: _____ number of remotes: _____
Satellite Dish & Controls	<input checked="" type="checkbox"/>	<input type="checkbox"/>	<input type="checkbox"/>	owned <input checked="" type="checkbox"/> lease from: <u>DIRECT TV</u>
Security System	<input type="checkbox"/>	<input checked="" type="checkbox"/>	<input type="checkbox"/>	owned lease from: _____
Water Heater	<input checked="" type="checkbox"/>	<input type="checkbox"/>	<input type="checkbox"/>	electric <input checked="" type="checkbox"/> gas other: _____ number of units: <u>1</u>
Water Softener	<input type="checkbox"/>	<input checked="" type="checkbox"/>	<input type="checkbox"/>	owned lease from: _____
Underground Lawn Sprinkler	<input type="checkbox"/>	<input checked="" type="checkbox"/>	<input type="checkbox"/>	automatic manual areas covered: _____
Septic / On-Site Sewer Facility	<input checked="" type="checkbox"/>	<input type="checkbox"/>	<input type="checkbox"/>	if yes, attach Information About On-Site Sewer Facility (TAR-1407)

(TAR-1406) 01-01-16

Initialed by: Buyer: _____, _____ and Seller: gmp, lcp

Brazos Land Company, 116 S. Main St. Anderson, TX 77830
Lauren Stuart

Phone: (936)873-4000 Fax: (936)873-2301
Produced with zipForm® by zipLogix 18070 Fifteen Mile Road, Fraser, Michigan 48026 www.ziplogix.com

Page 1 of 5
Joe and Kay

Concerning the Property at _____

Water supply provided by: ___ city ☒ well ___ MUD ___ co-op ___ unknown ___ other: _____

Was the Property built before 1978? ___ yes ☒ no ___ unknown

(If yes, complete, sign, and attach TAR-1906 concerning lead-based paint hazards).

Roof Type: metal Age: 2013 (approximate)

Is there an overlay roof covering on the Property (shingles or roof covering placed over existing shingles or roof covering)? ___ yes ___ no ☒ unknown

Are you (Seller) aware of any of the items listed in this Section 1 that are not in working condition, that have defects, or are need of repair? ___ yes ☒ no If yes, describe (attach additional sheets if necessary): _____

Section 2. Are you (Seller) aware of any defects or malfunctions in any of the following?: (Mark Yes (Y) if you are aware and No (N) if you are not aware.)

Item	Y	N
Basement		
Ceilings		
Doors		
Driveways		
Electrical Systems		
Exterior Walls		

Item	Y	N
Floors		
Foundation / Slab(s)		
Interior Walls		
Lighting Fixtures		
Plumbing Systems		
Roof		

Item	Y	N
Sidewalks		
Walls / Fences		
Windows		
Other Structural Components		

If the answer to any of the items in Section 2 is yes, explain (attach additional sheets if necessary): _____

Section 3. Are you (Seller) aware of any of the following conditions: (Mark Yes (Y) if you are aware and No (N) if you are not aware.)

Condition	Y	N
Aluminum Wiring		<input checked="" type="checkbox"/>
Asbestos Components		<input checked="" type="checkbox"/>
Diseased Trees: oak wilt		<input checked="" type="checkbox"/>
Endangered Species/Habitat on Property		<input checked="" type="checkbox"/>
Fault Lines		<input checked="" type="checkbox"/>
Hazardous or Toxic Waste		<input checked="" type="checkbox"/>
Improper Drainage		<input checked="" type="checkbox"/>
Intermittent or Weather Springs		<input checked="" type="checkbox"/>
Landfill		<input checked="" type="checkbox"/>
Lead-Based Paint or Lead-Based Pt. Hazards		<input checked="" type="checkbox"/>
Encroachments onto the Property		<input checked="" type="checkbox"/>
Improvements encroaching on others' property		<input checked="" type="checkbox"/>
Located in 100-year Floodplain	<input checked="" type="checkbox"/>	
Located in Floodway		<input checked="" type="checkbox"/>
Present Flood Ins. Coverage (If yes, attach TAR-1414)		<input checked="" type="checkbox"/>
Previous Flooding into the Structures		<input checked="" type="checkbox"/>
Previous Flooding onto the Property	<input checked="" type="checkbox"/>	
Located in Historic District		<input checked="" type="checkbox"/>
Historic Property Designation		<input checked="" type="checkbox"/>
Previous Use of Premises for Manufacture of Methamphetamine		<input checked="" type="checkbox"/>

Condition	Y	N
Previous Foundation Repairs		<input checked="" type="checkbox"/>
Previous Roof Repairs		<input checked="" type="checkbox"/>
Other Structural Repairs		<input checked="" type="checkbox"/>
Radon Gas		<input checked="" type="checkbox"/>
Settling		<input checked="" type="checkbox"/>
Soil Movement		<input checked="" type="checkbox"/>
Subsurface Structure or Pits		<input checked="" type="checkbox"/>
Underground Storage Tanks		<input checked="" type="checkbox"/>
Unplatted Easements		<input checked="" type="checkbox"/>
Unrecorded Easements		<input checked="" type="checkbox"/>
Urea-formaldehyde Insulation		<input checked="" type="checkbox"/>
Water Penetration		<input checked="" type="checkbox"/>
Wetlands on Property		<input checked="" type="checkbox"/>
Wood Rot		<input checked="" type="checkbox"/>
Active infestation of termites or other wood destroying insects (WDI)		<input checked="" type="checkbox"/>
Previous treatment for termites or WDI		<input checked="" type="checkbox"/>
Previous termite or WDI damage repaired		<input checked="" type="checkbox"/>
Previous Fires	<input checked="" type="checkbox"/>	
Termite or WDI damage needing repair		<input checked="" type="checkbox"/>
Single Blockable Main Drain in Pool/Hot Tub/Spa*		<input checked="" type="checkbox"/>

Concerning the Property at _____

If the answer to any of the items in Section 3 is yes, explain (attach additional sheets if necessary):

a building on the property burned down prior to our purchase in either 2014 or 2015. This building was not affected at all see back regarding flood plain:

*A single blockable main drain may cause a suction entrapment hazard for an individual.

Section 4. Are you (Seller) aware of any item, equipment, or system in or on the Property that is in need of repair, which has not been previously disclosed in this notice? ☐ yes ☒ no If yes, explain (attach additional sheets if necessary): _____

Section 5. Are you (Seller) aware of any of the following (Mark Yes (Y) if you are aware. Mark No (N) if you are not aware.)

Y N

☒ Room additions, structural modifications, or other alterations or repairs made without necessary permits or not in compliance with building codes in effect at the time.

☒ Homeowners' associations or maintenance fees or assessments. If yes, complete the following:

Name of association: _____

Manager's name: _____

Phone: _____

Fees or assessments are: \$ _____ per _____ and are: ☐ mandatory ☐ voluntary

Any unpaid fees or assessment for the Property? ☐ yes (\$ _____) ☐ no

If the Property is in more than one association, provide information about the other associations below or attach information to this notice.

☒ Any common area (facilities such as pools, tennis courts, walkways, or other) co-owned in undivided interest with others. If yes, complete the following:

Any optional user fees for common facilities charged? ☐ yes ☐ no If yes, describe: _____

☒ Any notices of violations of deed restrictions or governmental ordinances affecting the condition or use of the Property.

☒ Any lawsuits or other legal proceedings directly or indirectly affecting the Property. (Includes, but is not limited to: divorce, foreclosure, heirship, bankruptcy, and taxes.)

☒ Any death on the Property except for those deaths caused by: natural causes, suicide, or accident unrelated to the condition of the Property.

☒ Any condition on the Property which materially affects the health or safety of an individual.

☒ Any repairs or treatments, other than routine maintenance, made to the Property to remediate environmental hazards such as asbestos, radon, lead-based paint, urea-formaldehyde, or mold.

If yes, attach any certificates or other documentation identifying the extent of the remediation (for example, certificate of mold remediation or other remediation).

☒ Any rainwater harvesting system located on the Property that is larger than 500 gallons and that uses a public water supply as an auxiliary water source.

☒ The Property is located in a propane gas system service area owned by a propane distribution system retailer.

☒ Any portion of the Property that is located in a groundwater conservation district or a subsidence district.

portions of this property are in a flood plain.
This building is not in the flood plain.
Drainage work and channels have been graded
so as to carry water away from this building.
I am not aware of any water to this building,
per the previous owners. In the time we
have owned the property there has not
been any flooding of this building.

In a heavy rain event water may
breach the banks of the creek that
borders the property but it has not, to
my knowledge, caused flooding to this
house. Water recedes very quickly
down the creek.

Concerning the Property at _____

If the answer to any of the items in Section 5 is yes, explain (attach additional sheets if necessary): _____

Section 6. Seller ☒ has _____ has not attached a survey of the Property.

Section 7. Within the last 4 years, have you (Seller) received any written inspection reports from persons who regularly provide inspections and who are either licensed as inspectors or otherwise permitted by law to perform inspections? ☐ yes ☐ no If yes, attach copies and complete the following:

Inspection Date	Type	Name of Inspector	No. of Pages

Note: A buyer should not rely on the above-cited reports as a reflection of the current condition of the Property. A buyer should obtain inspections from inspectors chosen by the buyer.

Section 8. Check any tax exemption(s) which you (Seller) currently claim for the Property:

☐ Homestead ☐ Senior Citizen ☐ Disabled
☒ Wildlife Management ☐ Agricultural ☐ Disabled Veteran
☐ Other: _____ ☐ Unknown

Section 9. Have you (Seller) ever filed a claim for damage to the Property with any insurance provider? ☐ yes ☒ no

Section 10. Have you (Seller) ever received proceeds for a claim for damage to the Property (for example, an insurance claim or a settlement or award in a legal proceeding) and not used the proceeds to make the repairs for which the claim was made? ☐ yes ☒ no If yes, explain: _____

Section 11. Does the property have working smoke detectors installed in accordance with the smoke detector requirements of Chapter 766 of the Health and Safety Code? ☐ unknown ☐ no ☒ yes. If no or unknown, explain. (Attach additional sheets if necessary): _____

**Chapter 766 of the Health and Safety Code requires one-family or two-family dwellings to have working smoke detectors installed in accordance with the requirements of the building code in effect in the area in which the dwelling is located, including performance, location, and power source requirements. If you do not know the building code requirements in effect in your area, you may check unknown above or contact your local building official for more information.*

A buyer may require a seller to install smoke detectors for the hearing impaired if: (1) the buyer or a member of the buyer's family who will reside in the dwelling is hearing-impaired; (2) the buyer gives the seller written evidence of the hearing impairment from a licensed physician; and (3) within 10 days after the effective date, the buyer makes a written request for the seller to install smoke detectors for the hearing-impaired and specifies the locations for installation. The parties may agree who will bear the cost of installing the smoke detectors and which brand of smoke detectors to install.

Concerning the Property at _____

6930 CR 146
Bedias, TX 77831

Seller acknowledges that the statements in this notice are true to the best of Seller's belief and that no person, including the broker(s), has instructed or influenced Seller to provide inaccurate information or to omit any material information.

Kay P Pyland Apr. 10 2017 Joe M Pyland by Kay Pyland
Signature of Seller Date Signature of Seller Date
Printed Name: Kay P Pyland Printed Name: Joe M Pyland

ADDITIONAL NOTICES TO BUYER:

- (1) The Texas Department of Public Safety maintains a database that the public may search, at no cost, to determine if registered sex offenders are located in certain zip code areas. To search the database, visit www.txdps.state.tx.us. For information concerning past criminal activity in certain areas or neighborhoods, contact the local police department.
- (2) If the property is located in a coastal area that is seaward of the Gulf Intracoastal Waterway or within 1,000 feet of the mean high tide bordering the Gulf of Mexico, the property may be subject to the Open Beaches Act or the Dune Protection Act (Chapter 61 or 63, Natural Resources Code, respectively) and a beachfront construction certificate or dune protection permit may be required for repairs or improvements. Contact the local government with ordinance authority over construction adjacent to public beaches for more information.
- (3) If you are basing your offers on square footage, measurements, or boundaries, you should have those items independently measured to verify any reported information.
- (4) The following providers currently provide service to the property:

Electric: Mid South Synergy
Sewer: _____
Water: _____
Cable: Direct TV
Trash: _____
Natural Gas: _____
Phone Company: _____
Propane: J+B

phone #: 936 825-5100
phone #: _____
phone #: _____
phone #: _____
phone #: _____
phone #: _____
phone #: _____
phone #: 936-348-5465

- (5) This Seller's Disclosure Notice was completed by Seller as of the date signed. The brokers have relied on this notice as true and correct and have no reason to believe it to be false or inaccurate. YOU ARE ENCOURAGED TO HAVE AN INSPECTOR OF YOUR CHOICE INSPECT THE PROPERTY.

The undersigned Buyer acknowledges receipt of the foregoing notice.

Signature of Buyer _____ Date _____ Signature of Buyer _____ Date _____
Printed Name: _____ Printed Name: _____



TEXAS ASSOCIATION OF REALTORS®
INFORMATION ABOUT SPECIAL FLOOD HAZARD AREAS

USE OF THIS FORM BY PERSONS WHO ARE NOT MEMBERS OF THE TEXAS ASSOCIATION OF REALTORS® IS NOT AUTHORIZED.
©Texas Association of REALTORS®, Inc., 2014

CONCERNING THE PROPERTY AT

**6930 CR 146
Bedias, TX 77831**

A. FLOOD AREAS:

- (1) The Federal Emergency Management Agency (FEMA) designates areas that have a high risk of flooding as special flood hazard areas.
- (2) A property that is in a special flood hazard area lies in a "V-Zone" or "A-Zone" as noted on flood insurance rate maps. Both V-Zone and A-Zone areas are areas with high risk of flooding.
- (3) Some properties may also lie in the "floodway" which is the channel of a river or other watercourse and the adjacent land areas that must be reserved in order to discharge a flood under FEMA rules. Communities must regulate development in these floodways.

B. AVAILABILITY OF FLOOD INSURANCE:

- (1) Generally, flood insurance is available regardless of whether the property is located in or out of a special flood hazard area. Contact your insurance agent to determine if any limitations or restrictions apply to the property in which you are interested.
- (2) FEMA encourages every property owner to purchase flood insurance regardless of whether the property is in a high, moderate, or low risk flood area.
- (3) A homeowner may obtain flood insurance coverage (up to certain limits) through the National Flood Insurance Program. Supplemental coverage is available through private insurance carriers.
- (4) A mortgage lender making a federally related mortgage will require the borrower to maintain flood insurance if the property is in a special flood hazard area.

C. GROUND FLOOR REQUIREMENTS:

- (1) Many homes in special flood hazard areas are built-up or are elevated. In elevated homes the ground floor typically lies below the base flood elevation and the first floor is elevated on piers, columns, posts, or piles. The base flood elevation is the highest level at which a flood is likely to occur as shown on flood insurance rate maps.
- (2) Federal, state, county, and city regulations:
 - (a) restrict the use and construction of any ground floor enclosures in elevated homes that are in special flood hazard areas.
 - (b) may prohibit or restrict the remodeling, rebuilding, and redevelopment of property and improvements in the floodway.
- (3) The first floor of all homes must now be built above the base flood elevation.
 - (a) Older homes may have been built in compliance with applicable regulations at the time of construction and may have first floors that lie below the base flood elevation, but flood insurance rates for such homes may be significant.

- (b) It is possible that modifications were made to a ground floor enclosure after a home was first built. The modifications may or may not comply with applicable regulations and may or may not affect flood insurance rates.
- (c) It is important for a buyer to determine if the first floor of a home is elevated at or above the base flood elevation. It is also important for a buyer to determine if the property lies in a floodway.
- (4) Ground floor enclosures that lie below the base flood elevation may be used only for: (i) parking; (ii) storage; and (iii) building access. Plumbing, mechanical, or electrical items in ground floor enclosures that lie below the base flood elevation may be prohibited or restricted and may not be eligible for flood insurance coverage. Additionally:
 - (a) in A-Zones, the ground floor enclosures below the base flood elevation must have flow-through vents or openings that permit the automatic entry and exit of floodwaters;
 - (b) in V-Zones, the ground floor enclosures must have break-away walls, screening, or lattice walls; and
 - (c) in floodways, the remodeling or reconstruction of any improvements may be prohibited or otherwise restricted.

D. COMPLIANCE:

- (1) The above-referenced property may or may not comply with regulations affecting ground floor enclosures below the base flood elevation.
- (2) A property owner's eligibility to purchase or maintain flood insurance, as well as the cost of the flood insurance, is dependent on whether the property complies with the regulations affecting ground floor enclosures.
- (3) A purchaser or property owner may be required to remove or modify a ground floor enclosure that is not in compliance with city or county building requirements or is not entitled to an exemption from such requirements.
- (4) A flood insurance policy maintained by the current property owner does not mean that the property is in compliance with the regulations affecting ground floor enclosures or that the buyer will be able to continue to maintain flood insurance at the same rate.
- (5) Insurance carriers calculate the cost of flood insurance using a rate that is based on the elevation of the lowest floor.
 - (a) If the ground floor lies below the base flood elevation and does not meet federal, state, county, and city requirements, the ground floor will be the lowest floor for the purpose of computing the rate.
 - (b) If the property is in compliance, the first elevated floor will be the lowest floor and the insurance rate will be significantly less than the rate for a property that is not in compliance.
 - (c) If the property lies in a V-Zone the flood insurance rate will be impacted if a ground floor enclosure below the base flood elevation exceeds 299 square feet (even if constructed with break-away walls).



TEXAS ASSOCIATION OF REALTORS®
INFORMATION ABOUT ON-SITE SEWER FACILITY

USE OF THIS FORM BY PERSONS WHO ARE NOT MEMBERS OF THE TEXAS ASSOCIATION OF REALTORS® IS NOT AUTHORIZED.
 ©Texas Association of REALTORS®, Inc., 2004

CONCERNING THE PROPERTY AT

**6930 CR 146
 Bedias, TX 77831**

A. DESCRIPTION OF ON-SITE SEWER FACILITY ON PROPERTY:

- (1) Type of Treatment System: ☒ Septic Tank ☐ Aerobic Treatment ☐ Unknown
- (2) Type of Distribution System: ☒ Unknown
- (3) Approximate Location of Drain Field or Distribution System: ☐ Unknown
SITE DRAWING ATTACHED
- (4) Installer: Billy Surface ☐ Unknown
- (5) Approximate Age: 4-13-2004 13 yrs ☐ Unknown

B. MAINTENANCE INFORMATION:

- (1) Is Seller aware of any maintenance contract in effect for the on-site sewer facility? ☐ Yes ☒ No
 If yes, name of maintenance contractor: _____
 Phone: _____ contract expiration date: _____
Maintenance contracts must be in effect to operate aerobic treatment and certain non-standard on-site sewer facilities.)
- (2) Approximate date any tanks were last pumped? April 2017
- (3) Is Seller aware of any defect or malfunction in the on-site sewer facility? ☐ Yes ☐ No
 If yes, explain: _____
- (4) Does Seller have manufacturer or warranty information available for review? ☐ Yes ☒ No

C. PLANNING MATERIALS, PERMITS, AND CONTRACTS:

- (1) The following items concerning the on-site sewer facility are attached:
☒ planning materials ☐ permit for original installation ☐ final inspection when OSSF was installed
☐ maintenance contract ☐ manufacturer information ☐ warranty information ☐ _____
- (2) "Planning materials" are the supporting materials that describe the on-site sewer facility that are submitted to the permitting authority in order to obtain a permit to install the on-site sewer facility.
- (3) **It may be necessary for a buyer to have the permit to operate an on-site sewer facility transferred to the buyer.**

D. INFORMATION FROM GOVERNMENTAL AGENCIES: Pamphlets describing on-site sewer facilities are available from the Texas Agricultural Extension Service. Information in the following table was obtained from Texas Commission on Environmental Quality (TCEQ) on 10/24/2002. The table estimates daily wastewater usage rates. Actual water usage data or other methods for calculating may be used if accurate and acceptable to TCEQ.

<u>Facility</u>	<u>Usage (gal/day) without water- saving devices</u>	<u>Usage (gal/day) with water- saving devices</u>
Single family dwelling (1-2 bedrooms; less than 1,500 sf)	225	180
Single family dwelling (3 bedrooms; less than 2,500 sf)	300	240
Single family dwelling (4 bedrooms; less than 3,500 sf)	375	300
Single family dwelling (5 bedrooms; less than 4,500 sf)	450	360
Single family dwelling (6 bedrooms; less than 5,500 sf)	525	420
Mobile home, condo, or townhouse (1-2 bedroom)	225	180
Mobile home, condo, or townhouse (each add'l bedroom)	75	60

This document is not a substitute for any inspections or warranties. This document was completed to the best of Seller's knowledge and belief on the date signed. Seller and real estate agents are not experts about on-site sewer facilities. Buyer is encouraged to have the on-site sewer facility inspected by an inspector of Buyer's choice.

Joe M. Pyland by Kay Pyland
Signature of Seller Date
Joe M. Pyland

Kay P. Pyland Apr 10 2017
Signature of Seller Date
Kay P. Pyland

Receipt acknowledged by:

Signature of Buyer Date

Signature of Buyer Date

E. ELEVATION CERTIFICATE:

The elevation certificate is an important tool in determining flood insurance rates. It is used to provide elevation information that is necessary to ensure compliance with floodplain management laws. To determine the proper insurance premium rate, insurers rely on an elevation certificate to certify building elevations at an acceptable level above flood map levels. If available in your area, it is recommended that you obtain an elevation certificate for the property as soon as possible to accurately determine future flood insurance rates.

You are encouraged to: (1) inspect the property for all purposes, including compliance with any ground floor enclosure requirement; (2) review the flood insurance policy (costs and coverage) with your insurance agent; and (3) contact the building permitting authority if you have any questions about building requirements or compliance issues.

Receipt acknowledged by:

Signature

Date

Signature

Date

- Location of two soil borings or two excavated backhoe pits (show location with respect to a known reference point).
- Indicate slope or provide contour lines from the structure to the farthest location of the proposed soil absorption or irrigation area.
- Location of natural, constructed, or proposed drainage ways, (streams, ponds, lakes, rivers, high tide of salt water bodies) water impoundment areas, cut or fill bank, sharp slopes and breaks. Note presence of 100 year flood zone.
- Location of existing or proposed adjacent streets, property lines, property dimensions, location of buildings, easements, swimming pools, public water wells and lines, private water wells and lines, and other structures where known on adjacent property.

Site Drawing

Scale: 1 inch =
1 INCH = 100.0 FEET

BOB JOHNSON

6 WILDFLOWER TRACE PLACE
THE WOODLANDS, TX 77382
281 465 7072

Compass North

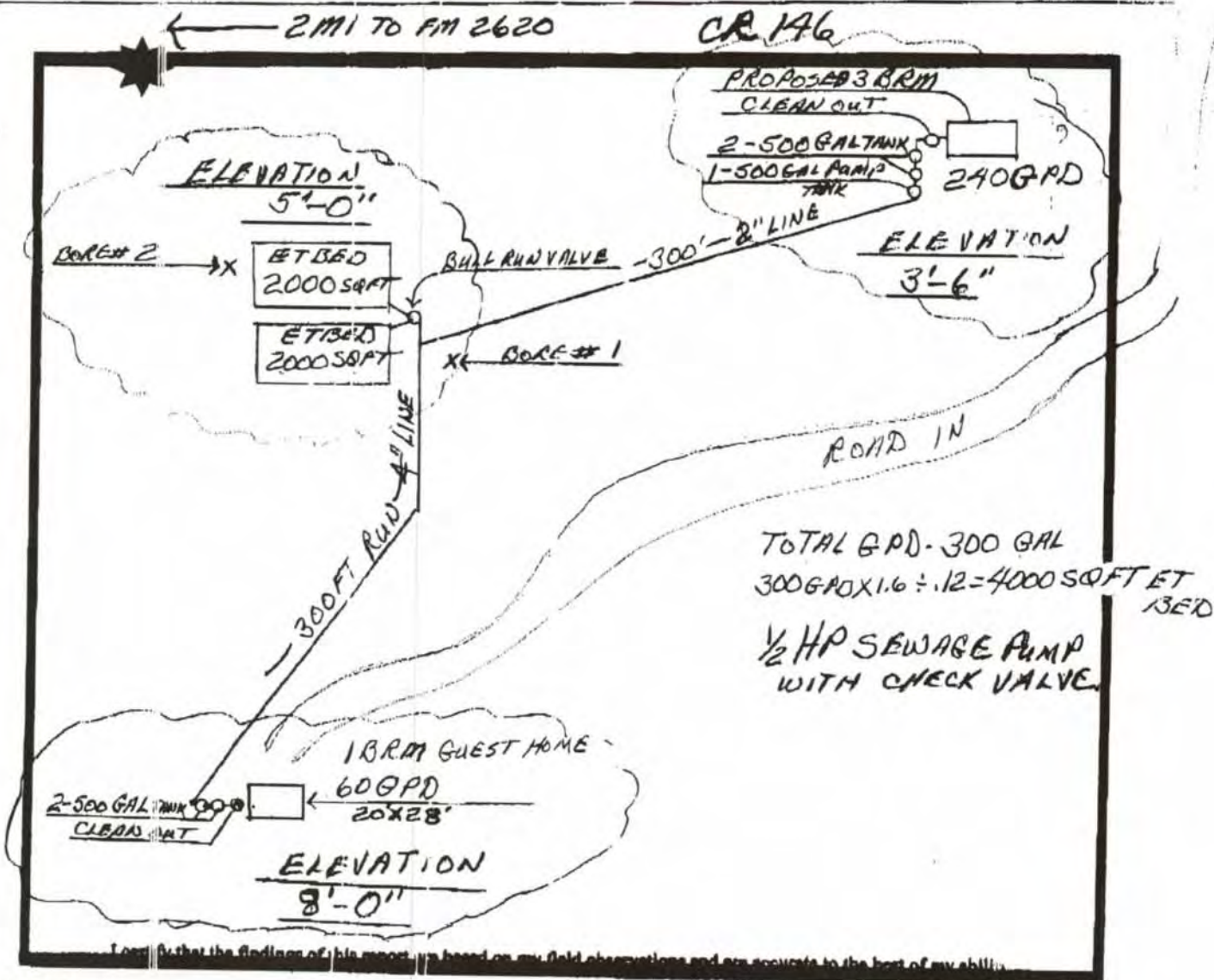

Site Evaluator:

Name:

Bill Hegar

Signature:

BILL HEGAR 055314

Cert. No.