

# Tillable Soils Map

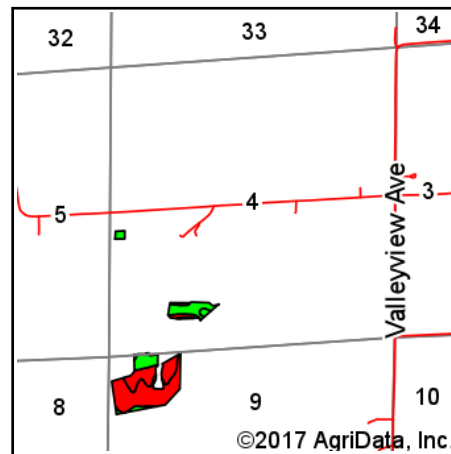

State: **Iowa**  
 County: **Madison**  
 Location: **4-74N-26W**  
 Township: **Ohio**  
 Acres: **27.08**  
 Date: **2/1/2017**

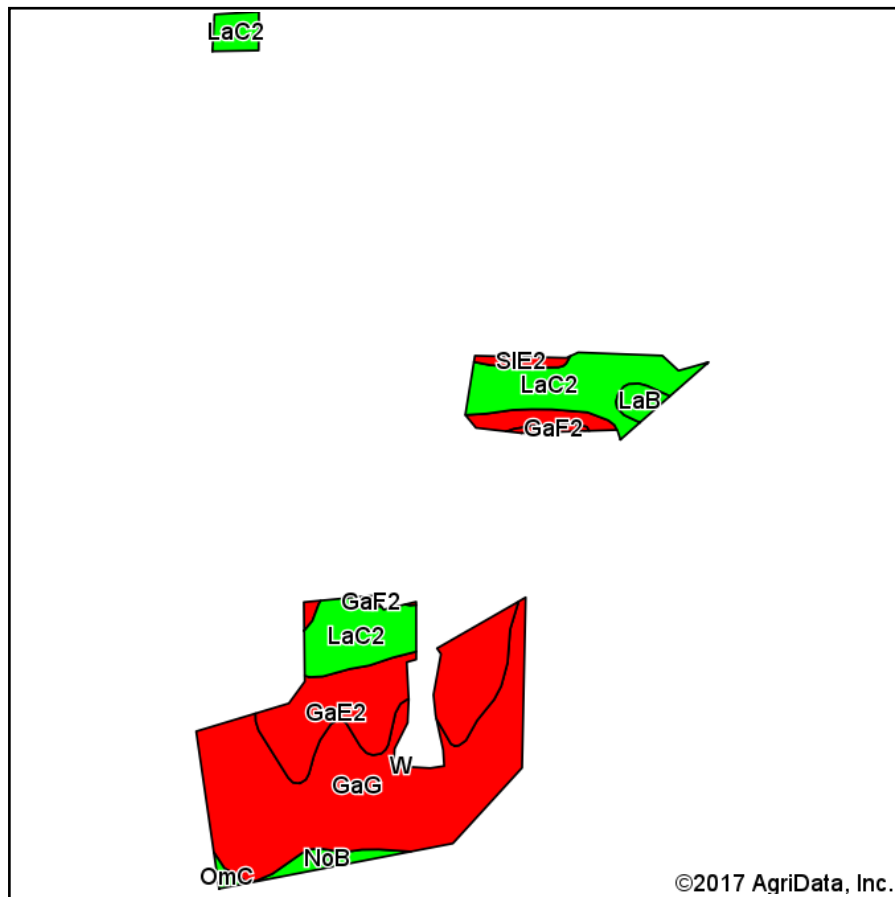

## Area Symbol: IA121, Soil Area Version: 20

Code	Soil Description	Acres	Percent of field	CSR2 Legend	Non-Irr Class *c	CSR2**	CSR
GaG	Gara loam, 25 to 40 percent slopes	12.34	45.6%		VIIe	5	5
LaC2	Ladoga silt loam, 5 to 9 percent slopes, moderately eroded	6.40	23.6%		IIIe	78	62
GaE 2	Gara loam, 14 to 18 percent slopes, moderately eroded	5.88	21.7%		VIe	35	33
SIE2	Shelby-Lamoni complex, 14 to 18 percent slopes, moderately eroded	1.07	4.0%		VIe	27	10
NoB	Nodaway-Martinsburg silt loams, 2 to 5 percent slopes	0.58	2.1%		Vw	77	60
LaB	Ladoga silt loam, 2 to 5 percent slopes	0.44	1.6%		Ile	86	82
GaF2	Gara loam, 18 to 25 percent slopes, moderately eroded	0.22	0.8%		VIIe	17	13
OmC	Olmitz loam, 5 to 9 percent slopes	0.15	0.6%		IIIe	85	57
Weighted Average						33	27.5

Area Symbol: IA121, Soil Area Version: 20

\*\*IA has updated the CSR values for each county to CSR2.

\*c: Using Capabilities Class Dominant Condition Aggregation Method

Soils data provided by USDA and NRCS.