

Marshall Co., AL

SEE PHOTOS ON
WEB SITE!

www.cypruspartners.com

Reference # 357

More info at
256-527-4050

Land For Sale
40 acres +/-
\$144,000

Exclusive Agent For Owner

CYPRUS
PARTNERS

P O Box 590045
Homewood, AL 35259

- Located in western Marshall County about 15 minutes north of Arab and 30 minutes south of Huntsville
- Paved road frontage with utilities
- A gorgeous property with several nice home sites
- A 1.5 acre pond and small stream are on the property
- Mostly timbered but there are 2 or 3 acres of native warm season grasses under a powerline that crosses the property

All distances and acres are estimates and should be independently verified

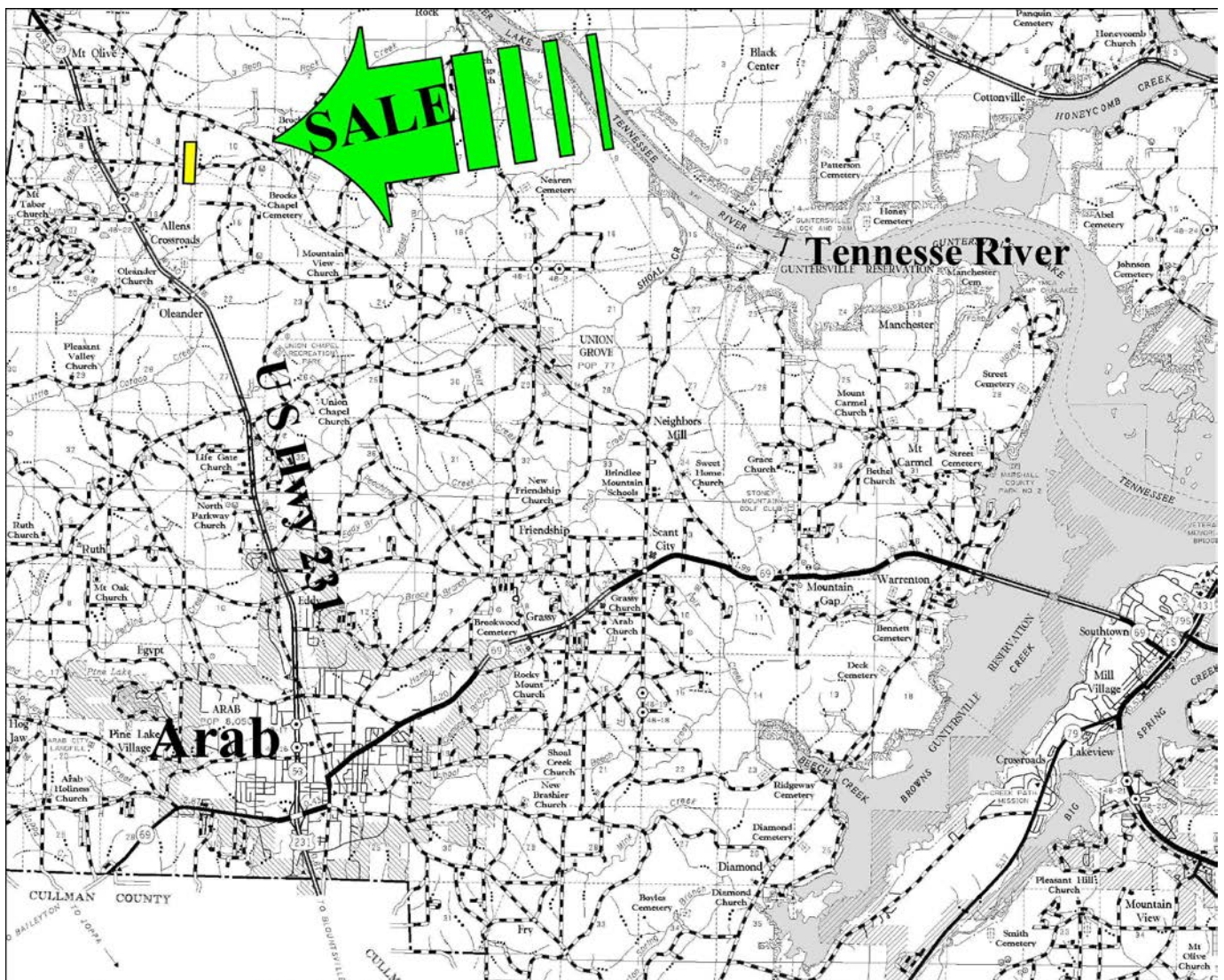

NOTICE: Investment in land carries risk. Prospective buyers should understand and independently verify the risk factors before buying this property. All information furnished by Cyprus Partners about this property has been obtained from sources believed to be reliable. However, neither Cyprus Partners nor the property owner makes any representation or warranty as to completeness or accuracy. This property is subject to prior sale, price change and withdrawal from the market without notice. No representation or warranty is made, express or implied, as to the condition of the property, boundaries, and fitness for any particular use, Fair Market Value, access, acres, zoning, or condition of title.

Directions from the intersection of U S Highway 231 and AL Hwy 69 in Arab: (15 minutes to the property.

- Head north on U S Hwy 231 away from Arab and go 8.3 miles
- Take a right on Allens Cross Road and go 1.1 miles
- Take a right on Midway Rd and go 0.2 miles to the west line of the property. The property is on both sides of the road for the next 660 feet
- The intersection of the west line of the property with Midway Rd is located at Lat: 34° 26' 17.8"N.; Lon: 86° 31' 46.7" W.

