

# Soils Map

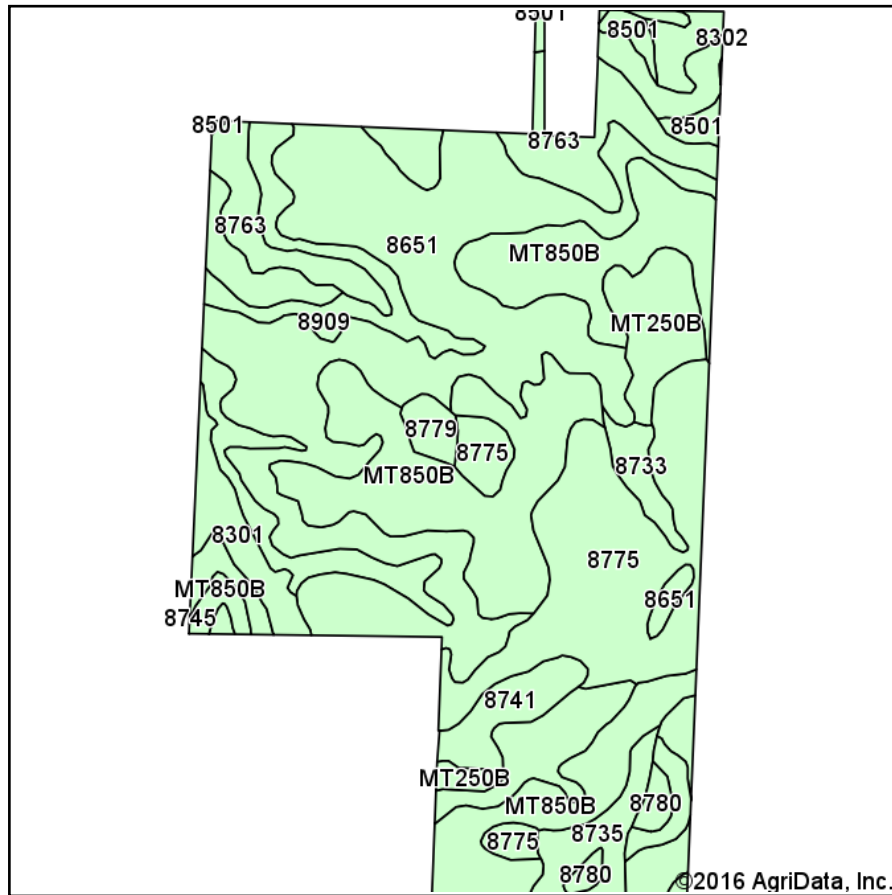

Soils data provided by USDA and NRCS.

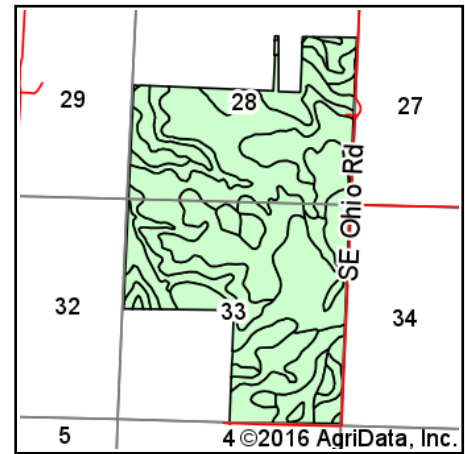

State: **Kansas**  
 County: **Anderson**  
 Location: **33-21S-20E**  
 Township: **Lincoln**  
 Acres: **843.7**  
 Date: **8/22/2016**



## Area Symbol: KS003, Soil Area Version: 15

Code	Soil Description	Acres	Percent of field	Non-Irr Class *c	Range Production (lbs/acre/yr)	Grain sorghum	Soybeans	Winter wheat
8651	Clareson-Rock outcrop complex, 1 to 3 percent slopes	272.41	32.3%	Vls	3275			
MT850B	Wagstaff silty clay loam, 1 to 3 percent slopes	183.67	21.8%	IIIe	5120			
8775	Kenoma silt loam, 1 to 3 percent slopes	115.74	13.7%	IIIe	3888			
8763	Eram-Talihina silty clay loams, 5 to 20 percent slopes	56.52	6.7%	VIe	4026			
8909	Stony land-Talihina complex, 15 to 45 percent slopes	53.52	6.3%	VIIe	1515			
8301	Verdigris silt loam, 0 to 1 percent slopes, frequently flooded	47.33	5.6%	Vw	8048			
MT250B	Aliceville silty clay loam, 1 to 3 percent slopes	29.23	3.5%	Ile	5120			
8741	Eram soils, 3 to 7 percent slopes, eroded	18.89	2.2%	IVe	4100	48	15	19
8735	Eram silty clay loam, 3 to 7 percent slopes	18.64	2.2%	IVe	4158			
8733	Eram silty clay loam, 1 to 3 percent slopes	10.00	1.2%	IIIe	4173			
8962	Woodson silt loam, 1 to 3 percent slopes	8.90	1.1%	IIs	4465			
8501	Mason silt loam, 0 to 1 percent slopes, rarely flooded	8.47	1.0%	Iw	8250			
8779	Kenoma silty clay loam, 1 to 3 percent slopes, eroded	7.07	0.8%	IIIe	3865			
8849	Olpe gravelly silt loam, 3 to 15 percent slopes	6.95	0.8%	VIe	4682			
8780	Kenoma-Olpe complex, 3 to 7 percent slopes	6.36	0.8%	IIIe	4441			
Weighted Average					4167.5	1.1	0.3	0.4

Area Symbol: KS003, Soil Area Version: 15

\*c: Using Capabilities Class Dominant Condition Aggregation Method

Soils data provided by USDA and NRCS.