

Soils Map

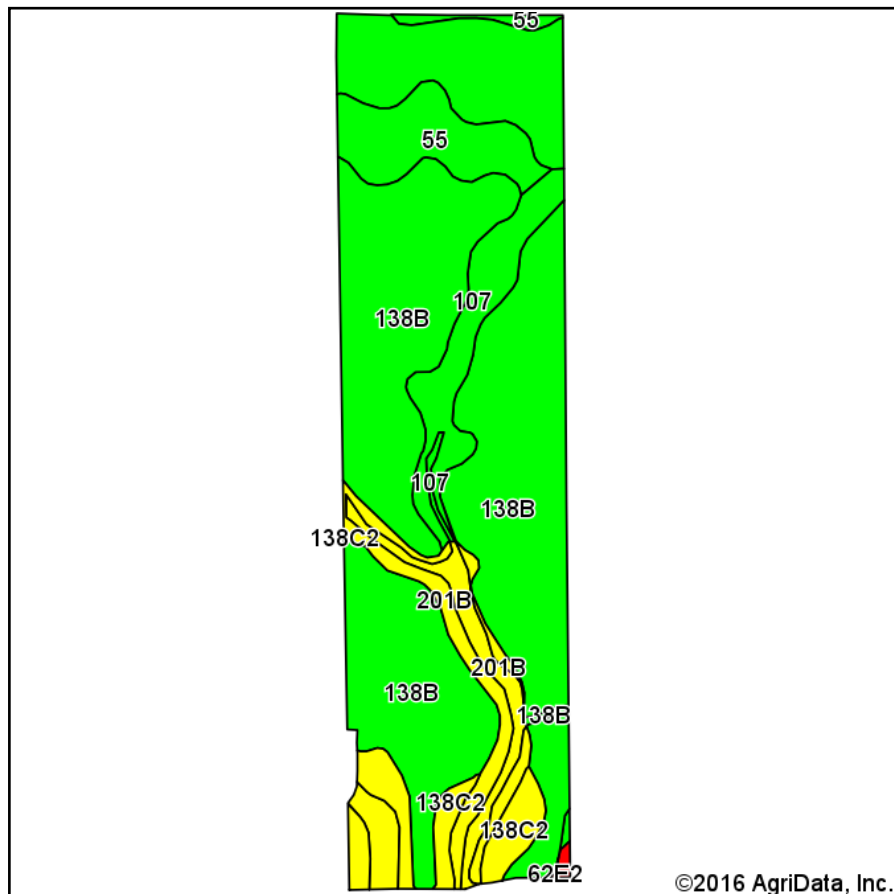

Soils data provided by USDA and NRCS.

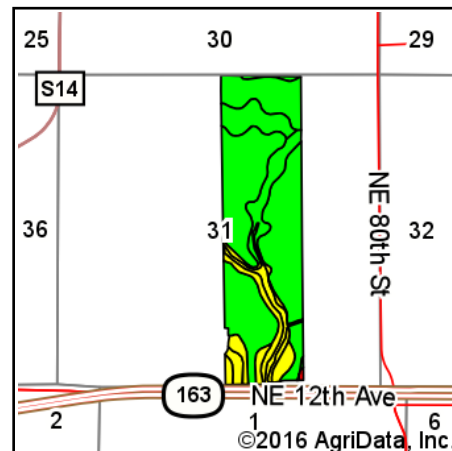

State: **Iowa**
 County: **Polk**
 Location: **31-79N-22W**
 Township: **Clay**
 Acres: **157.66**
 Date: **5/8/2016**



Archived Soils Ending 1/21/2012

Code	Soil Description	Acres	Percent of field	CSR Legend	Non-Irr Class *c	CSR*	Bromegrass alfalfa	Bromegrass alfalfa hay	Corn	Kentucky bluegrass	Oat s	Smooth bromegrass	Soybeans
138B	Clarion loam, 2 to 5 percent slopes	109.50	69.5%		Ile	86	7.7	6.4	203	3.7	81	6.2	55
201B	Coland, occasionally flooded-Terril complex, 2 to 5 percent slopes	16.01	10.2%		Ilw	66	7.3	4	176	3.3	70	5.8	48
55	Nicollet loam, 1 to 3 percent slopes	11.94	7.6%		Iw	94	8.3	6.5	214	4	86	6.6	58
107	Webster silty clay loam, 0 to 2 percent slopes	11.22	7.1%		Ilw	89	7.8	4.7	207	3.8	83	6.2	56
138C2	Clarion loam, 5 to 9 percent slopes, moderately eroded	8.66	5.5%		Ille	68	7.3	6	179	3.5	72	5.8	48
62E2	Storden loam, 14 to 18 percent slopes, moderately eroded	0.33	0.2%		Ive	33	5.1	4.1	132	2.4	53	4.1	36
Weighted Average						83.7	7.7	6	199.9	3.7	79.9	6.2	54.2

*The CSR ratings are dated 1/21/2012 and will be available to aid in the transition to CSR2.

*c: Using Capabilities Class Dominant Condition Aggregation Method

Soils data provided by USDA and NRCS.