

Soils Map

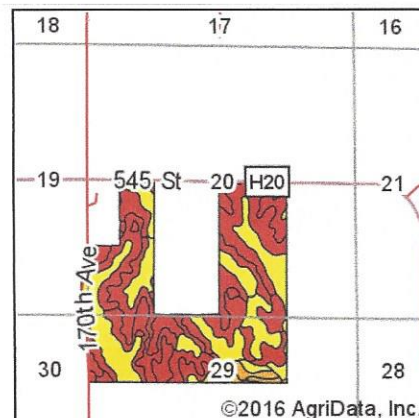

State: **Iowa**
 County: **Lucas**
 Location: **20-73N-22W**
 Township: **Liberty**
 Acres: **260**
 Date: **3/30/2016**

Maps Provided By:

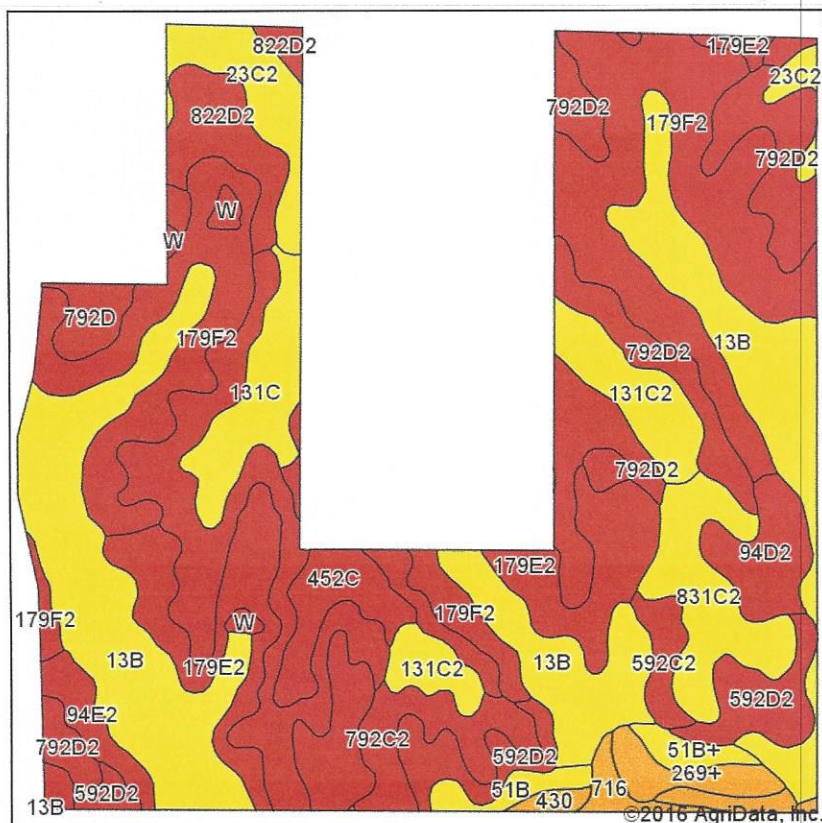

surety
 CUSTOMIZED ONLINE MAPPING

© AgriData, Inc. 2016

www.AgriDataInc.com









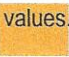

Soils data provided by USDA and NRCS.

©2016 AgriData, Inc.

Area Symbol: IA117, Soil Area Version: 23

Code	Soil Description	Acres	Percent of field	CSR2 Legend	Non-Irr Class *c	CSR2**	CSR
13B	Zook-Olmitz-Vesser complex, 0 to 5 percent slopes	51.64	19.9%		IIw	70	53
179F2	Gara clay loam, 18 to 25 percent slopes, moderately eroded	46.12	17.7%		VIIe	17	13
792D2	Armstrong clay loam, 9 to 14 percent slopes, moderately eroded	43.94	16.9%		IVe	5	13
179E2	Gara clay loam, 14 to 18 percent slopes, moderately eroded	24.54	9.4%		VIe	23	33
592D2	Mystic clay loam, 9 to 14 percent slopes, moderately eroded	10.31	4.0%		IVe	24	5
831C2	Pershing silty clay loam, terrace, 5 to 9 percent slopes, moderately eroded	10.19	3.9%		IIIe	64	45
131C2	Pershing silty clay loam, 5 to 9 percent slopes, moderately eroded	9.48	3.6%		IIIe	62	45
23C2	Arispe silty clay loam, 5 to 9 percent slopes, moderately eroded	7.78	3.0%		IIIe	62	50
131C	Pershing silt loam, 5 to 9 percent slopes	7.74	3.0%		IIIe	65	49
822D2	Lamoni silty clay loam, 9 to 14 percent slopes, moderately eroded	7.64	2.9%		IVe	29	15
792C2	Armstrong clay loam, 5 to 9 percent slopes, moderately eroded	6.29	2.4%		IIIe	24	27
452C	Lineville silt loam, 5 to 9 percent slopes	5.76	2.2%		IIIe	48	36
94D2	Mystic-Caleb complex, 9 to 14 percent slopes, moderately eroded	5.70	2.2%		IVe	29	16
94E2	Mystic-caleb complex, 14 to 18 percent slopes, moderately eroded	3.88	1.5%		VIe	17	12
**IA has updated the CSR values for each county to CSR2.							

2695	Hyndman silt loam, 0 to 2 percent slopes, based on the current soils data, use previous data version 2 for csc values.	3.20	1.2%		IIIw	72	63
792D	Armstrong loam, 9 to 14 percent slopes	3.20	1.2%		IVe	9	18
592C2	Mystic clay loam, 5 to 9 percent slopes, moderately eroded	2.58	1.0%		IIIe	23	20
W	Water	2.14	0.8%			0	0
430	Ackmore silt loam, 0 to 2 percent slopes	2.12	0.8%		IIw	77	83
51B	Vesser silt loam, 2 to 5 percent slopes	2.09	0.8%		IIw	70	66
716	Lawson-Quiver-Nodaway complex, 0 to 2 percent slopes, occasionally flooded	1.81	0.7%		IIw	78	
51B+	Vesser silt loam, 2 to 5 percent slopes, overwash	1.80	0.7%		IIw	69	65
Weighted Average						36.3	*-