

# Soils Map

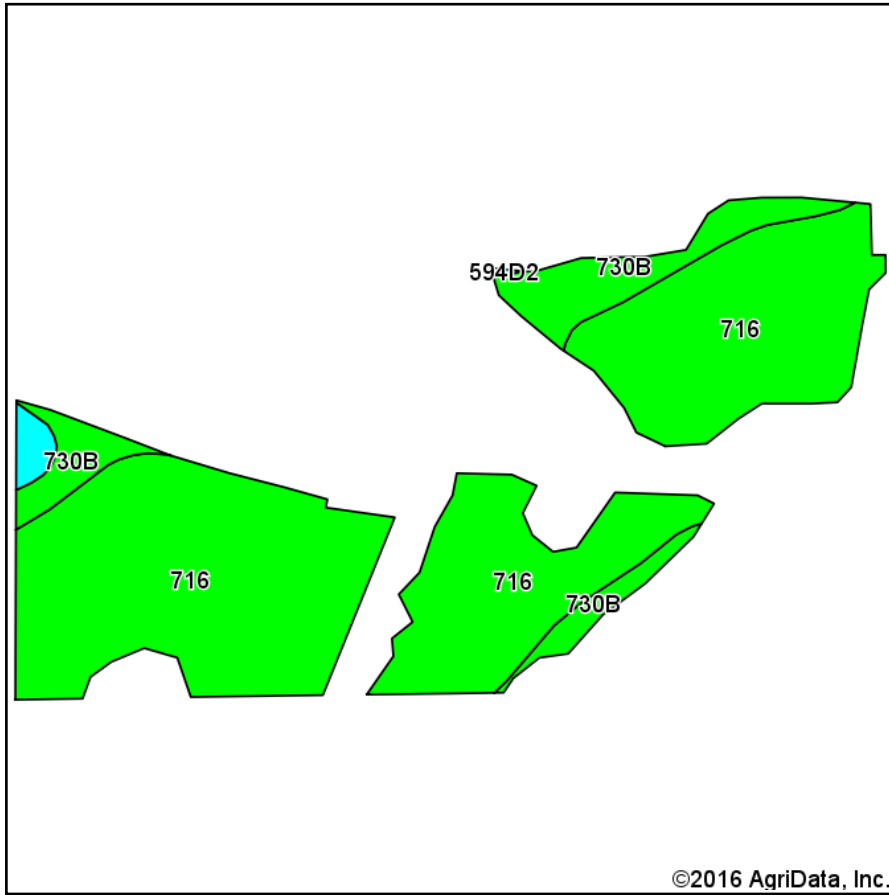

Soils data provided by USDA and NRCS.

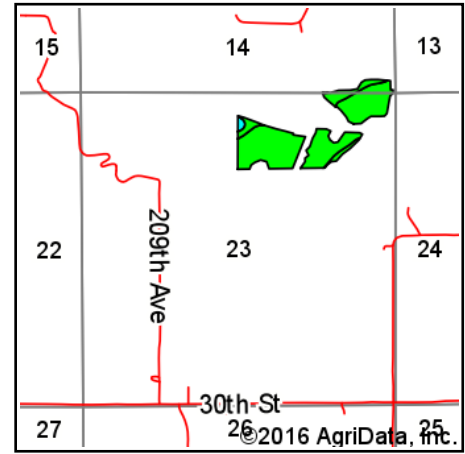

State: **Iowa**  
 County: **Wapello**  
 Location: **23-71N-15W**  
 Township: **Adams**  
 Acres: **37.53**  
 Date: **3/17/2016**

**Hawkeye Farm Mgmt & Real Estate**

**United Country Real Estate**  
 22 N Main, Albion IA Phone: 641-932-7796  
 Email: hawkeye@ucioa.com  
 On the web: www.ucioa.com  
 www.iowawhitetailfarms.com

Maps Provided By:

**surety**  
 CUSTOMIZED ONLINE MAPPING  
 © AgriData, Inc. 2016 www.AgrIDataInc.com



Area Symbol: IA179, Soil Area Version: 23

Code	Soil Description	Acres	Percent of field	CSR2 Legend	Non-Irr Class *c	CSR2**	CSR
716	Lawson-Quiver-Nodaway complex, 0 to 2 percent slopes, occasionally flooded	32.01	85.3%		IIw	78	
730B	Nodaway-Cantril complex, 2 to 5 percent slopes	4.98	13.3%		IIIw	76	63
594D2	Galland loam, 9 to 14 percent slopes, moderately eroded	0.54	1.4%		IVe	13	5
Weighted Average						76.8	*-

Area Symbol: IA179, Soil Area Version: 23

\*\*IA has updated the CSR values for each county to CSR2.

\*- CSR weighted average cannot be calculated on the current soils data, use prior data version for csr values.

\*c: Using Capabilities Class Dominant Condition Aggregation Method

Soils data provided by USDA and NRCS.