

Soils Map-CSR2

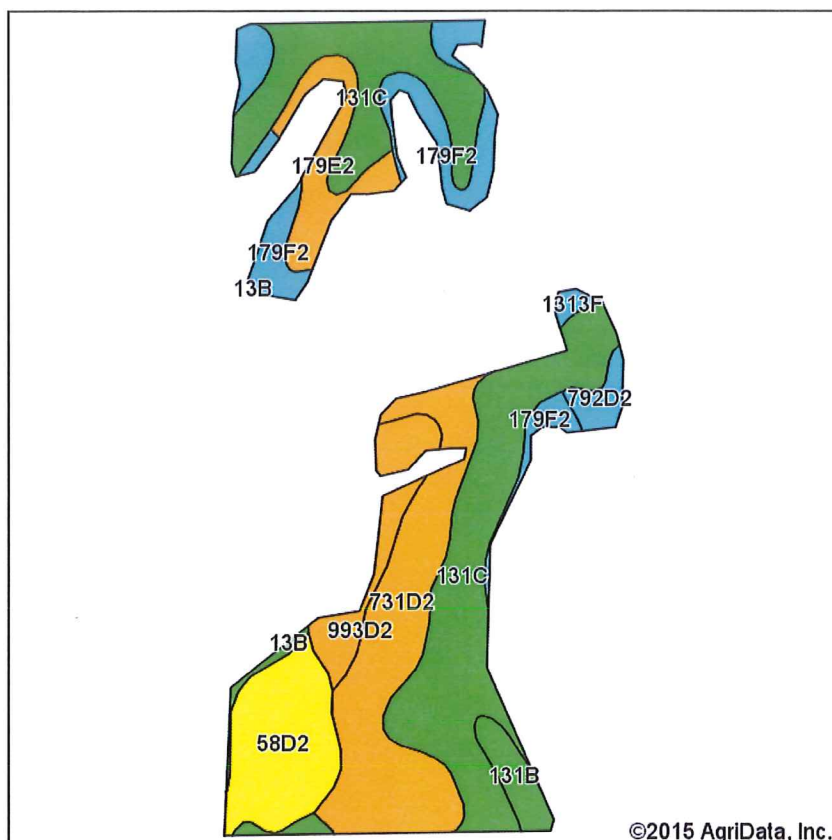

Soils data provided by USDA and NRCS.

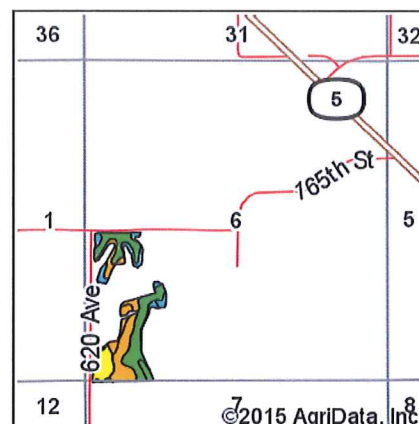

State: **Iowa**
 County: **Monroe**
 Location: **6-72N-17W**
 Township: **Troy**
 Acres: **32.57**
 Date: **10/28/2015**

Hawkeye Farm Mgmt & Real Estate

22 N Main, Albia IA Phone: 641-932-7796
 Email: hawkeye@iowafarms.com
 On the web: www.iowafarms.com

Maps Provided By:

surety
 CUSTOMIZED ONLINE MAPPING
 © AgriData, Inc. 2015 www.AgridataInc.com



Area Symbol: IA135, Soil Area Version: 22

Code	Soil Description	Acres	Percent of field	CSR2 Legend	Non-Irr Class *c	CSR2**	CSR
131C	Pershing silt loam, 5 to 9 percent slopes	12.20	37.5%		IIIe	65	49
731D2	Pershing silty clay loam, 9 to 14 percent slopes, moderately eroded	6.99	21.5%		IVe	35	31
58D2	Douds loam, 9 to 14 percent slopes, moderately eroded	3.88	11.9%		IVe	45	28
179F2	Gara loam, 18 to 24 percent slopes, moderately eroded	3.62	11.1%		VIe	12	13
179E2	Gara loam, 14 to 18 percent slopes, moderately eroded	1.95	6.0%		VIe	35	33
993D2	Gara-Armstrong loams, 9 to 14 percent slopes, moderately eroded	1.79	5.5%		IVe	35	20
131B	Pershing silt loam, 2 to 5 percent slopes	0.90	2.8%		IIIe	70	67
792D2	Armstrong loam, 9 to 14 percent slopes, moderately eroded	0.59	1.8%		IVe	5	13
13B	Olmitz-Colo-Vesser complex, 2 to 5 percent slopes	0.44	1.4%		IIw	82	60
1313F	Munterville silt loam, 18 to 25 percent slopes	0.21	0.6%		VIIe	6	5
Weighted Average						45.7	35.8

Area Symbol: IA135, Soil Area Version: 22

**IA has updated the CSR values for each county to CSR2.

*c: Using Capabilities Class Dominant Condition Aggregation Method

Soils data provided by USDA and NRCS.