

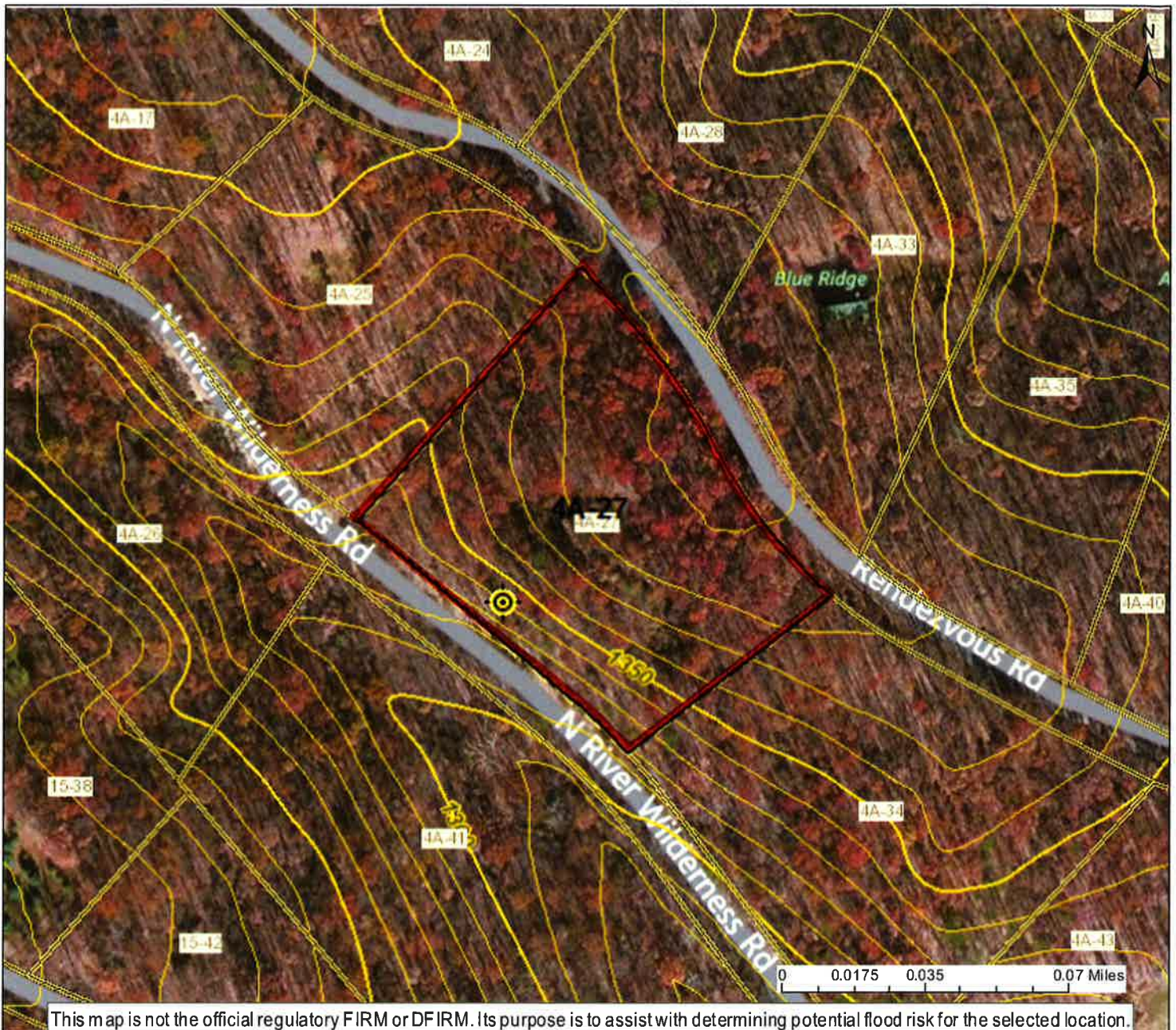

WV Flood Map



User Notes:

-  Flood Hazard Zone
-  Flood Point of Interest

Disclaimer:

The online map is for use in administering the National Flood Insurance Program. It does not necessarily identify all areas subject to flooding, particularly from local drainage sources of small size. To obtain more detailed information in areas where Base Flood Elevations have been determined, users are encouraged to consult the latest Flood Profile data contained in the official flood insurance study. These studies are available online at www.msc.fema.gov.
WV Flood Tool (<http://www.MapWV.gov/flood>) is supported by FEMA, WV NFIP Office, and WV GIS Technical Center.

Map created on October 21, 2015

Flood Hazard Area:

Flood Hazard Area: Location is NOT WITHIN any identified flood hazard area. Unmapped flood hazard

FEMA Issued Flood Map: 54027C0420C

Watershed (HUC8): Cacapon-Town (2070003)

Elevation: About 1337 ft

Location (long, lat): (78.645570 W, 39.182414 N)

Location (UTM 17N): (703362, 4339659)

Contacts: Hampshire

CRS Information: Hampshire County

Parcel Number: 4A-27

