



Bear Creek Plantation LLC

Webster County, Georgia

132.048 Surveyed Acres

Legend

Lines

TractNum, Descrip

- 1008, Creek
- 1008, Creek Named
- 1008, Road Woods
- 1008, Road Co Paved
- 1008, Road Co Graded
- Structures

TractName

- Bear Creek Plantation

Stands

TractNum, StrataNum, Descrip

- 1008, 1, 2009 Planted Loblolly
- 1008, 2, 2012 Old Field Planted Slash
- 1008, 3, 1950 Natural

NonTimber

TractNum, Descrip

- 1008, Yard
- 1008, Lake
- 1008, Open

Tract#	Strata#	Description	GIS Acres +/-	Percent Total Acres
1008	1	2009 Planted Loblolly	36.1	27%
1008	2	2012 OldField Planted Slash	18.6	14%
Planted Total:			54.7	42%
1008	3	1950 Natural	61.6	47%
Natural Total:			61.6	47%
1008	0	Open	8.1	6%
1008	0	Lake	6.4	5%
1008	0	Yard	0.9	1%
Non Timbered Total:			15.4	12%
Grand Total:			131.7	100%

Notes:

- *132.048 Surveyed Acres
- *0.9 Miles +- Bear Creek frontage
- *0.6 Miles +- Paved Road frontage (JL Black Rd)
- *1 House and 1 Barn
- *Permanent Conservation Easement (allows building additional house, farming, logging, hunting).

Key:

Strata# & +-Acres are labeled.
Acres include all area within type lines, including woods roads, small openings, etc. (unless otherwise noted).

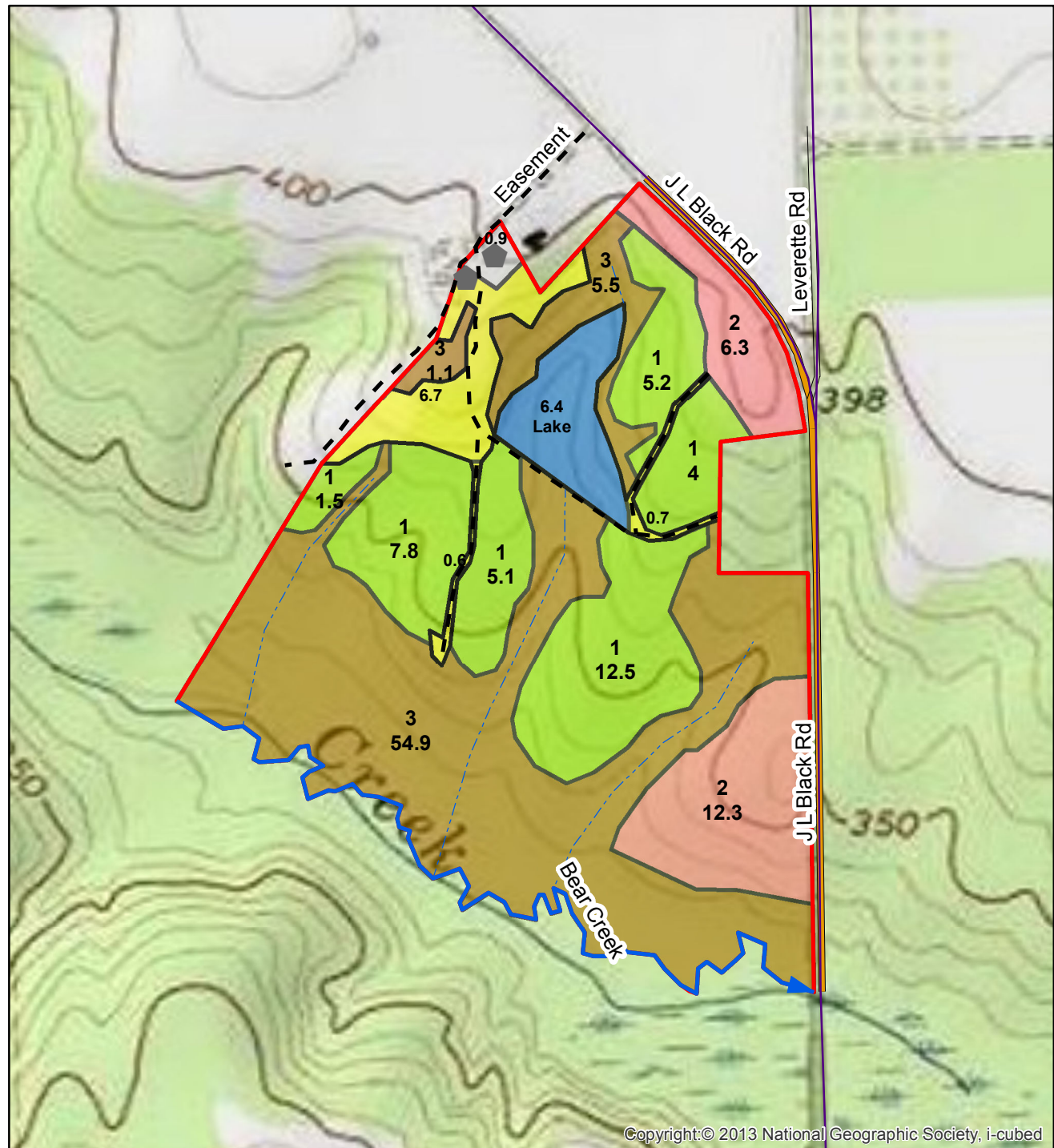

Copyright:© 2013 National Geographic Society, i-cubed

0 660 1,320 2,640 Feet

Mapped by Mike Matre in ArcGIS.
Last update on 8/12/2015
Map information is not guaranteed.



www.matreforestry.com
229-639-4973

1 in = 660 ft