



LA - Madison Whittington River

Lot  
0.48 Acres  
\$22000.0

22 m

Brown Realty Co

Tracey Weems

(318) 805-2964

[tweems@brownrealtyco.com](mailto:tweems@brownrealtyco.com)

<http://www.brownrealtyco.com/>

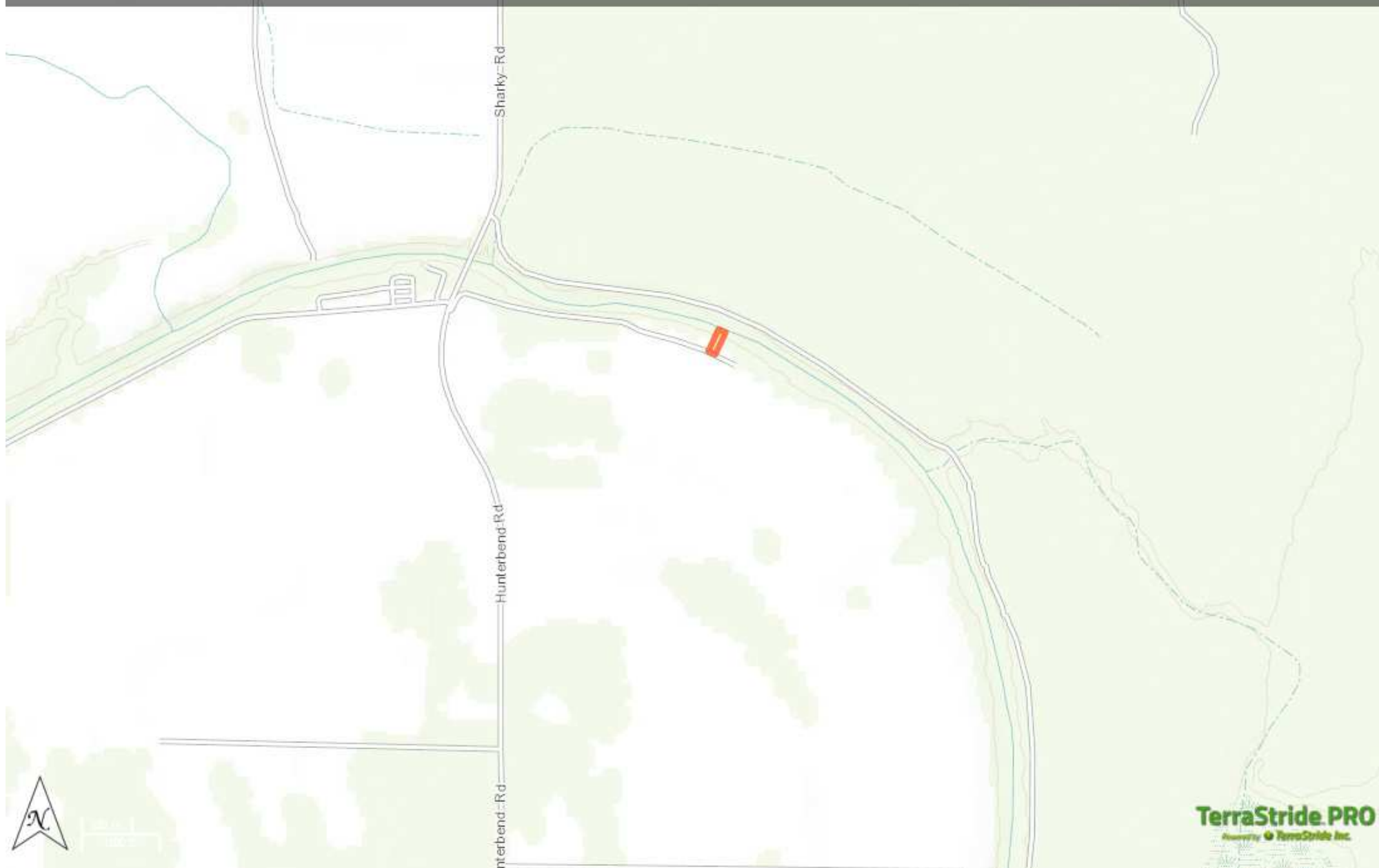

**TerraStride PRO**  
Powered by TerraStride Inc.

# Property Report—LA - Madison Whittington River Lot

## Legend

| Feature  | Icon | Colors  |
|----------|------|---|
| Boundary |      |  |

## Description

No more waterfront lots left on the Tensas River in the heart of the Tensas National Wildlife Refuge. This lot is on a dead end road with utilities, 2 culverts, and water meter installed. Enjoy all types of hunting, hiking or whatever your fancy is in the refuge or Big Lake WMA that is only minutes away. Come take a look!!! Brown Realty Company Jerry Brown, Broker 2189 Hwy 425 Rayville, LA 71269 318-728-9544

DISCLAIMER: The information contained herein is as obtained by this broker from sellers, owners, or other sources. This information is considered reliable, neither this broker nor owners make any guarantee, warranty or representation as to correctness of any data or descriptions and the accuracy of such statements. The correctness and / or accuracy of any and all statements should be determined through independent investigation made by the prospective purchaser. Any offer for sale is subject to prior sale, errors and omissions, change of price, terms or other conditions or withdrawal from sale

Generated on: Aug. 4, 2015