



**T1812**

1  
NC

139.64





# LOGAN COUNTY, OK SECTION 9, T-15-N, R-2-W

## EXHIBIT "A"

LINE LIST	
L1	S89°06'18"W 266.97
L2	S87°27'58"W 102.46
L3	S89°39'46"W 82.66
L4	S89°33'43"W 237.52
L5	S80°15'20"W 17.13
L6	S74°36'01"W 20.45
L7	S61°11'18"W 40.47
L8	N55°59'57"W 62.39
L9	N61°34'24"W 30.72
L10	N64°04'44"W 24.20
L11	N76°48'32"W 33.89
L12	S89°46'37"W 564.93

Being the centerline of a pipeline in the SW¼ of Section 9, T 15 N, R 2 W of the Indian Meridian Logan County, Oklahoma, situated in the property of Elizabeth M. O'Daniel and Henry I. Merry, Trustees of the Viola E. Merry Trust as described in that document recorded in Book 1316, Page 245, said centerline described as follows:

BEGINNING for the Point of Entry (N 285691.24, E 2141352.77) in the east boundary line of said Merry tract and also being the west right-of-way line of Highway 77, located S 89°03'02" W, 315.58 feet and N 00°23'52" W, 26.21 feet from a 1/2-inch iron rod found marking the south quarter corner of said Section 9;

THENCE seven (7) calls with said centerline as follows:

1. S 89°06'18" W, 266.97 feet to an angle point;
2. S 87°27'58" W, 102.46 feet to an angle point;
3. S 89°39'46" W, 82.66 feet to an angle point;
4. S 89°33'43" W, 237.52 feet to an angle point;
5. S 80°15'20" W, 17.13 feet to an angle point;
6. S 74°36'01" W, 20.45 feet to an angle point;
7. S 61°11'18" W, 40.47 feet to an intersection with the south boundary line of said Merry tract for a Point of Exit No. 1 (N 285652.40, E 2140591.24);

THENCE, S 89°03'02" W, 867.37 feet to an intersection with the south boundary line of said Merry tract for a Point of Re-Entry (N 285638.03, E 2139723.99);

THENCE five (5) calls with said centerline as follows:

1. N 55°59'57" W, 62.39 feet to an angle point;
2. N 61°34'24" W, 30.72 feet to an angle point;
3. N 64°04'44" W, 24.20 feet to an angle point;
4. N 76°48'32" W, 33.89 feet to an angle point;
5. S 89°46'37" W, 564.93 feet to an intersection with the west boundary line of said Merry tract for the Point of Exit No. 2 (N 285703.66, E 2139025.56), from which a 3/8-inch iron rod found marking the southwest corner of said Section 9, bears S 00°19'42" E, 77.19 feet.

Total centerline length of 1,483.79 feet or 89.93 rods.

NOTE: This description is the result of a survey made on the ground under my supervision and the subsequent mapping is the result of that survey together with record title information furnished by others and is not a boundary survey of the subject property. All coordinates, bearings and distances are referenced to the Oklahoma Coordinate system of 1983, North Zone, U.S. Survey Feet.

CA# 2558  
RENEWS 6/30/13

**DCP**  
DCP Southern Hills  
Pipeline, LLC  
50' PERMANENT PIPELINE  
EASEMENT (AS-BUILT)  
SITUATED IN THE  
ELIZABETH M. O'DANIEL AND HENRY I. MERRY,  
TRUSTEES OF THE VIOLA E. MERRY TRUST  
PROPERTY  
SECTION 9, T-15-N, R-2-W  
LOGAN COUNTY, OKLAHOMA

JOE: 12/12/05  
SCALE: 1"=600'  
DATE: 01/01/12  
CHECKED BY: NC  
DRAWING: OK-LO-0130.000

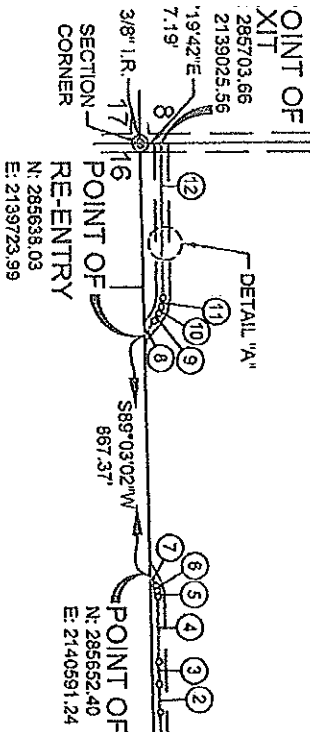

NO.	DATE	BY	REVISION DESCRIPTION	CHK.	APP.
2	6/27/13	LJ	ISSUED FOR ASBUILT	JKM	RSH
1	7/24/12	JSM	RE-ROUTE PER MOG# 111	JSM	RSH
0	1/27/12	JM	ISSUED FOR ACQUISITION	NC	RSH

R-S-H Engineering, Inc.  
Monroe, LA - Houston, TX  
15425 North Freeway, Suite 230  
Houston, Texas, 77050  
(832) 631-4239  
www.RSH.com

RODS: 89.93  
CENTERLINE FOOTAGE: 1483.79