

# Soils Map

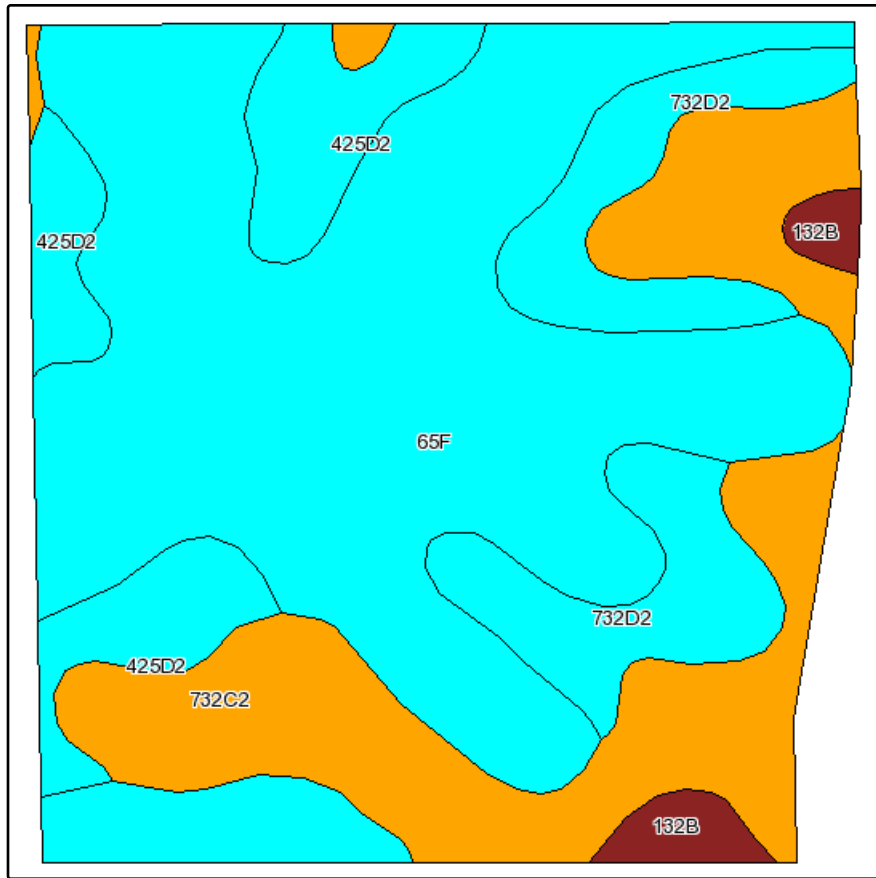

Fsa borders provided by the Farm Service Agency as of May 23, 2008.  
Soils data provided by USDA and NRCS.

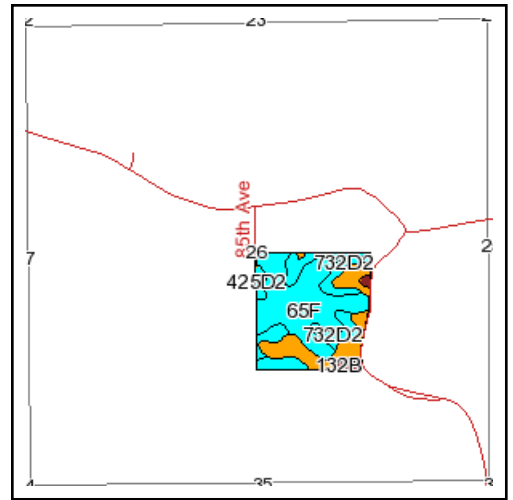

State: **Iowa**  
County: **Wapello**  
Location: **026-071N-013W**  
Township: **Keokuk**  
Acres: **38.9**  
Date: **12/29/2011**

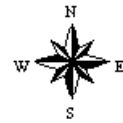

Maps provided by:



©AgriData, Inc 2008  
www.AgriDataInc.com

Code	Soil Description	Acres	Percent of field	CSR Legend	Non-Irr Class	CSR
65F	Lindley loam, 18 to 25 percent slopes	20.5	52.8%		VIIe	10
732C2	Weller silty clay loam, 5 to 9 percent slopes, moderately eroded	8.8	22.6%		IIIe	30
732D2	Weller silty clay loam, 9 to 14 percent slopes, moderately eroded	4.8	12.2%		IVe	15
425D2	Keswick loam, 9 to 14 percent slopes, moderately eroded	4	10.3%		IVe	5
132B	Weller silt loam, 2 to 5 percent slopes	0.8	2.1%		IIIe	55
<b>Weighted Average</b>						<b>15.6</b>