

**1182 670th Ave, Eddyville IA 52553**

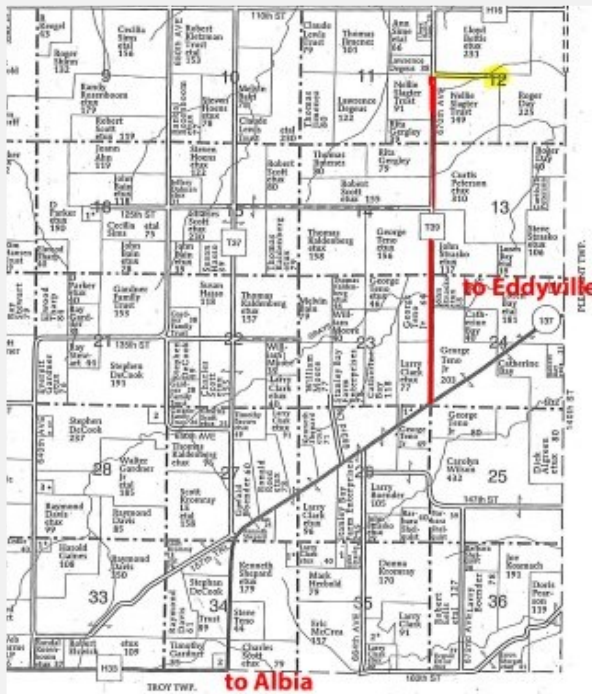

**Driving directions  
from Albia:** 5 mi NE  
on Hwy 137; turn  
north at 670th Ave,  
2½ mi to 1182, on  
east side of road,  
down lane.

**Driving directions  
from Eddyville:** 7 mi  
SW of Des Moines  
River bridge on Hwy  
137 to 670th Ave,  
turn north 2½ miles to  
1182 on east side of  
road, down lane.



**1182 670th Ave, Eddyville IA 52553**

**\$152,500**

Secluded 1880's Farmhouse nestled on 6.88 acres  
in Monroe Co. Iowa.

Property includes attached 1000+ sq. ft. garage, a  
42x54 Morton building and a large maintenance  
building and a beautiful pond in a park like setting.



**Hawkeye Farm  
Mgmt & Real Estate**



Ryan-641.777.2955  
ryan@uciowa.com



Alan-641.777.6927  
alan@uciowa.com

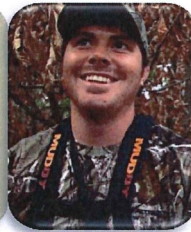

Nate-641.777.2861  
nate@uciowa.com

**THE "AMMONS" FAMILY**



## Secluded 1880's Farmhouse on 6.88 acres



This is a must see! Home has been fully remodeled and has many updates. Over 1000 sq. ft. attached garage with concrete floors, walls have drywall and ½ of ceiling area.

- \*Square Feet: Main 780 sf; 2nd 400 sf; Bsmt 780 sf. unfinished)
- \*3 BD; 3/4 BA.
- \*Remodel/Updated 2014/2015.
- \*Zoned Rural Residential
- \*Taxes: \$1082 (2014/15)



## 1182 670th Ave, Eddyville IA 52553



42 x 54 Morton Building with open side.

Maintenance Building with work bench & room for several vehicles.



In 2012 the home was updated with new roof, gutters, and fascia.

Property has a large pond with modest timber below. Don't miss out on this opportunity!



## Secluded 1880's Farmhouse on 6.88 acres



Upstairs you will find 3 bedrooms, all with closets...one has laminate flooring, and the other two are newly carpeted and have new vinyl windows. The interior and exterior walls and attic are fully insulated, and have 5/8" drywall with double knock-down spray texture throughout the home.



Beautiful trim work and crown moldings above doors promote the period charm.

Heating-LP Gas  
Forced Air  
Cooling- Window Air  
Water Heater- Electric,  
installed 2009



## 1182 670th Ave, Eddyville IA 52553



The main floor laundry room features two Pella Entry Doors with stained Glass, Designer Casement Pella Windows, new sink, cabinet, and oak bar area for folding clothes or serving food when barbequing out back. Washer and Dryer stay.

\*Average Mid-American electric \$154/month

\*1000 gal LP tank, stays with property

\*Well water; rural water available at road; not run to property



The above information, although believed to be correct, is not warranted or guaranteed by the owner, listing firm or listing agent.



## Secluded 1880's Farmhouse on 6.88 acres



The country kitchen has dark cabinetry surrounding a Large Pella Awning window with Stained Glass Transom. The kitchen includes a stainless Kitchen-Aid dishwasher, LG Microwave oven above Frigidaire electric range, and a large pantry & closet. New 3/4 inch solid oak scraped hardwood flooring throughout the kitchen & dining area. Chandeliers are installed in the kitchen, dining area and living room.



## 1182 670th Ave, Eddyville IA 52553



The home has a large living room with French Doors that open to the porch. The main floor has beautiful Designer Pella DH Windows and Casement windows featuring removable blinds inside. A Large triple window in living room brings plenty of southern light into the home and for enjoying the view.

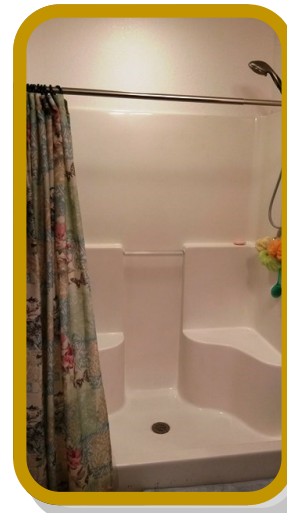

A new ¾ bath is conveniently located at the back of the home.