

# Soil Map

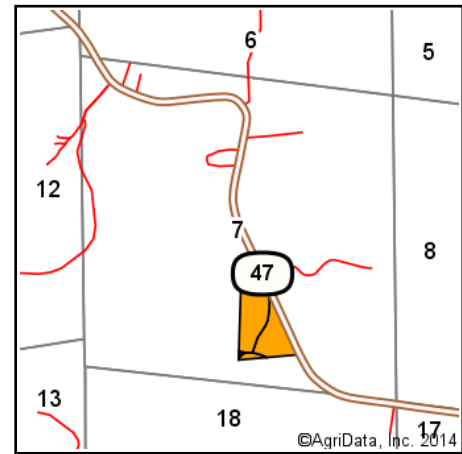

State: **Missouri**  
 County: **St Francois**  
 Location: **7-37N-4E**  
 Township: **Perry**  
 Acres: **23**  
 Date: **9/18/2014**

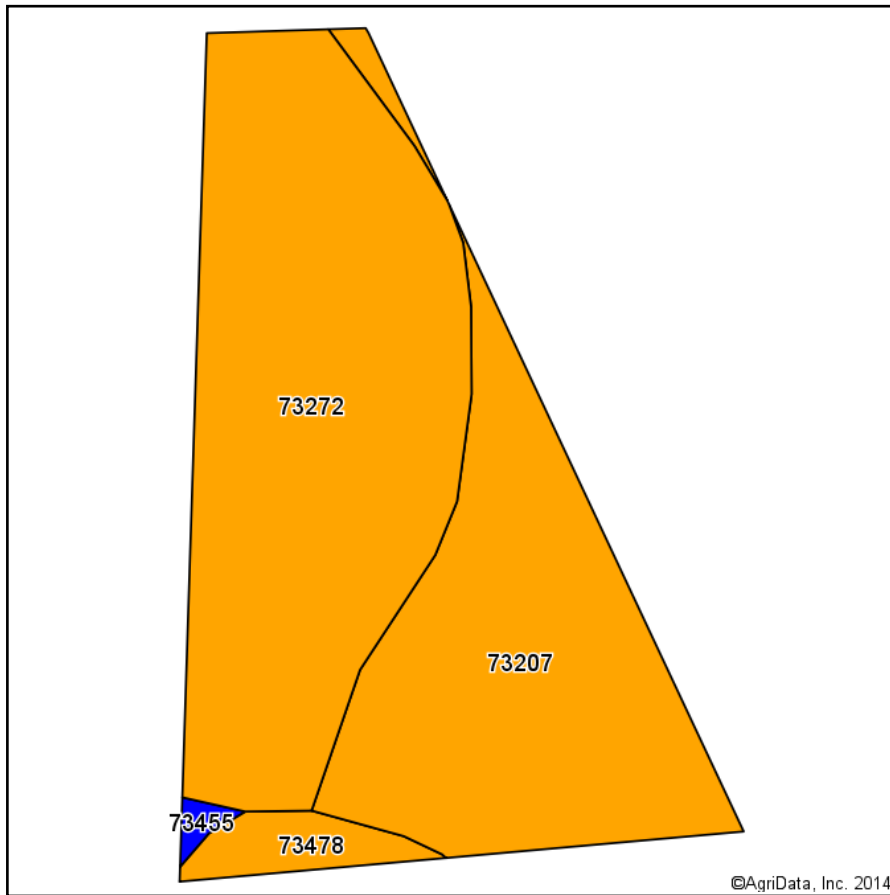

Trophy Properties  
and Auction

Maps Provided By:

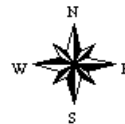

## Area Symbol: MO187, Soil Area Version: 12

Code	Soil Description	Acres	Percent of field	Non-Irr Class Legend	Soil Drainage	Non-Irr Class	NCCPI Overall	NCCPI Corn	NCCPI Small Grains
73272	Hildebrecht silt loam, 3 to 8 percent slopes	12.98	56.4%		Moderately well drained	IIIw	46	43	45
73207	Caneyville silt loam, 3 to 8 percent slopes	9.01	39.2%		Well drained	III <sub>s</sub>	52	49	52
73478	Nicholson silt loam, 3 to 8 percent slopes	0.87	3.8%		Moderately well drained	III <sub>e</sub>	50	50	50
73455	Hildebrecht silt loam, 1 to 5 percent slopes	0.14	0.6%		Moderately well drained	IIE	49	44	48
<b>Weighted Average</b>							<b>48.5</b>	<b>45.6</b>	<b>47.9</b>

Area Symbol: MO187, Soil Area Version: 12

Field borders provided by Farm Service Agency as of 5/21/2008. Aerial photography provided by Aerial Photography Field Office.