

Soils Map-CSR2

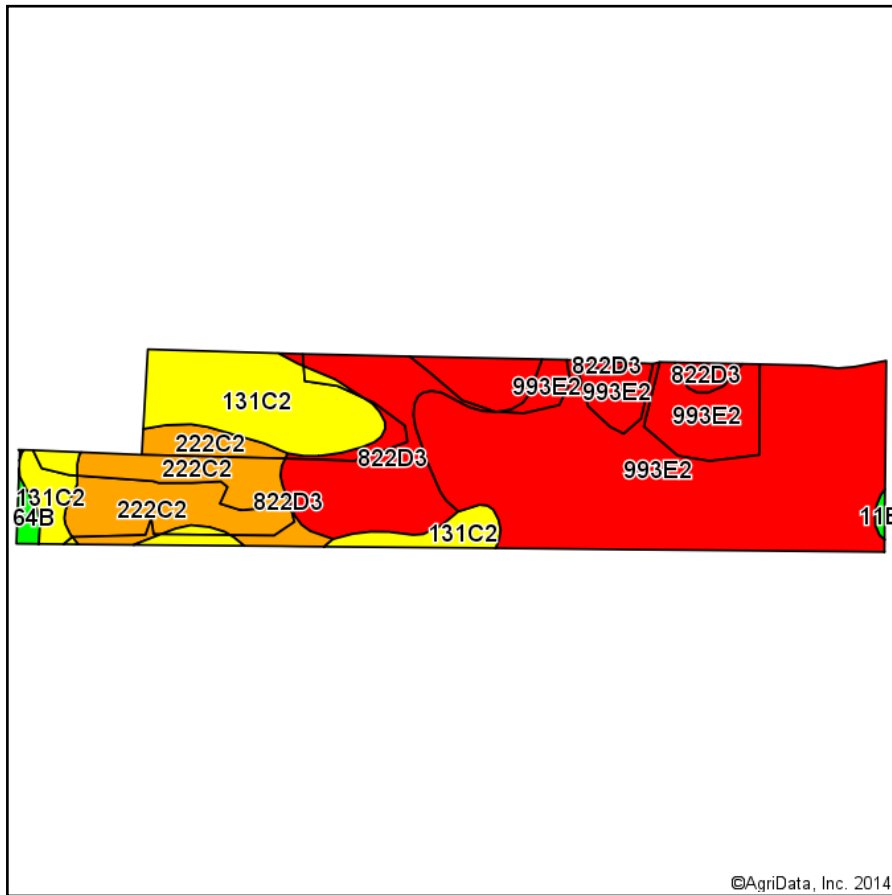

Soils data provided by USDA and NRCS.

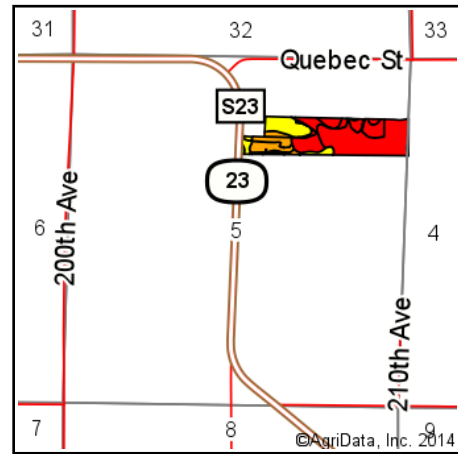

State: **Iowa**
 County: **Warren**
 Location: **5-74N-22W**
 Township: **White Breast**
 Acres: **32.53**
 Date: **8/14/2014**

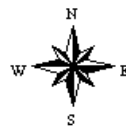

Area Symbol: IA181, Soil Area Version: 18

Code	Soil Description	Acres	Percent of field	**CSR2 Legend	Non-Irr Class	CSR2**	CSR
993E2	Armstrong-Gara loams, 14 to 18 percent slopes, moderately eroded	16.33	50.2%		Vle	17	5
131C2	Pershing silt loam, 5 to 9 percent slopes, moderately eroded	5.80	17.8%		Ille	59	50
822D3	Lamoni soils, 9 to 14 percent slopes, severely eroded	5.40	16.6%		Vle	5	5
222C2	Clarinda silty clay loam, 5 to 9 percent slopes, moderately eroded	4.69	14.4%		IVw	43	25
864B	Grundy silty clay loam, 2 to 5 percent slopes	0.24	0.7%		Ile	75	82
11B	Colo-Ely silty clay loams, 2 to 5 percent slopes	0.07	0.2%		Ile	83	65
Weighted Average						26.8	16.6

Area Symbol: IA181, Soil Area Version: 18

**IA has updated the CSR values for each county to CSR2.

Field borders provided by Farm Service Agency as of 5/21/2008. Aerial photography provided by Aerial Photography Field Office.