

Soils Map-CSR2

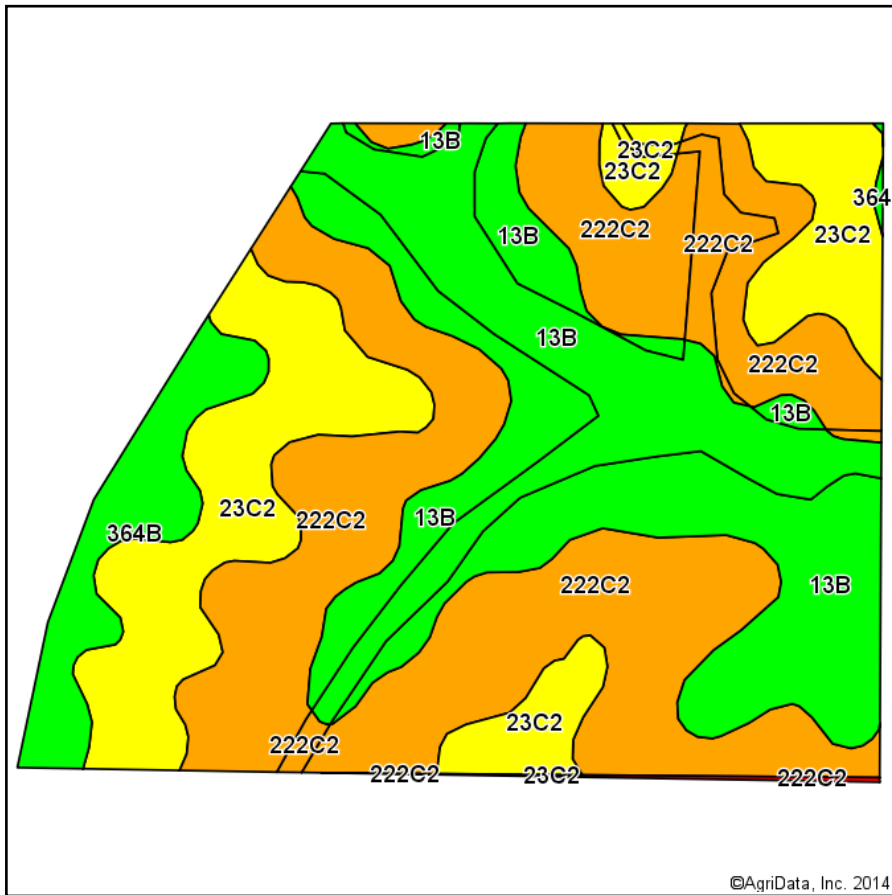

Soils data provided by USDA and NRCS.

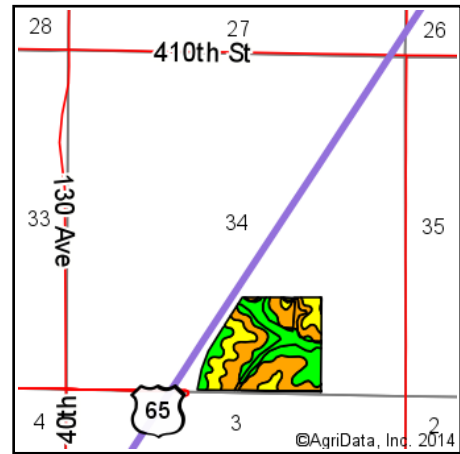

State: **Iowa**
 County: **Lucas**
 Location: **34-71N-23W**
 Township: **Union**
 Acres: **55.3**
 Date: **6/23/2014**

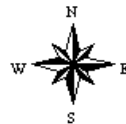

Area Symbol: IA117, Soil Area Version: 20

Area Symbol: IA185, Soil Area Version: 16

Code	Soil Description	Acres	Percent of field	**CSR2 Legend	Non-Irr Class	CSR2**	CSR	NCCPI Overall
222C2	Clarinda silty clay loam, 5 to 9 percent slopes, moderately eroded	22.03	39.8%		IVw	43	25	54
13B	Zook-Olmitz-Vesser complex, 0 to 5 percent slopes	18.20	32.9%		Ile	70	53	80
23C2	Arispe silty clay loam, 5 to 9 percent slopes, moderately eroded	11.59	21.0%		IIIe	60	50	56
364B	Grundy silty clay loam, 2 to 5 percent slopes	3.36	6.1%		Ile	75	75	68
222C2	Clarinda silty clay loam, 5 to 9 percent slopes, moderately eroded	0.12	0.2%		IVw	38		51
Weighted Average						57.4	*-	63.8

Area Symbol: IA117, Soil Area Version: 20

Area Symbol: IA185, Soil Area Version: 16

**IA has updated the CSR values for each county to CSR2.

*- CSR weighted average cannot be calculated on the current soils data, use prior data version for csr values.

Field borders provided by Farm Service Agency as of 5/21/2008. Aerial photography provided by Aerial Photography Field Office.