

WEST LINE SECTION 610
N00° 57' 59" E
198.5 FT.

Section 610

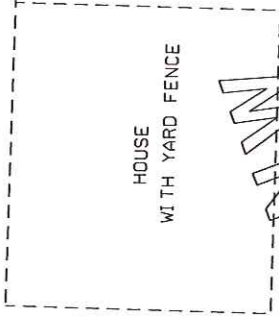

6.0 Acres.
Donald Mahaney
Vol. 488, Page 323

POB BEARS 2718.4 FT.
S00° 57' 59" W
FROM NW CORNER SECTION 610.

POB

1/2" IR Fnd

S88° 47' 00" E
660.0 FT.

EXISTING GRAVEL ROAD

N00° 57' 59" E
198.5 FT.

SELLER: VINCENT WYATT
BUYER: DONALD MAHANEY

3.008 ACRES.

S00° 57' 59" W
198.5 FT.

Block H

1/2" IR Set

660.0 FT.

N88° 47' 00" W

60 FT.

51.8'
62.2 FT.
N25° 10' E
ESSEMENT
1/2" IR Fnd

Clifton Smith
Vol. 244, Page 371

S88° 47' 00" E

60 FT.

Graveled Road.

Proposed Access Easement
along Road.

Childress Economic Development Corp.
Vol. 365, Page 159.

Boundary Survey:
3.008 Acres in West Part Section 610,
Block H, W&NW RR Survey.
Childress County, Texas.
Abstract. 1510

I, James G. Freeman, Registered Professional Land Surveyor in Texas,
RPLS 2149, Certify I have surveyed on the ground the tract here shown.

James G. Freeman

March 24, 2014

FREEMAN ENGINEERING
Childress, Texas.
PO Box 84 940-585-6038

Survey

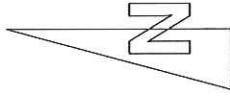

SCALE: 1 inch=120 ft.
Basis of Bearing: Texas State Plane,
North Zone, NAD 83.

94.0 Acres.
Vinny Wyatt
Vol. 496, Page 120.

Boundary Survey; 3.008 Acres out of a 94.0 Acres tract described at Volume 496, Page 120 of the official public records of Childress County, Texas, being in West Part Section 610, Block H, W&NW RR survey in Childress County, Texas.

With a description for an entrance easement for this 3.008 Acres tract.

BASIS of Bearing; Texas State Plane, North Zone, NAD 83.

Described as follows. BEGINNING at a ½ inch iron rod found in the West Line of said Section 610 which bears South 00 degrees. 57minutes. 59 seconds West, from a ½ inch iron rod found at the North West Corner of said Section 610. This Point of Beginning being also the South west Corner of a 6.00 acres tract described at Volume 488, Page 323.

THENCE, South 88 degrees, 47 minutes, 00 seconds East, with the south line of said 6.0 acres tract to a ½ inch iron rod found at the South East corner of said 6.00 acres tract, being the North East Corner of this tract at 660.0 feet.

THENCE, South 00 degrees, 57 minutes, 59 seconds West, to a 1/2inch iron rod set at 198.5 feet, the South East corner of this tract.

THENCE, North 88 degrees, 47 minutes, 00 seconds West, parallel and 60.0 feet north of the south line of said 94.0 acres tract, to a ½ inch iron rod set in the Fence at the West line of said Section 610 at 660.0 feet.

THENCE, North 00 degrees, 57 minutes, 59 minutes, East with a fence at the East line of said Section 610, to the POINT OF BEGINNING at 198.5 feet.

Description for ACCESS EASEMENT for the above tract. Being the west most 0.050 acres crossing a 60.0 feet wide strip along the south line of the 94.0 acres described at Volume 496, Page 120.

BEGINNING at a 1/2 inch iron pipe found at the South West Corner of said 94.0 acres tract, being in a gravel road.

THENCE, North 00 degrees 57 minutes 59 seconds East, with the West Line of said Section 610, pass a fence corner post at 43.0 feet, continuing same bearing to a ½ inch iron rod set in a fence at the North West Corner of said 60.0 feet strip. Being also the South West Corner of the 3.008 acres tract described above.

THENCE, South 88 degrees, 47 minutes, 00 seconds East, 51.8 feet to a point at the east side of a gravel road.

THENCE, South 28 degrees, 10 minutes West, with a fence to a fence corner post in the south fence of this tract, on the east side of a gravel road at 67.2 feet.

THENCE, North 88 degrees, 47 minutes, 00 seconds West, with the south line of said 94.0 acres tract to the POINT OF BEGINNING at 21.8 total feet.