

Soils Map

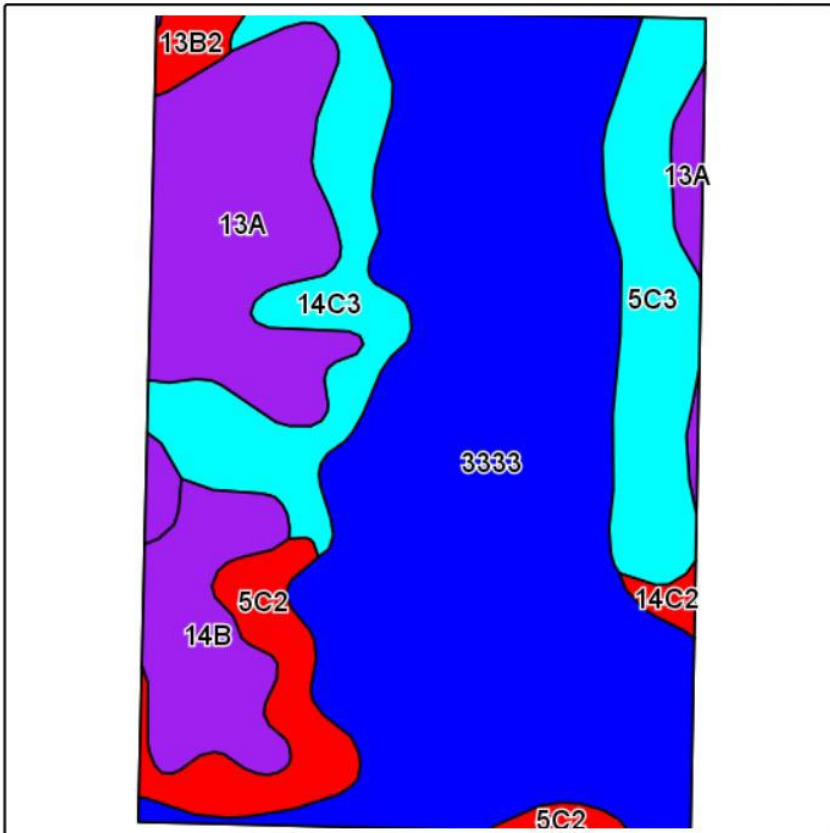

Field borders provided by Farm Service Agency as of 5/21/2008.
Soils data provided by University of Illinois at Champaign-Urbana.

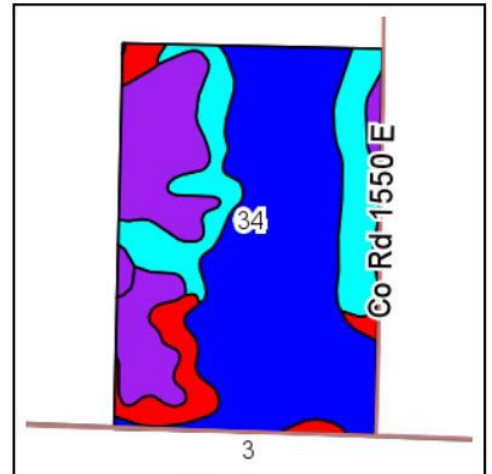

State: Illinois
County: Clay
Location: 34-3N-7E
Township: Stanford
Acres: 63.00
Date: 10/15/2013



Maps provided by:



Code	Soil Description	Acres	Percent of field	Il. State Productivity Index Legend	Corn Bu/A	Soybeans Bu/A	Wheat Bu/A	Crop productivity index for optimum management
3333	Wakeland silt loam, frequently flooded	32.36	51.4%		174	56	68	128
13A	Bluford silt loam, 0 to 2 percent slopes	9.45	15.0%		136	44	55	101
**14C3	Ava silty clay loam, 5 to 10 percent slopes, severely eroded	6.26	9.9%		**100	**33	**41	**74
**5C3	Blair silty clay loam, 5 to 10 percent slopes, severely eroded	5.86	9.3%		**102	**33	**41	**77
**14B	Ava silt loam, 2 to 5 percent slopes	4.28	6.8%		**134	**44	**54	**99
**5C2	Blair silt loam, 5 to 10 percent slopes, eroded	3.68	5.8%		**124	**41	**50	**94
**13B2	Bluford silt loam, 2 to 5 percent slopes, eroded	0.74	1.2%		**129	**42	**52	**96
**14C2	Ava silt loam, 5 to 10 percent slopes, eroded	0.37	0.6%		**122	**40	**50	**90
Weighted Average					147.8	47.8	58.6	109.3

Table: Optimum Crop Productivity Ratings for Illinois Soil by K.R. Olson and J.M. Lang, Office of Research, ACES, University of Illinois at Champaign-Urbana. Version: 1/2/2012 Amended Table S2 B811 (Updated 1/10/2012)
Crop yields and productivity indices for optimum management (B811) are maintained at the following NRES web site: <http://soilproductivity.nres.illinois.edu/>

** Indexes adjusted for slope and erosion according to Bulletin 811 Table S3

Topography Map

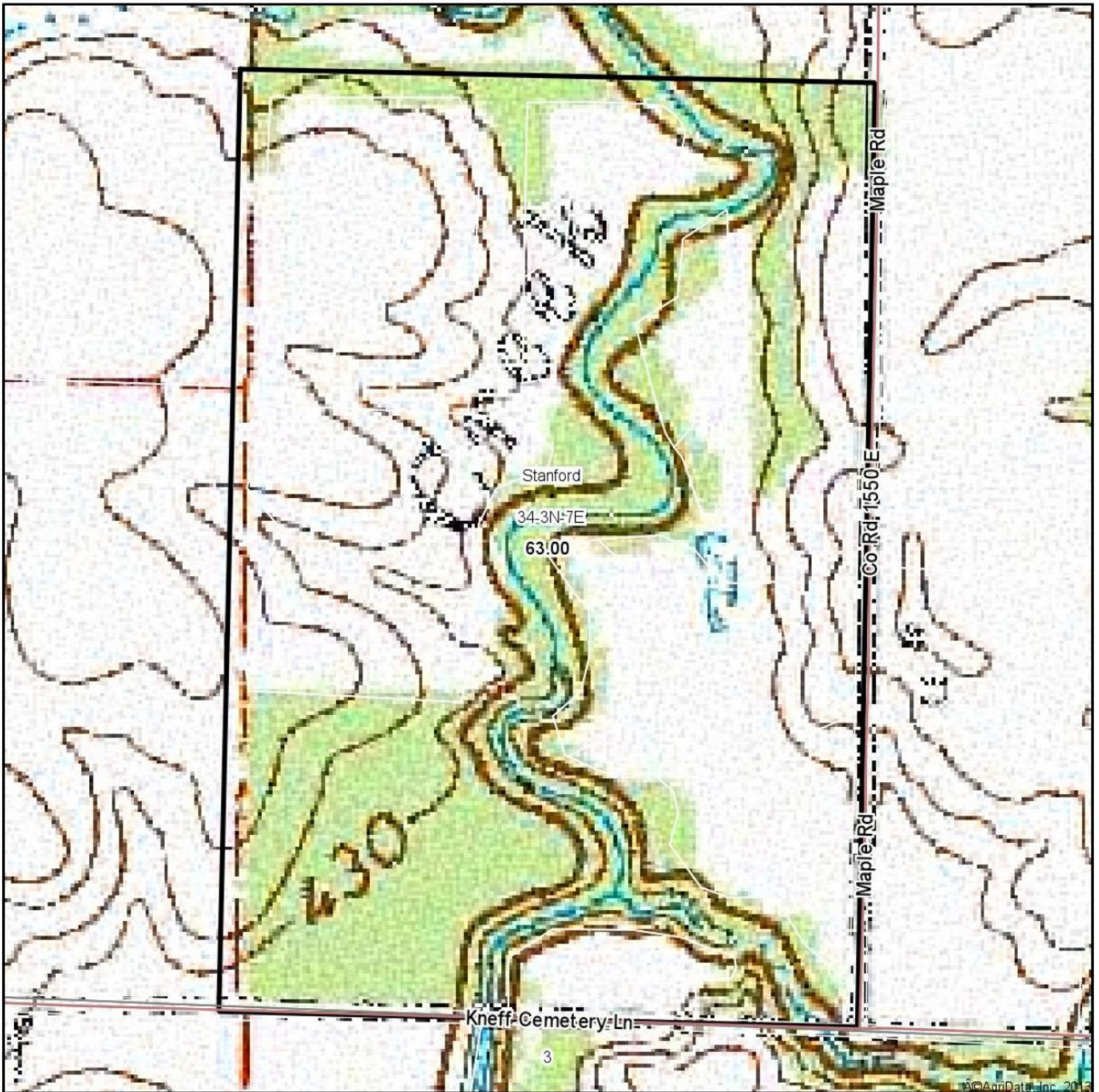

map center: 38° 39' 0.64, 88° 24' 45.46

scale: 4055

34-3N-7E
Clay County
Illinois



10/15/2013

Maps provided by:



©AgriData, Inc. 2012

www.AgriDataInc.com

Field borders provided by Farm Service Agency as of 5/21/2008. Aerial photography provided by Aerial Photography Field Office.