



KERR COUNTY
Environmental Health Department
Courthouse, 700 Main, Suite BA-106
Kerrville, Texas 78028
(830) 896-9020

PERMIT TO OPERATE

PERMIT: **O07-117** **2/22/2008**
PERMITTEE: **Melvin, Ronald "Gene", 104 Melvin Lane, Kerrville, TX 78028**
PROPERTY: **R29080, 116 Melvin Drive, Kerrville**
Subdivision: **Hill Country Ranch Estates**
Section: **3**
Block:
Lot: **2 (replat of 8)**
Acres: **0.66**
Survey:
Abstract:
Other:

TYPE OF FACILITY: **Aerobic - Aqua Klear AK500** **Aerobic Treatment** **Surface Application Disposal**
TRANSACTION: **New**

SPECIAL CONDITIONS: Water Conservation Recommended. System designed for a 2-bedroom, Residential-Manufactured Home with <1500 sq. ft. of living area. Daily Flow = 180 GPD.

On 7/24/2007, Designated Representative, **Patricia S. Hulett, OS18771**, made the final physical inspection of this facility. Based upon the information provided by the applicant, the records of the Environmental Health Department, and the applicable Rules and Standards, the Permitting Authority finds that the facility is in substantial compliance with the State minimum requirements.

Any permit or other authorization issued under these Rules shall automatically terminate if not properly amended if:

- (1) there is a subdivision of the property served by the on-site sewage facility;
- (2) the property is used for a purpose other than that described in the original application;
- (3) the loading of the on-site facility is increased beyond that stated in the application;
- (4) the facility fails; or
- (5) for secondary treatment, such as aerobic units, which may require a maintenance contract per effects of House Bill 2482 passed by legislation September 1, 2007.

It will be the responsibility of the Permittee to maintain and operate the facility in a satisfactory manner. The proper performance of an on-site facility cannot be guaranteed, even though all provisions of State Standards, and County Rules and Standards have been met. Inspection and permitting of an on-site sewage facility by the Permitting Authority shall indicate that the facility meets minimum requirements and does not relieve the Owner of the property from complying with the County, State, and Federal Regulations. On-site sewage facilities, although approved and meeting minimum standards, must be up-graded or connected to a sewer line by the Permittee at the Permittee's expense, if the Permittee operation of the facility results in objectionable odors, if unsanitary conditions are created, if pollution or nuisance conditions are threatened or occur, or if the facility when used does not comply with government regulations.

THIS PERMIT IS NOT A GUARANTEE OR WARRANTY THAT THE FACILITY WILL, IN FACT, OPERATE OR FUNCTION PROPERLY FOR ANY PARTICULAR LENGTH OF TIME. LATENT DEFECTS MAY EXIST WHICH WOULD RENDER THE SYSTEM IN VIOLATION OF THE RULES AND/OR STANDARDS. FOR A MORE DETAILED EVALUATION, YOU ARE ENCOURAGED TO CONTACT AN EXPERIENCED REGISTERED PROFESSIONAL ENGINEER, REGISTERED PROFESSIONAL SANITARIAN, OR OTHER PERSON CERTIFIED BY THE TEXAS COMMISSION ON ENVIRONMENTAL QUALITY.

Patricia S. Hulett, Designated Representative, OS18771
Kerr County OSSF Program

Owner: Ronald "Gene" Melvin FEB 22 2008
 Location: 116 Melvin Drive
 Hill Country Ranch Estates
 Kerrville, TX 78028

KCEHD

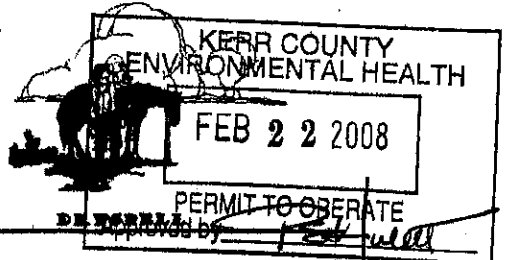

RECEIVED
 007-117

Melvin Drive

10' Setback

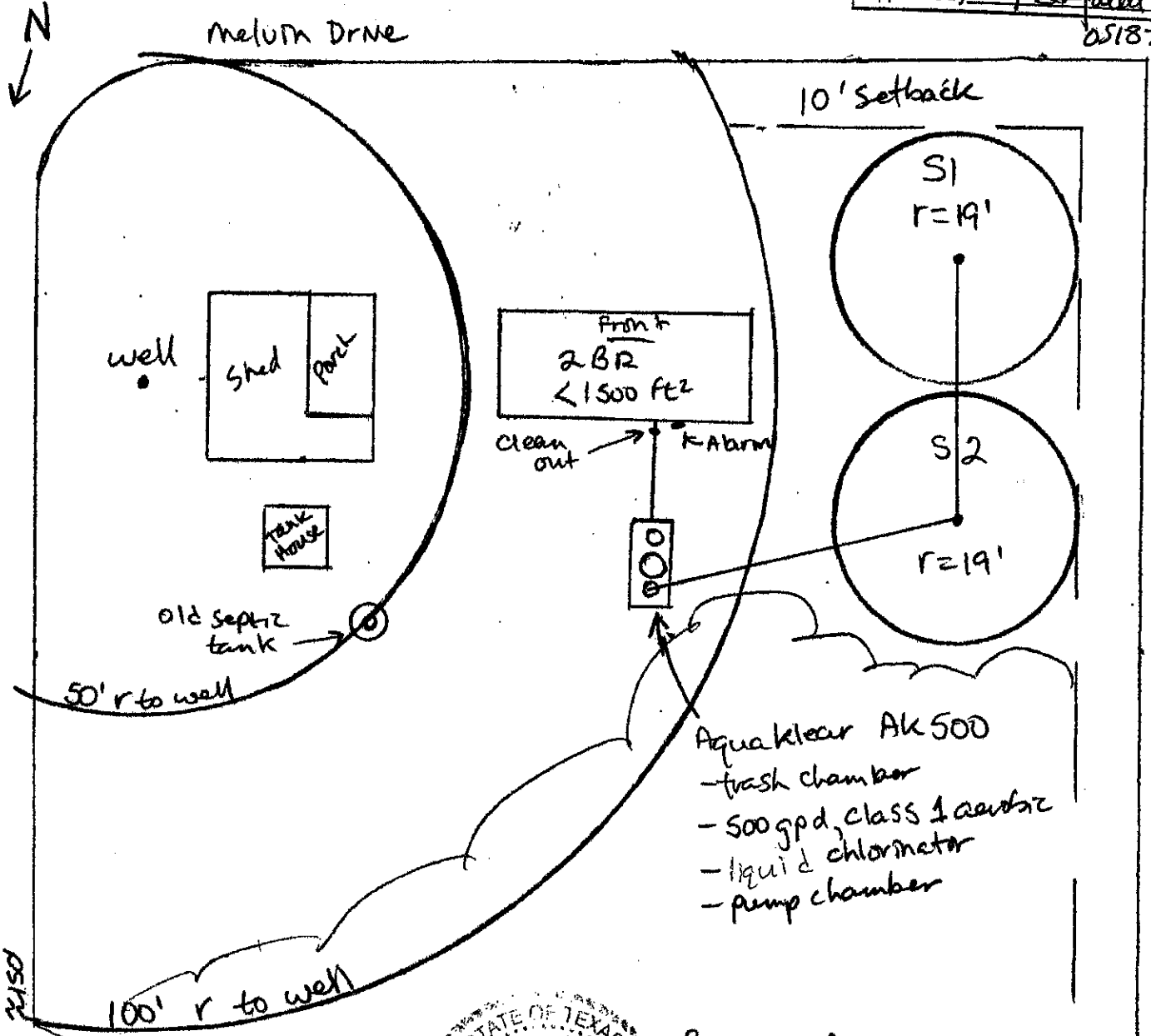

- Aquaklear AK 500
- trash chamber
 - 500 gpd, class 1 aerator
 - liquid chlorinator
 - pump chamber

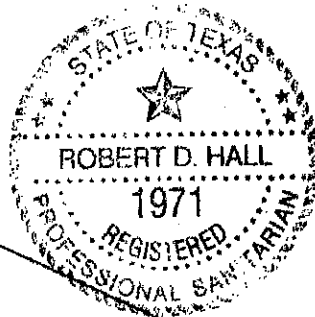

Brushy Area

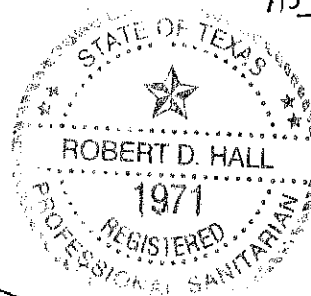

This is not a survey

KERR COUNTY
Environmental Health Department
Courthouse, 700 Main, Suite BA-106
Kerrville, Texas 78028
(830)896-9020

COPY

AUTHORIZATION TO CONSTRUCT AN ON-SITE SEWAGE FACILITY

APPROVAL IS HEREBY GRANTED FOR THE CONSTRUCTION AND INSTALLATION OF THE SITE-SPECIFIC ON-SITE SEWAGE FACILITY (OSSF) AS DESIGNED.
INSTALLER MUST ABIDE BY CURRENT TCEQ OSSF RULES CHAPTER 285, KERR COUNTY OSSF RULES, AND THE APPROVED SITE-SPECIFIC PLANS.

48 Hours Advance Notice Required for All Inspections

OSSF NO.:

007-117

DATE ISSUED:

7/20/2007

*TCEQ Regulation 285.3(d)(1) states "An authorization to construct is valid for one calendar year from the date of its issuance. If the installer does not request a construction inspection by the permitting authority within one year of the issuance of the authorization to construct, the authorization to construct expires and the owner will be required to submit a new application and application fees before an OSSF can be installed."

PROPERTY	116 Melvin Drive, Kerrville, TX	Kerrville, TX R29080	Hill Country Ranch Estates, Section 3, Lot 2(replat of 8) Acres 0.66
OWNER	Melvin, Ronald "Gene"		

SYSTEM INFORMATION

Waste Load

180 GPD

System Type

Aqua Klear AK500

Treatment

Aerobic

Disposal

Surface Application

CONSTRUCTION INFORMATION

Single Family Residence

☒

Commercial/Institution

☐

New Construction or Upgrade

☒

Extend or Repair

☐

CONDITIONS: As per Designs by & Lic. #: Robert Hall R.S. 1971

Additional Conditions:

1. Plans do not include separate gray water disposal system or mention of any water treatment equipment or appliances.
2. Existing septic tank to be abandoned properly and a copy of the Waste Hauling Manifest to be provided to the permitting authority.
3. Signed & sealed originals of the planning materials to be submitted to the permitting authority.
4. Any private water line/wastewater line crossings to meet requirements of Chapter 290; final scale drawing to be submitted to permitting authority showing water line locations.

0

0

INSTALLER & Lic. #:

Claud Jordan, Jr. OS18889

**ANY MODIFICATIONS TO SUBMITTED PLANS REQUIRE APPROVAL
BY THE KERR COUNTY D. R. PRIOR TO INSTALLATION**

Patricia S. Hulett

Patricia S. Hulett DR OS18771