

Market Realty, Inc.

(979)836-9600
(979)836-6689 Fax

2201 Becker
Brenham, Texas 77833
www.marketrealty.com

e-mail address
appraisals@marketrealty.com



8309 FM 2621
Brenham, TX
\$375,000

Spacious and well-kept brick home on 16.50 acres in the Sandy Hill community. Property has lovely rolling views of the countryside and a peaceful location. Home has three bedrooms, 3 bathrooms with front and back covered porches and large family/living room with brick fireplace and lots of built ins. Great floor plan with entry foyer, formal dining room, large kitchen and breakfast area. Home also has studio lighting, crown moulding, and ceiling fans throughout. Property has a detached metal shop that measures 24'x36' with 3 overhead doors, 2 passage doors and built in workbench. For more information call listing broker, Roger Chambers at 979-830-7708 or Susan Kiel at 979-251-4078/979-289-2159.

Directions: From Brenham take Hwy 105 towards Navasota. Turn left on FM 50. Turn right on FM 2621. Drive approximately 3 miles, property on the left. Shown by appointment only

“THE MARKET TEAM”

Listing Broker: Roger Chambers
Broker Associate/Assistant: Susan S. Kiel

The information contained herein, while obtained from sources deemed reliable, is not warranted by MARKET REALTY, INC.
Property is subject to prior sale, change, or withdrawal from market without notice.

48.32 Ac.



LINES ARE AN
APPROXIMATION OF
BOUNDARIES

SUBJECT
16.50 acres

Farm to Market Rd 2621

318 ft

© 2011 Google

© 2011 Europa Technologies

Google earth

SKETCH ADDENDUM

Borrower or Owner	Alice Petty Estate			
Property Address	8309 FM 2621			
City	Brenham	County	Washington	State TX
Zip Code	77833			
Client	Client: Alice Petty estate			

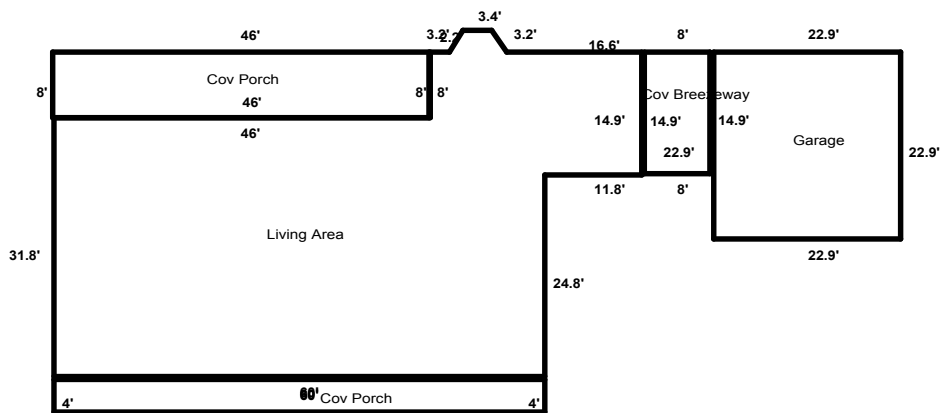

SUMMARY	SQ FT AREA	PERIMETER	AREA CALCULATION DETAILS	
Living Area			First Floor	
First Floor	2210	226	5.2 X 2.6 =	13.5
			17.5 X 0.1 =	1.7
Porches/Patios			25.8 X 7.9 =	203.8
Cov Porch	240	128	71.8 X 7.0 =	502.6
Cov Porch	368	108	60.0 X 24.8 =	1488.0
Subtotal	608	236	Total	2209.6
Cov. Breezeway	119	46		
Garage/Carport				
Garage	524	92		

Market Realty, Inc. / Roger D. Chambers

Roger Chambers

SKETCH-IT 1-800-523-0872