

Soils Map

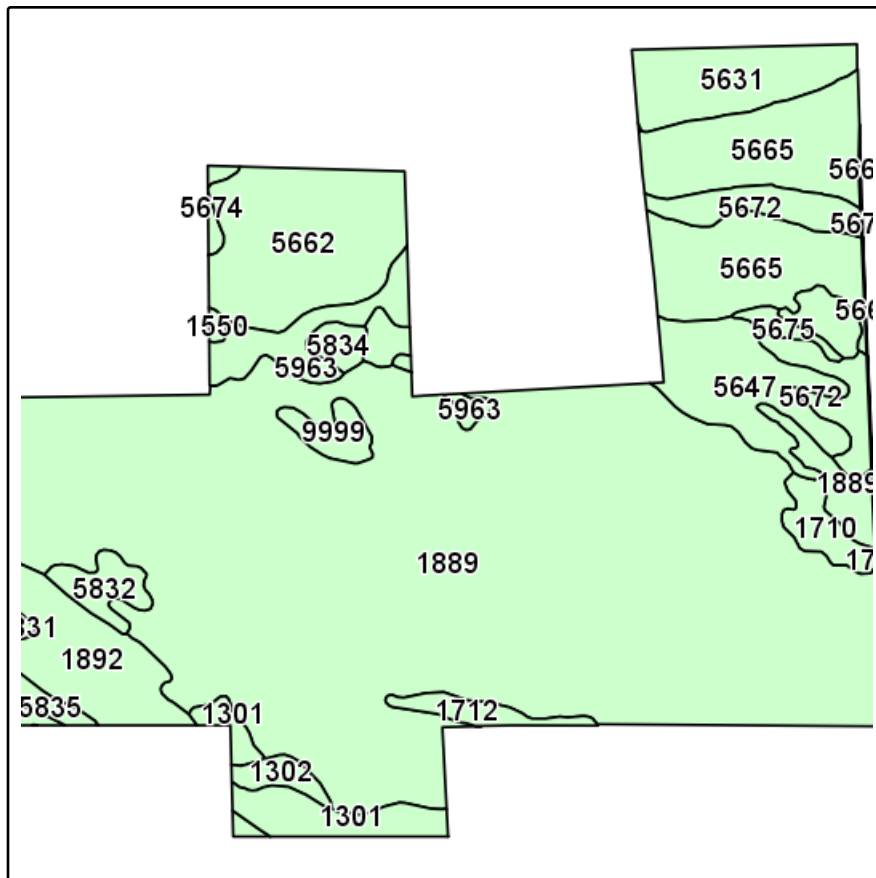

Field borders provided by Farm Service Agency as of 5/21/2008.
Soils data provided by USDA and NRCS.

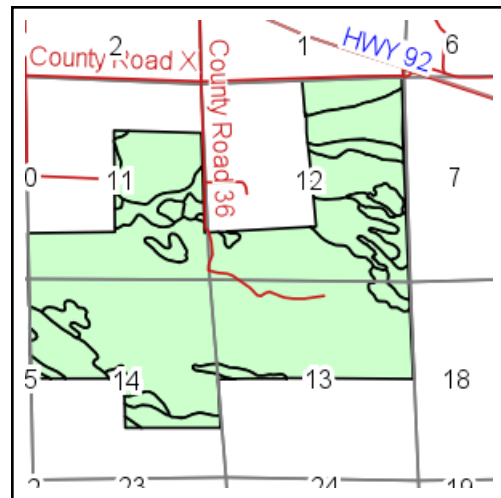

State: **Nebraska**
County: **Scotts Bluff**
Location: **12-20N-53W**
Township: **Castle Rock**
Acres: **1333.7**
Date: **9/13/2012**



KRAUPIE'S
REAL ESTATE & AUCTIONEERS
917 Main St PO Box 100 Bridgeport, NE 69336
308-262-1150 www.farmauction.net



Maps provided by:

surety
CUSTOMIZED ONLINE MAPPING
©AgriData, Inc 2012
www.AgriDataInc.com

Code	Soil Description	Acres	Percent of field	Non-Irr Class	Irr Class	Productivity Index	SRPG	Alfalfa hay Irrigated	Corn Irrigated	Dry beans Irrigated	Sugar beets Irrigated	Winter wheat
1889	Valent fine sand, rolling	803.3	60.2%	Vle		18	18					
5665	Minatare-Janise complex, rarely flooded	115.3	8.6%	Vls		0	16					
5662	McGrew loam, alkali, occasionally flooded	83	6.2%	IVs	IIIls	0	11	3.9	90	18	16	24
5647	Janise soils, rarely flooded	50	3.8%	Vls		0	15					
1892	Valent loamy fine sand, 3 to 9 percent slopes	48	3.6%	Vle	IVe	23	23	3.3	95			
5631	Gering loam, alkali, occasionally flooded	42.1	3.2%	IVs	IVs	0	23	4.1	95	20	17	26
5672	Yockey silt loam, alkali, occasionally flooded	37.8	2.8%	IVs	IIIls	0	12	3.7	90	24	20	26
5963	Jayem fine sandy loam, 1 to 3 percent slopes	28.8	2.2%	IIIe	Ile	0	44	4.4	130	34	20	30
1301	Bayard fine sandy loam, 3 to 6 percent slopes	28.2	2.1%	IVe	IIIe	0	42	4.3	125	33	17	26
9999	Water	20	1.5%			0	0					
1710	Otero very fine sandy loam, 3 to 6 percent slopes	13.5	1.0%	IVe	IIIe	0	42	4.5	120	31	19	29
5832	Mitchell fine sandy loam, 3 to 6 percent slopes	13.2	1.0%	IIIe	IIIe	0	44	4.6	120	32	19	30
1712	Otero-Bayard fine sandy loams, 0 to 3 percent slopes	10	0.7%	IIIe	Ile	0	41	4.3	130	28	19	27
1302	Bayard fine sandy loam, 6 to 9 percent slopes	7.9	0.6%	IVe	IVe	0	40	3.6	120	26	14	21
5834	Mitchell silt loam, 0 to 1 percent slopes	6.6	0.5%	IIIc	I	0	48	5.5	130	39	24	44
5966	Jayem fine sandy loam, 3 to 6 percent slopes	6.2	0.5%	IVe	IIIe	0	43	4	125	29	17	26
5675	Yockey loam, occasionally flooded	5	0.4%	IVs	IIIls	0	11	4.3	100	20	18	29
5835	Mitchell silt loam, 1 to 3 percent slopes	4.9	0.4%	IIIe	Ile	0	47	5.3	124	37	23	39
5674	Yockey fine sandy loam, occasionally flooded	3.1	0.2%	IVs	IIIls	0	11	4.3	95	20	18	27
1880	Valent and Dwyer fine sands, rolling	1.6	0.1%	Vle		0	17					

1550	Dailey and Valent loamy fine sands, 3 to 6 percent slopes	1.5	0.1%	Vle	IVe	0	18	3.1	110	22	14	
1889	Valent fine sand, rolling	1.2	0.1%	Vle		0	12					
5831	Mitchell fine sandy loam, 0 to 3 percent slopes	1	0.1%	IIIe	Ile	0	45	5.1	125	36	23	36
5665	Minatare-Janise complex, rarely flooded	0.8	0.1%	VIIs		0	16					
5672	Yockey silt loam, alkali, occasionally flooded	0.6	0.0%	IVs	IIIIs	0	12	3.7	90	24	20	26
1710	Otero very fine sandy loam, 3 to 6 percent slopes	0.1	0.0%	IVe	IIIe	0	42	4.5	120	31	19	29
Weighted Average						11.7	19.4	1	26.7	5.5	3.9	5.9