



## Listing-040-201-1

# AERIAL, DRAINAGE & SOIL MAPS



State: Iowa  
 County: Kossuth  
 Location: 7-95N-30W  
 Township: Whitemore  
 Acres: 70.6  
 Date: 5/29/2012



Maps provided by:



©AgriData, Inc 2012  
 www.AgriDataInc.com

Field borders provided by Farm Service Agency as of 5/21/2008. Aerial photography provided by Aerial Photography Field Office.

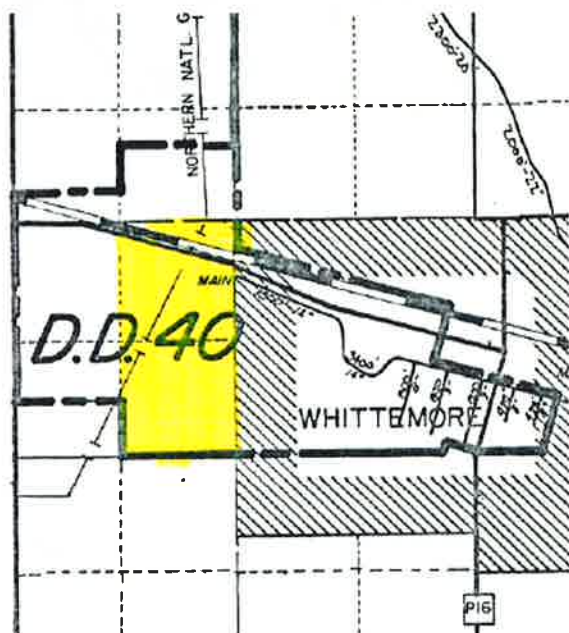
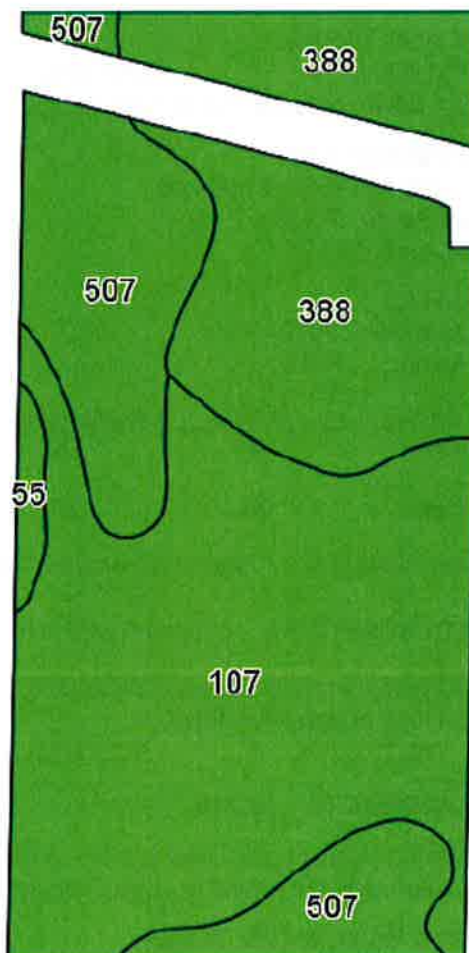

Code	Soil Description	Acres	Percent of field	CSR Legend	Non-Irr Class	CSR	Corn	Soybeans
107	Webster silty clay loam, 0 to 2 percent slopes	35.4	50.3%		IIw	80	197	53
388	Kossuth silty clay loam, 0 to 2 percent slopes	19.4	27.4%		IIw	75	190	51
507	Canisteo clay loam, 0 to 2 percent slopes	14.8	21.0%		IIw	75	190	51
55	Nicollet loam, 1 to 3 percent slopes	1	1.4%		I	85	204	55
Weighted Average						77.7	193.9	52.1

WE ARE PLEASED TO OFFER THESE SERVICES

Sales • Acquisition • Auctions • Investment Analysis • Exchanging • Farm and Ranch Management • Appraisals