

KEITH HULL AND
MICHELLE HULL
INST. #020005117
T.M. #51-55B

ROBERT F. KING &
DENISE W. KING
D.B. 421 PG. 481
T.M. #51-53

N/7 HOWARD JACKSON ELLISON,
III & ANDREA H. ELLISON
INST. #030005652
T.M. #51-55

HOWARD JACKSON ELLISON, III
& ANDREA H. ELLISON
INST. #030005652
T.M. #51-55

ADJ. OWNER C/PF @
83.90' LT OF LINE 1.6'

NEW PARCEL 'A'
0.997 AC.
PART OF T.M. #51-52

NEW PARCEL 'B'
0.695 AC.
PART OF T.M. #51-52

ONA MARTIN PARKS ESTATE
WILL INSTR. #100000172
T.M. #51-56

THEODORE HASLUP
& FREDIA HASLUP
INST. #060003144
T.M. #51-51

JASON BUCHANAN
INST. #070001860
T.M. #51-50

BLAINE J. RHODES &
MARY P. RHODES
D.B. 279 PG. 574
T.M. #51-47

ACREAGE TABLE
1.692 AC. (T.M. #51-52)
-0.997 AC. (NEW PARCEL 'A')
0.695 AC. (NEW PARCEL 'B')

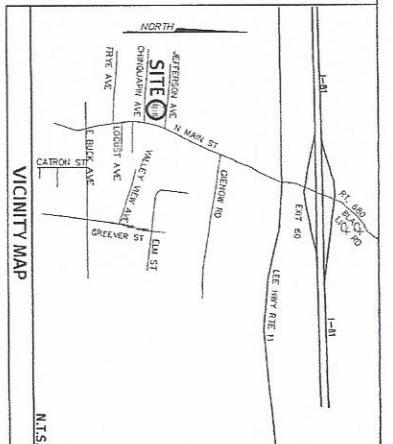

- NOTES:
1. THIS PLAT HAS BEEN PREPARED FROM AN ACTUAL FIELD SURVEY DONE AS PER DATE OF THIS PLAT AND THERE ARE NO VISIBLE EASEMENTS OR ENCROACHMENTS EXCEPT AS SHOWN.
 2. THIS PLAT HAS BEEN PREPARED WITHOUT THE BENEFIT OF A TITLE REPORT AND DOES NOT, THEREFORE, NECESSARILY INDICATE ALL ENCUMBRANCES ON THE PROPERTY.
 3. THE AREA SHOWN HEREON IS LOCATED IN FLOOD HAZARD ZONE 'X' AND IS NOT LOCATED WITHIN FLOOD HAZARD ZONE 'A' FOR A 100 YEAR FLOOD AS DETERMINED BY THE FEDERAL EMERGENCY MANAGEMENT AGENCY AS SHOWN ON COMMUNITY-PANEL MAP #5119/201700 DATED 05/02/08.
 4. NEW PARCEL 'B' IS CURRENTLY SERVED BY PUBLIC WATER AND PUBLIC SEWERAGE SYSTEMS.
 5. RESTRICTIONS, IF ANY, ARE TO BE RECORDED SIMULTANEOUSLY WITH THIS PLAT.
 6. TOTAL ACREAGE FOR SUBJECT PROPERTY CONSISTS OF 1.692 ACRES. THE INTENT OF THIS PLAT TO CREATE TWO NEW PARCELS FROM ONE ORIGINAL PARCEL.

SOURCE OF TIME: T.M. #51-52
THE AREA SHOWN WAS ACQUIRED BY ANDREW J. PARKS, JR. FROM ONA M. PARKS BY DEED DATED DECEMBER 6, 1996 AS RECORDED IN D.B. 460 PG. 327 OF THE CIRCUIT COURT CLERK'S OFFICE OF WYTHE COUNTY, VIRGINIA.

PLAT OF REFERENCE:
PLAT BY KEITH NIDAY TITLED "PLAT SHOWING PROPERTY OF MARY FRANCES HUTTON" AND DATED "AUGUST 10, 1994". RECORDED IN D.B. 446 P.G. 150 OF THE CIRCUIT COURT CLERK'S OFFICE OF WYTHE COUNTY, VIRGINIA.

SUBDIVISION APPROVED:
THE SUBDIVISION KNOWN AS ANDREW J. PARKS, JR. DIVISION IS APPROVED BY THE UNDERSIGNED IN ACCORDANCE WITH EXISTING SUBDIVISION REGULATIONS AND MAY BE COMMITTED TO RECORD.

TOWN MANAGER DATE

THE PLATTING OR DEDICATION OF THE FOLLOWING DESCRIBED LAND KNOWN AS THE ANDREW J. PARKS, JR. DIVISION IS WITH THE FREE CONSENT AND IN TRUSTEES, IF ANY.

ANDREW J. PARKS, JR. DATE

COMMONWEALTH AT LARGE TO WIT:

STATE OF VIRGINIA

COUNTY/CITY OF

A NOTARY PUBLIC IN AND FOR THE STATE AFORESAID, DO HEREBY CERTIFY THAT THE OWNERS/REPRESENTATIVES WHOSE NAMES ARE SIGNED HEREON HAVE ACKNOWLEDGED THE SAME BEFORE ME THIS DAY OF 20

MY COMMISSION EXPIRES: 20

NOTARY PUBLIC

PLAT SHOWING SINGLE LOT DIVISION FOR PROPERTY OF ANDREW J. PARKS, JR. TOWN OF RURAL RETREAT, WYTHE COUNTY, VIRGINIA

HURT & PROFFITT
INCORPORATED
350 S. 4TH STREET
WYTHEVILLE VA 24382
800.242.4906 TOLL FREE
276.228.0008 MAIN
276.228.0008 FAX

PROJECT NO. 20121043
G.L. NO.
DATE 06/08/2012
DRAWN BY: MHT
CHECKED BY: MHT

SHEET NO.
1 OF 1

