



For Sale

Brooks Road Farm



Capital
Agricultural
Property
Services, Inc.

www.capitalag.com

67.5 ± acres

Quitman County, MS

Size: 67.5± total acres, 64.0± FSA cropland

Possession: At closing, subject to existing farmland lease.

Location: This farm is located in Quitman County, Mississippi and is adjacent to the southeast boundary of the town of Marks, MS.

Showing: By appointment only.

Management: Professional farm management is available.

FSA Data: (2010)	Crop	Base Acres	Yield
	Cotton	34.1	477 lb.
	Wheat	14.3	38 bu.
	Grain Sorghum	7.0	39 bu.

Description: This farm lies adjacent to the southeast boundary of the town of Marks, MS. along Brooks Road, a paved county road just off of Highway 3. With a very high percentage of Class I and II silt loam soils, this farm has excellent production potential. This dryland tract has been dedicated primarily to grain production in recent years but is suitable for cotton. The property looks to be easily improved with good drainage from the field. The farm is approximately 95% cropland with a high percentage of FSA bases.

Soils: Predominant cropland soil types are Dundee and Dubbs sandy and silt loams, with some Sharkey clay.

Taxes: 2010: \$1,107.69 (approximately \$16.41 per acre)

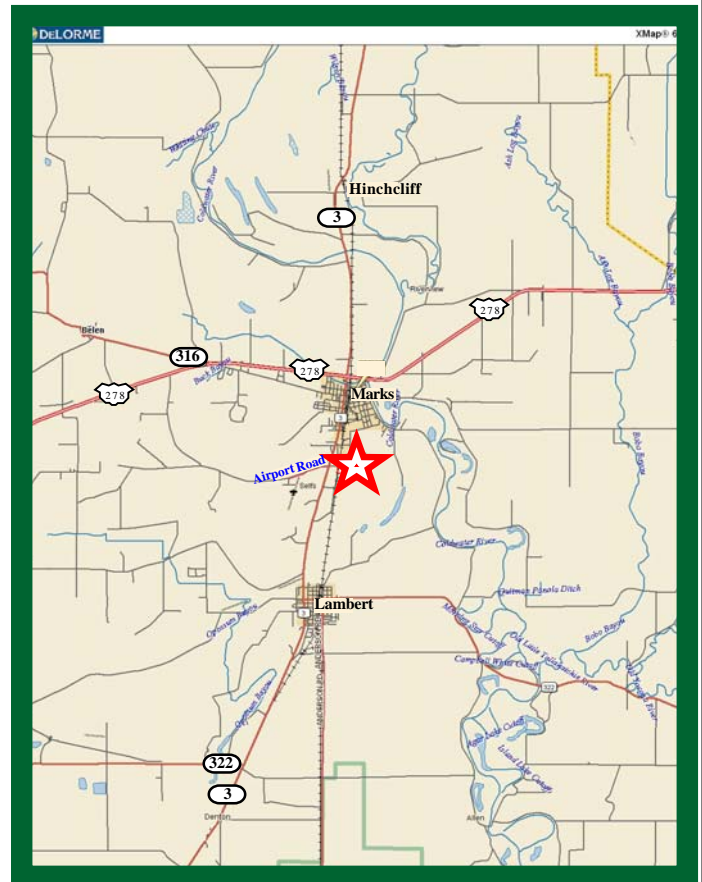

See reverse side for additional maps.

For more information contact:

Murry McClintock - Real Estate Salesperson

Tel: (662) 363-1801

Agent for Seller



The information contained herein is from sources Capital Agricultural Property Services, Inc. (CAPS) considers reliable, such as, but not necessarily including or limited to, Seller, CFSA and NRCS records and data, and information from other government agencies and offices. However, CAPS has not independently verified and does not guarantee the accuracy, completeness or sufficiency of this information. The prospective Buyer is, therefore, advised to independently confirm information provided herein, and any reliance upon this data is made at Buyer's own risk. Similarly, the past history of this property is no guaranty of future performance, which is subject to unpredictable variables such as weather management and operational skills, market factors and general economic conditions. Accordingly, CAPS does not assume, and hereby expressly disclaims, any responsibility for the future operating and investment results of the property.

CAPS' participation in this transaction is solely in the capacity of a real estate broker, and it does not hold itself out as having expertise or specialized knowledge in the fields of environmental science, engineering, chemistry, hydrology, meteorology, geology, seismology, health or financial investments. No statement made by CAPS relating to this property may be relied upon by the buyer as reflecting particular expertise in these or any other areas of specialized knowledge. In the course of conducting a due diligence inspection of the property, the prospective Buyer is strongly advised to consult with such brokers, attorneys, financial advisors or other professional or expert consultants as may be necessary to fully protect the Buyer's rights and interests.

Capital Agricultural Property Services, Inc., as Real Estate Broker, only represents the SELLER in this transaction. This offering is subject to prior sale, matters of title, change of price, rental or conditions and to any special listing conditions or requirements the seller may impose, and it may be withdrawn from the market without advance notice.

Brooks Road Farm

67.5 ± acres
Quitman County, MS



Capital
Agricultural
Property
Services, Inc.

www.capitalag.com

Property Aerial Map



Capital
Agricultural
Property
Services, Inc.

Maps provided by:



©AgriData, Inc. 2011

www.AgriDataInc.com

2-27N-1W
Quitman County
Mississippi

map center: 34° 14' 14.7, 90° 16' 19.64
scale: 10171

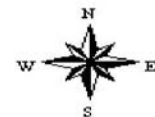

7/7/2011

Field borders provided by Farm Service Agency as of 5/21/2008. Aerial photography provided by Aerial Photography Field Office.

For more information contact:

Murry McClintock - Real Estate Salesperson
Tel: (662) 363-1801

Agent for Seller

Brooks Road Farm

67.5 ± acres
Quitman County, MS



**Capital
Agricultural
Property
Services, Inc.**

www.capitalag.com

Property Soils and Topography Maps

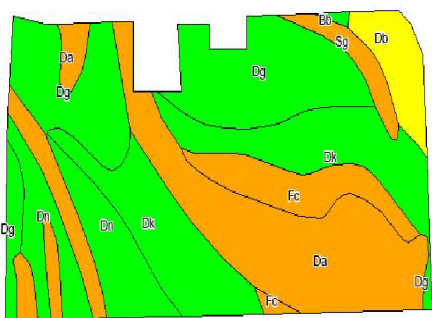

State: Mississippi
County: Quitman
Location: 002-027N-001W
Township: District 3
Acres: 73.5
Date: 7/7/2011



Maps provided by:



©AgriData, Inc. 2008
www.AgrDataInc.com

Fsa borders provided by the Farm Service Agency as of May 23, 2008.
Soils data provided by USDA and NRCS.

Code	Soil Description	Acres	Percent of field	Non-Irr Class Legend	Non-Irr Class	Corn	Cotton lint	Rice Irrigated	Soybeans	Wheat
Da	Dowling clay and silty clay (sharkey)	20.6	27.9%		Vw					
Dg	Dundee fine sandy loam, nearly level phase	18.2	24.8%		llw	85	750		40	45
Dk	Dundee silt loam, nearly level phase	16	21.8%		llw	85	750		40	45
Dn	Dundee silty clay loam, nearly level phase	8.3	11.3%		llw	85	750		40	45
Fc	Forestdale silt loam, nearly level phase	5.1	7.0%		llw	50	600	130	35	40
Db	Dubbs fine sandy loam, nearly level phase	3.3	4.5%		I	90	850		40	50
Sg	Souva silt loam, nearly level phase (sharkey)	1.8	2.5%		llle		600		35	47
Bb	Beulah sandy loam, gently sloping phase	0.2	0.2%		lls	70	550		30	45
Weighted Average						56.9	530.6	9.1	28.3	32.4

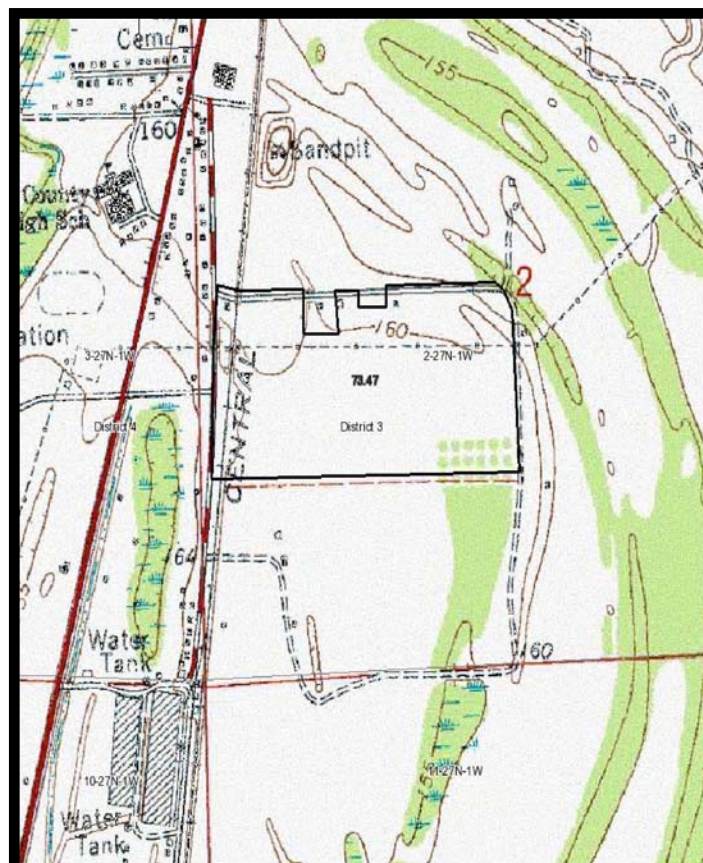

©AgriData, Inc. 2011
www.AgrDataInc.com

Field borders provided by Farm Service Agency as of 5/21/2008. Aerial photography provided by Aerial Photography Field Office.

2-27N-1W
Quitman County
Mississippi

map center: 34° 14' 14.7, 90° 16' 19.64
scale: 10171



7/7/2011

For more information contact:
Murry McClintock - Real Estate Salesperson
Tel: (662) 363-1801
Agent for Seller