

## NOTICE OF LAND SALE

### "Burks Drive Tract" - Listing #4277

NE 1/4 of SW 1/4 of Section 32, T4S, R24W, Montgomery County, Arkansas,  
containing 40 acres, more or less

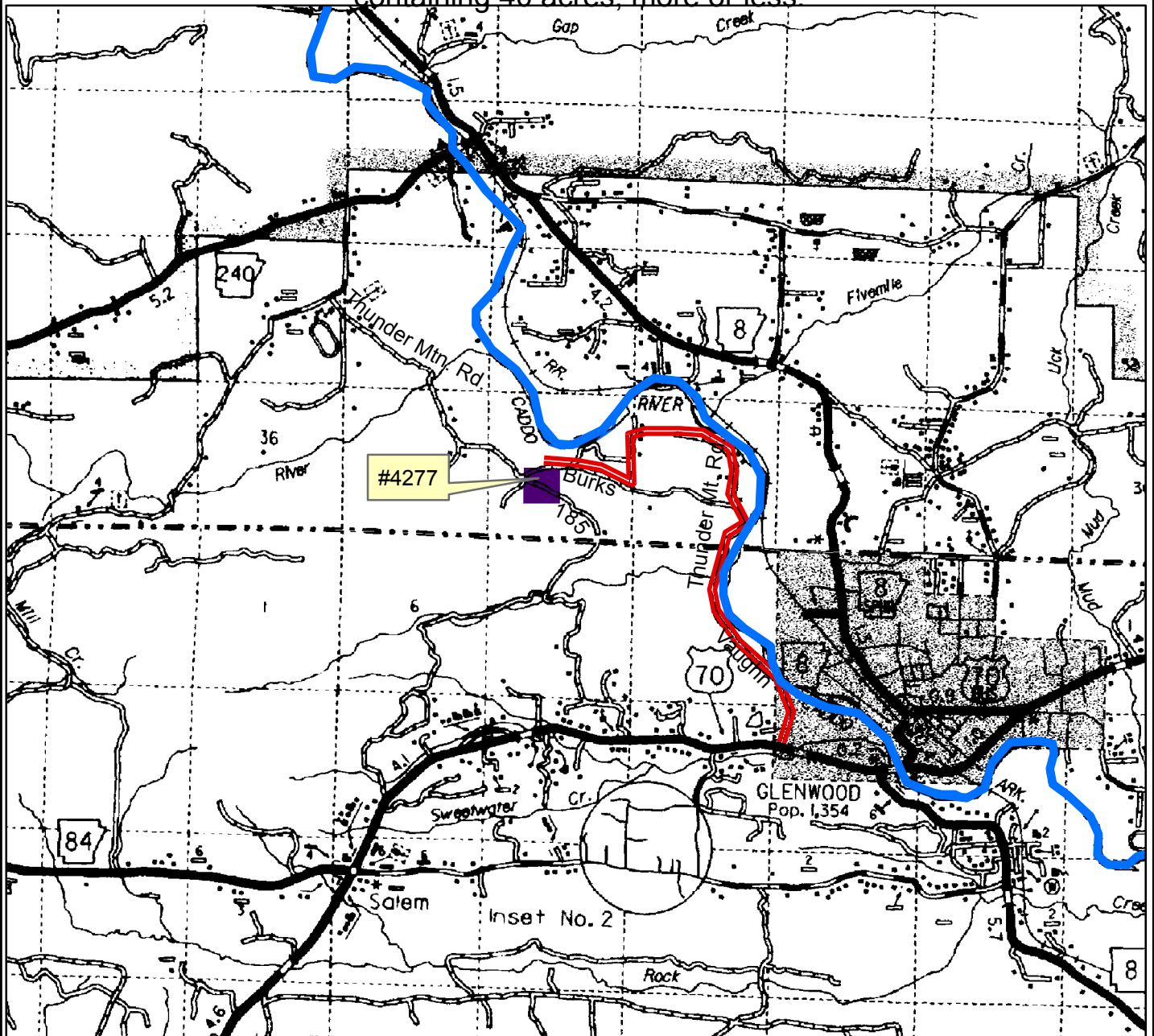

Driving Directions: From Hwy. 70 / Hwy. 8 Junction at Glenwood, go west on Hwy. 70 for approximately 0.6 mile. Turn RIGHT (NORTH) onto Vaughn Road just after you cross Sweetwater Creek bridge. Go north on Vaughn Road (narrow and sharp curves along Caddo River) for approximately 0.8 mile. Stay straight on Thunder Mountain Road and continue for approximately 2.5 miles to gravel Burks Drive. Turn RIGHT (WEST) onto Burks Drive and go approx. 0.5 mile to the northeast corner of the property (marked with pink flagging). Property is mostly on left (south) side of Burks Drive for next 0.25 mile. At west boundary (marked with pink flagging) turn LEFT onto County Road 185 (no road sign), which goes back east through the property.

0 0.5 1 2  
Miles



Created: July, 2011  
Drawn By: MEC