

NO.	DATE	BY	REVISION
1	11/17/08	JM	ISSUED FOR PERMITS
2	11/17/08	JM	ISSUED FOR PERMITS
3	11/17/08	JM	ISSUED FOR PERMITS
4	11/17/08	JM	ISSUED FOR PERMITS
5	11/17/08	JM	ISSUED FOR PERMITS
6	11/17/08	JM	ISSUED FOR PERMITS
7	11/17/08	JM	ISSUED FOR PERMITS
8	11/17/08	JM	ISSUED FOR PERMITS
9	11/17/08	JM	ISSUED FOR PERMITS
10	11/17/08	JM	ISSUED FOR PERMITS

GRAY ENGINEERING CONSULTANTS, INC.
 engineering - site work - land planning
 152 WILSON ROAD - GREENVILLE, SC 29615
 PH: (864) 297-3827 - FAX: (864) 297-1519
 WWW.GRAYENGINEERING.COM

CRAWFORD LAKE
 STAKEOUT PLAN
 SC HWY 8
 ANDERSON COUNTY, SC

CV-1
 SHEET
 DRAWN BY: JRM
 CHECKED BY: JRM
 PROJECT DATE: 11/17/08
 DATE: 11/17/08
 SCALE: 1"=100'
 JOB NO.: 080100
 PROJECT: CRAWFORD LAKE
 152 WILSON ROAD
 GREENVILLE, SC 29615

LOCATION MAP

ROAD CURVE TABLE

CURVE	LENGTH	RADIUS	DELTA	TANGENT	CHORD	AREA
1	100.00	100.00	90.00	70.71	70.71	7853.98
2	100.00	100.00	90.00	70.71	70.71	7853.98
3	100.00	100.00	90.00	70.71	70.71	7853.98
4	100.00	100.00	90.00	70.71	70.71	7853.98
5	100.00	100.00	90.00	70.71	70.71	7853.98
6	100.00	100.00	90.00	70.71	70.71	7853.98
7	100.00	100.00	90.00	70.71	70.71	7853.98
8	100.00	100.00	90.00	70.71	70.71	7853.98
9	100.00	100.00	90.00	70.71	70.71	7853.98
10	100.00	100.00	90.00	70.71	70.71	7853.98

NOTE: ALL WORK WITHIN THE SCOTCH B.O.W. TO BE COMPLETED PRIOR TO THE APPROVED ENCROACHMENT PERMIT.

NOTE: CONTRACTOR TO PROVIDE SIGNAGE TO BE INSTALLED NORTH OF PROPOSED DRIVE ENCROACHMENT.

NOTE: CONTRACTOR TO PROVIDE SIGNAGE TO BE INSTALLED NORTH OF PROPOSED DRIVE ENCROACHMENT.

NOTE: CONTRACTOR TO PROVIDE SIGNAGE TO BE INSTALLED NORTH OF PROPOSED DRIVE ENCROACHMENT.

NOTE: CONTRACTOR TO PROVIDE SIGNAGE TO BE INSTALLED NORTH OF PROPOSED DRIVE ENCROACHMENT.

NOTE: CONTRACTOR TO PROVIDE SIGNAGE TO BE INSTALLED NORTH OF PROPOSED DRIVE ENCROACHMENT.

NOTE: CONTRACTOR TO PROVIDE SIGNAGE TO BE INSTALLED NORTH OF PROPOSED DRIVE ENCROACHMENT.

NOTE: CONTRACTOR TO PROVIDE SIGNAGE TO BE INSTALLED NORTH OF PROPOSED DRIVE ENCROACHMENT.

NOTE: CONTRACTOR TO PROVIDE SIGNAGE TO BE INSTALLED NORTH OF PROPOSED DRIVE ENCROACHMENT.

NOTE: CONTRACTOR TO PROVIDE SIGNAGE TO BE INSTALLED NORTH OF PROPOSED DRIVE ENCROACHMENT.

NOTE: CONTRACTOR TO PROVIDE SIGNAGE TO BE INSTALLED NORTH OF PROPOSED DRIVE ENCROACHMENT.

NOTE: CONTRACTOR TO PROVIDE SIGNAGE TO BE INSTALLED NORTH OF PROPOSED DRIVE ENCROACHMENT.

NOTE: CONTRACTOR TO PROVIDE SIGNAGE TO BE INSTALLED NORTH OF PROPOSED DRIVE ENCROACHMENT.

NOTE: CONTRACTOR TO PROVIDE SIGNAGE TO BE INSTALLED NORTH OF PROPOSED DRIVE ENCROACHMENT.

NOTE: CONTRACTOR TO PROVIDE SIGNAGE TO BE INSTALLED NORTH OF PROPOSED DRIVE ENCROACHMENT.

NOTE: CONTRACTOR TO PROVIDE SIGNAGE TO BE INSTALLED NORTH OF PROPOSED DRIVE ENCROACHMENT.

NOTE: CONTRACTOR TO PROVIDE SIGNAGE TO BE INSTALLED NORTH OF PROPOSED DRIVE ENCROACHMENT.

NOTE: CONTRACTOR TO PROVIDE SIGNAGE TO BE INSTALLED NORTH OF PROPOSED DRIVE ENCROACHMENT.

NOTE: CONTRACTOR TO PROVIDE SIGNAGE TO BE INSTALLED NORTH OF PROPOSED DRIVE ENCROACHMENT.

NOTE: CONTRACTOR TO PROVIDE SIGNAGE TO BE INSTALLED NORTH OF PROPOSED DRIVE ENCROACHMENT.

NOTE: CONTRACTOR TO PROVIDE SIGNAGE TO BE INSTALLED NORTH OF PROPOSED DRIVE ENCROACHMENT.

NOTE: CONTRACTOR TO PROVIDE SIGNAGE TO BE INSTALLED NORTH OF PROPOSED DRIVE ENCROACHMENT.

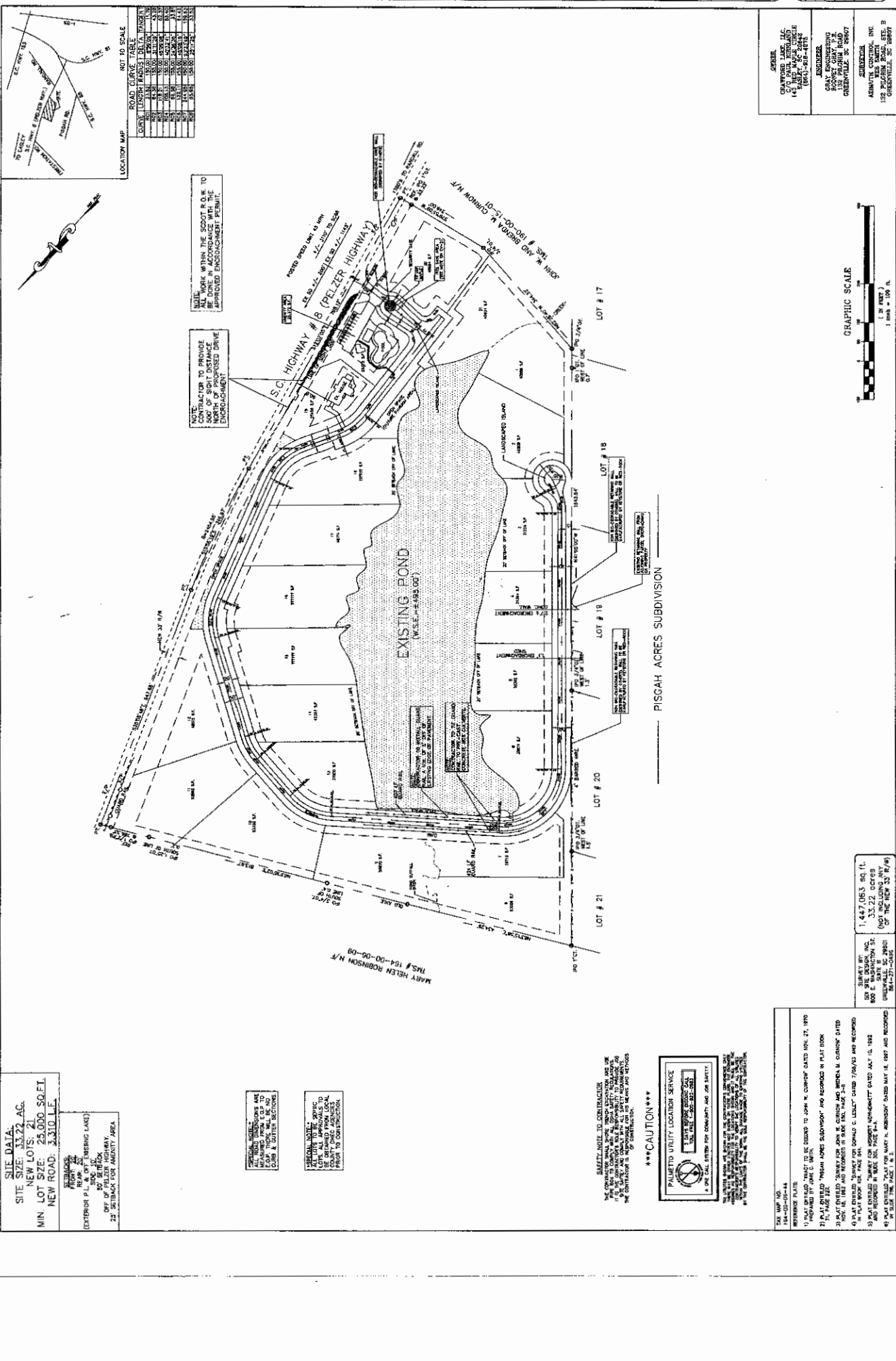
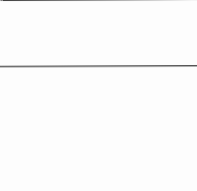
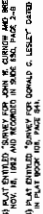
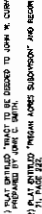
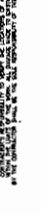
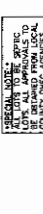
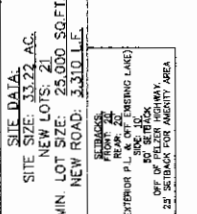
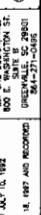
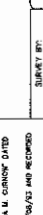
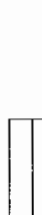
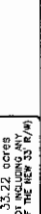
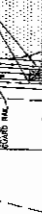
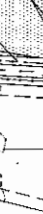
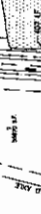
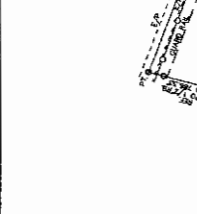
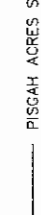
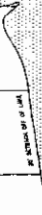
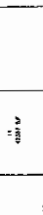
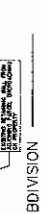
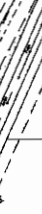
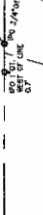
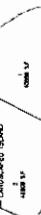
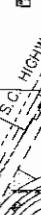
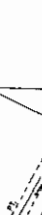
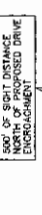

SITE DATA:
 SITE SIZE: 33.22 AC.
 NEW LOTS: 21
 MIN. LOT SIZE: 25,000 SQ.FT.
 NEW ROAD: 3,310 L.F.

SETBACKS:
 FRONT: 20'
 REAR: 20'
 SIDE: 10'
 OFF OF PALZER HIGHWAY: 20'
 20' SETBACK FOR ADJACENT AREA.

GENERAL NOTES:
 1. ALL WORK TO BE DONE WITHIN THE SCOTCH B.O.W. TO BE COMPLETED PRIOR TO THE APPROVED ENCROACHMENT PERMIT.
 2. CONTRACTOR TO PROVIDE SIGNAGE TO BE INSTALLED NORTH OF PROPOSED DRIVE ENCROACHMENT.
 3. CONTRACTOR TO PROVIDE SIGNAGE TO BE INSTALLED NORTH OF PROPOSED DRIVE ENCROACHMENT.
 4. CONTRACTOR TO PROVIDE SIGNAGE TO BE INSTALLED NORTH OF PROPOSED DRIVE ENCROACHMENT.
 5. CONTRACTOR TO PROVIDE SIGNAGE TO BE INSTALLED NORTH OF PROPOSED DRIVE ENCROACHMENT.
 6. CONTRACTOR TO PROVIDE SIGNAGE TO BE INSTALLED NORTH OF PROPOSED DRIVE ENCROACHMENT.
 7. CONTRACTOR TO PROVIDE SIGNAGE TO BE INSTALLED NORTH OF PROPOSED DRIVE ENCROACHMENT.
 8. CONTRACTOR TO PROVIDE SIGNAGE TO BE INSTALLED NORTH OF PROPOSED DRIVE ENCROACHMENT.
 9. CONTRACTOR TO PROVIDE SIGNAGE TO BE INSTALLED NORTH OF PROPOSED DRIVE ENCROACHMENT.
 10. CONTRACTOR TO PROVIDE SIGNAGE TO BE INSTALLED NORTH OF PROPOSED DRIVE ENCROACHMENT.

CAUTION
 PALMETTO UTILITY LOCATION SERVICE
 1. USE ONLY FOR CONDUIT AND JOB SAFETY.
 2. NOT TO BE USED FOR ANY OTHER PURPOSES.
 3. NOT TO BE USED FOR ANY OTHER PURPOSES.
 4. NOT TO BE USED FOR ANY OTHER PURPOSES.
 5. NOT TO BE USED FOR ANY OTHER PURPOSES.
 6. NOT TO BE USED FOR ANY OTHER PURPOSES.
 7. NOT TO BE USED FOR ANY OTHER PURPOSES.
 8. NOT TO BE USED FOR ANY OTHER PURPOSES.
 9. NOT TO BE USED FOR ANY OTHER PURPOSES.
 10. NOT TO BE USED FOR ANY OTHER PURPOSES.

CAUTION
 PALMETTO UTILITY LOCATION SERVICE
 1. USE ONLY FOR CONDUIT AND JOB SAFETY.
 2. NOT TO BE USED FOR ANY OTHER PURPOSES.
 3. NOT TO BE USED FOR ANY OTHER PURPOSES.
 4. NOT TO BE USED FOR ANY OTHER PURPOSES.
 5. NOT TO BE USED FOR ANY OTHER PURPOSES.
 6. NOT TO BE USED FOR ANY OTHER PURPOSES.
 7. NOT TO BE USED FOR ANY OTHER PURPOSES.
 8. NOT TO BE USED FOR ANY OTHER PURPOSES.
 9. NOT TO BE USED FOR ANY OTHER PURPOSES.
 10. NOT TO BE USED FOR ANY OTHER PURPOSES.

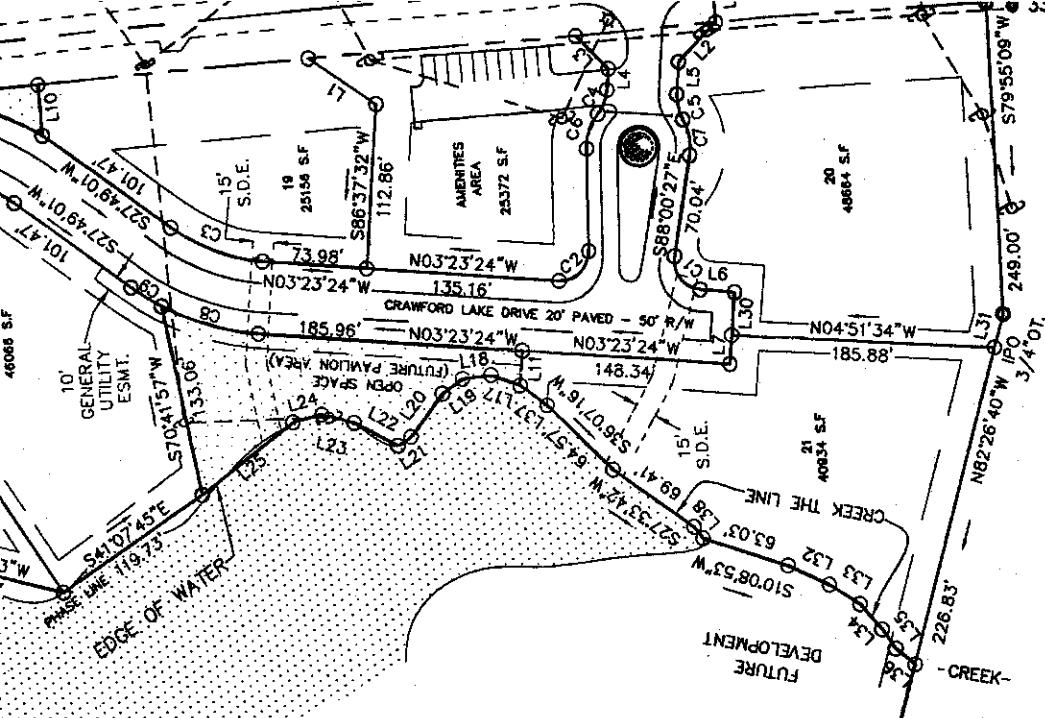

JOHN W. AND BRENDA M. CURNOW N/F
TMS. # 190-00-15-01

LOT	AREA (SF)	BEARING	DISTANCE
L8	34.00	S48°17'25"W	54.81
L9	35.61	N77°57'56"E	58.37
L10	24.15	N88°37'32"E	38.91
L11	28.51	S61°50'14"E	46.53
L12	38.81	S60°18'22"E	63.81
L13	28.51	S48°38'14"E	46.53
L14	55.63	S48°38'14"E	93.06
L15	71.61	S48°38'14"E	119.73
L16	33.80	S32°15'28"W	54.81
L17	21.27	S14°35'02"E	34.00
L18	20.19	S42°35'12"E	33.06
L19	17.38	S60°14'10"E	28.51
L20	37.08	S40°07'20"E	60.72
L21	11.03	S20°19'55"W	18.18
L22	34.37	S08°40'34"W	56.41
L23	23.52	S31°41'38"E	38.91
L24	20.96	S44°11'18"E	34.00
L25	82.68	S12°02'04"E	138.41
L26	121.48	S20°35'48"E	200.95
L27	94.57	N77°57'56"E	158.88
L28	33.00	N52°48'50"E	54.81
L29	24.72	N82°25'40"W	40.32
L30	24.53	N82°25'40"W	40.32
L31	32.10	S24°38'26"W	52.41
L32	25.52	S40°46'34"W	42.41
L33	23.41	S41°39'54"W	38.91
L34	16.18	S41°39'54"W	27.22
L35	17.22	S42°32'64"W	28.51
L36	23.59	S28°38'33"W	38.91
L37	10.21	S42°37'23"W	16.18
L38			

CURVE	LENGTH	RADIUS	CHORD BEARING	CHORD LENGTH
1	33.18	20.00	S44°28'19"W	29.42
2	33.05	20.00	S50°44'24"E	29.42
3	70.81	130.00	S12°14'45"W	69.83
4	16.43	30.00	S73°38'10"E	17.98
5	18.23	30.00	S69°32'18"W	17.98
6	25.74	37.00	N78°08'24"E	25.23
7	25.74	37.00	N72°03'43"E	25.23
8	72.32	180.00	S08°08'07"W	71.83
9	25.67	180.00	S23°15'51"W	25.65
10	17.82	125.00	N53°37'47"W	17.80
11	70.64	125.00	N33°31'24"W	68.70
12	31.96	175.00	N52°38'54"W	31.81
13	91.88	175.00	N32°22'34"W	14.62
14	14.63	180.00	S54°48'30"W	14.62
15	127.18	180.00	S77°22'38"W	124.85
16	71.98	180.00	N08°33'14"W	71.90
17	5.35	180.00	N70°58'32"W	5.35
18	94.57	120.00	N05°14'27"E	92.14
19	102.41	130.00	S79°00'57"W	99.79
20	15.36	130.00	N78°39'59"W	15.35
21	40.48	130.00	N68°41'34"W	40.32
22	133.97	170.00	N08°14'27"E	130.53
23	342.50	2421.89	N15°58'18"W	342.21

- NOTES:**
- SUBJECT PROPERTY IS CURRENTLY UNDEVELOPED RESIDENTIAL.
 - THERE IS A 5' DRAINAGE AND UTILITY EASEMENT ALONG EACH SIDE AND REAR LOT LINE.
 - THERE IS A 50' SETBACK ALONG PELZER HIGHWAY, A 25' SETBACK FOR AMENITY AREA, THERE ARE 20' FRONT SETBACKS ALONG INTERNAL ROADS AND, 20' REAR SETBACKS WITH 10' SIDE SETBACKS FOR ALL LOTS.
 - ALL LOTS ARE TO HAVE INTERNAL ACCESS ONLY.
 - ALL NEW ROADS WILL HAVE A 50' R/W.
 - A STORMWATER MANAGEMENT AND SEDIMENT REDUCTION PLAN HAS BEEN PREPARED FOR THIS PROPERTY AND WILL BE APPLIED FOR LAND DISTURBING ACTIVITIES. THE STORMWATER PERMIT NUMBER IS 04-07-02-03. EACH PROPERTY OWNER WILL COMPLY WITH THIS PLAN UNLESS AN INDIVIDUAL PLAN IS PREPARED AND APPROVED FOR THAT PROPERTY.
 - ANDERSON COUNTY IS NOT RESPONSIBLE FOR THE MAINTENANCE OF THE DETENTION AREA. CRAWFORD LAKE HOME OWNERS ASSOCIATION WILL BE RESPONSIBLE FOR ALL MAINTENANCE OF THE DETENTION AREAS.
 - IN THE EVENT THAT STORM DRAIN STRUCTURES WERE NOT VISIBLE AT THE TIME OF SURVEY, S.D.E. SHOWN HEREON ARE BASED ON ENGINEER'S DESIGN.
 - LOT 19 PREVIOUSLY RECORDED FOR TY RUSHING BY AZIMUTH CONTROL LAND SURVEYORS, INC. IN PLAT BOOK S1706 AT PAGE 6-B TO BE COMBINED WITH AND MADE A PART OF THIS SUBDIVISION.

SETBACKS:
FRONT: 20'
REAR: 20'
(EXTERIOR P.L. & OFF EXISTING LAKE)
50' SETBACK
OFF OF PELZER HIGHWAY,
25' SETBACK FOR AMENITY AREA

OF THAT DESCRIBED IN A DEED FOR
DATED DECEMBER 11, 2008, AND
ERSON COUNTY RMC OFFICE IN D.B.

- KEY:**
- DENOTES IPF 1/2" REBAR
 - DENOTES IPS 1/2" REBAR
 - DENOTES MAG. NAIL SET