



1. Zoned HC.

2.59 acres (112,820 est. SF).

\$424,000 or \$3.76 SF.

Detention in for street only.

SOLD

Interstate 44 – Chestnut Expressway

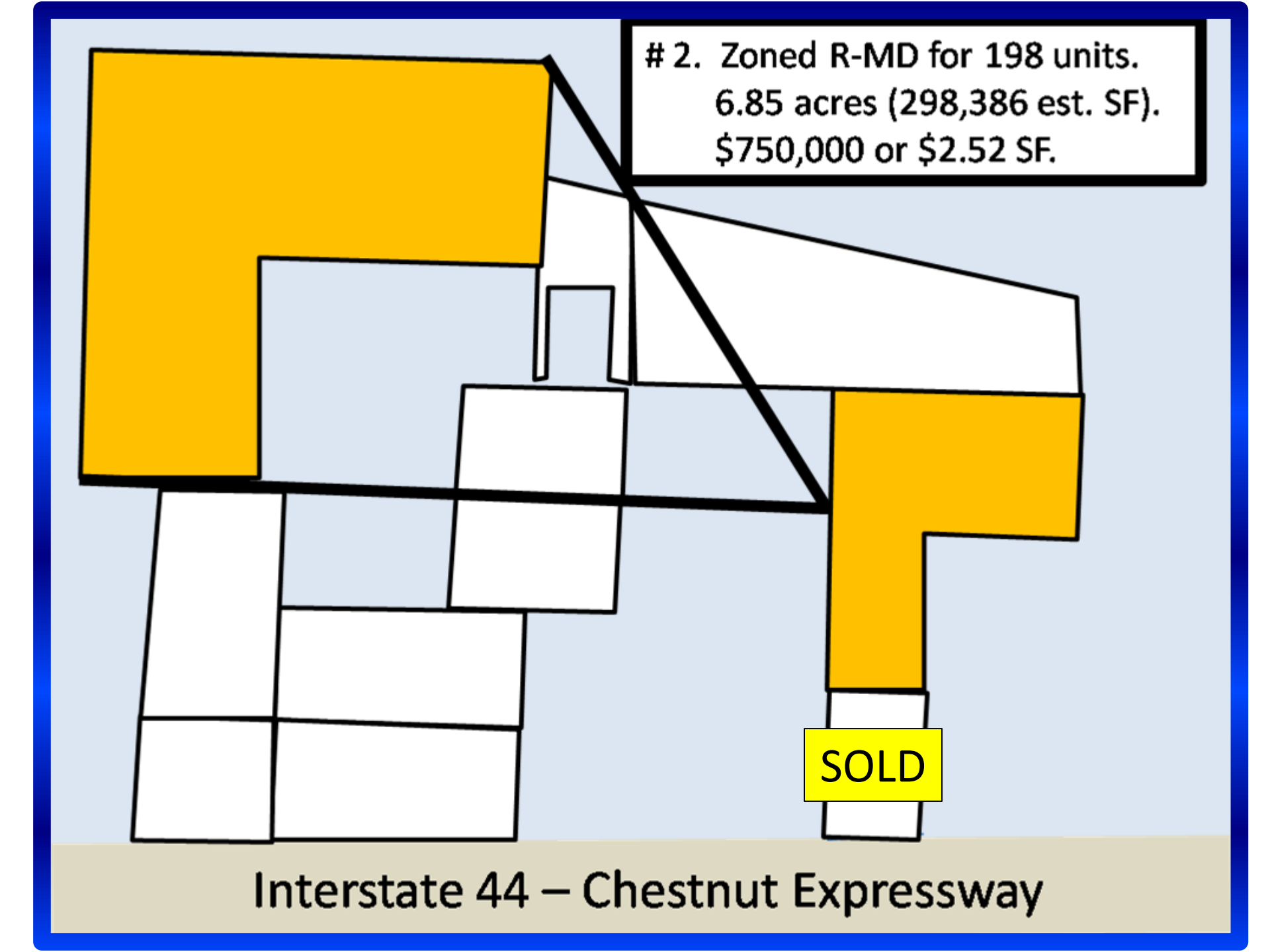

2. Zoned R-MD for 198 units.
6.85 acres (298,386 est. SF).
\$750,000 or \$2.52 SF.

SOLD

Interstate 44 – Chestnut Expressway

3. Zoned PD 263 for 246 units.
13.71 acres (597,208 est. SF).
\$1,080,000 or \$1.81 SF.

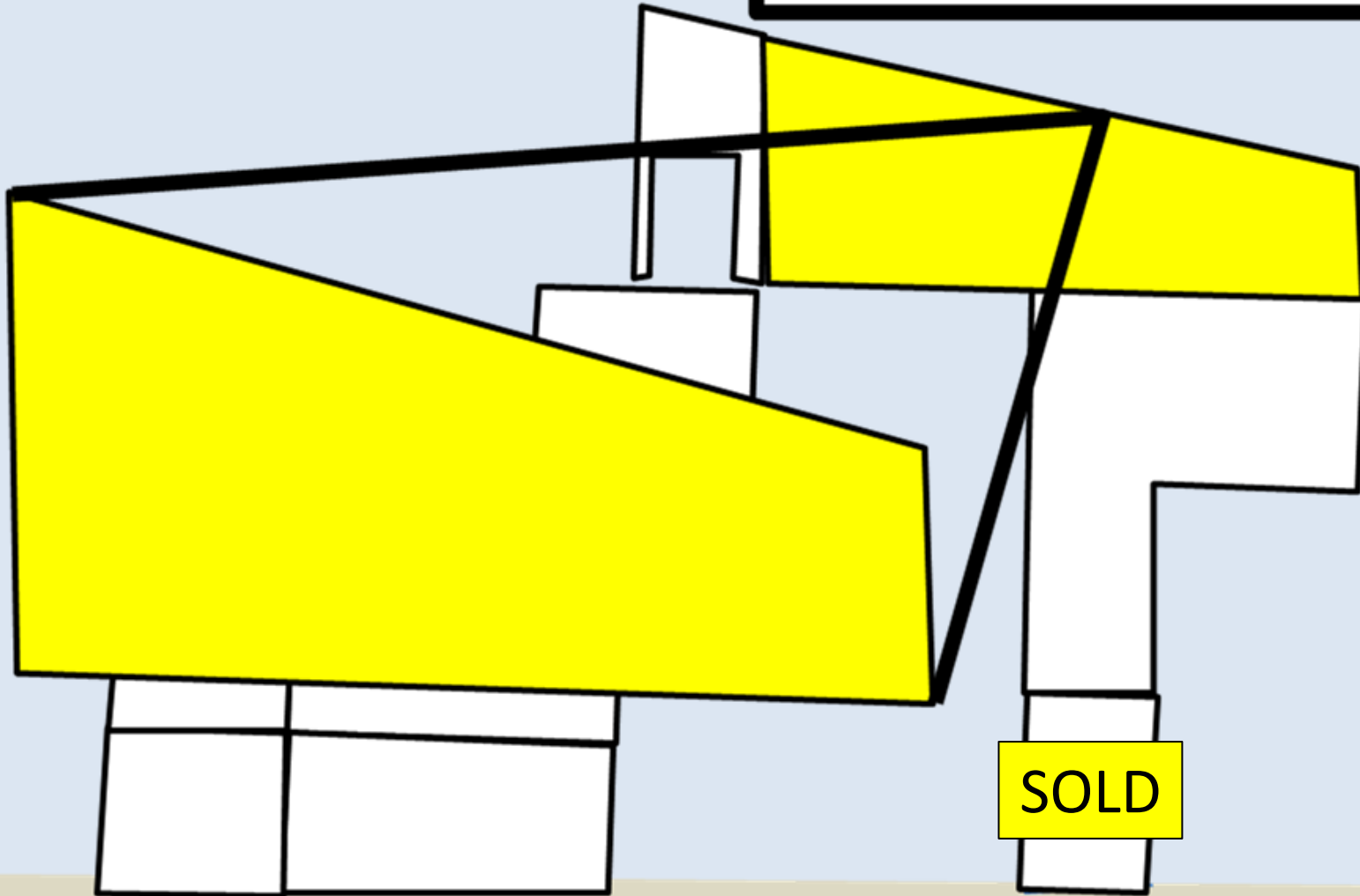

Interstate 44 – Chestnut Expressway

4. Zoned R-LD for 47 units.
2.76 acres (120,226 est. SF).
\$206,000 or \$1.72 SF.

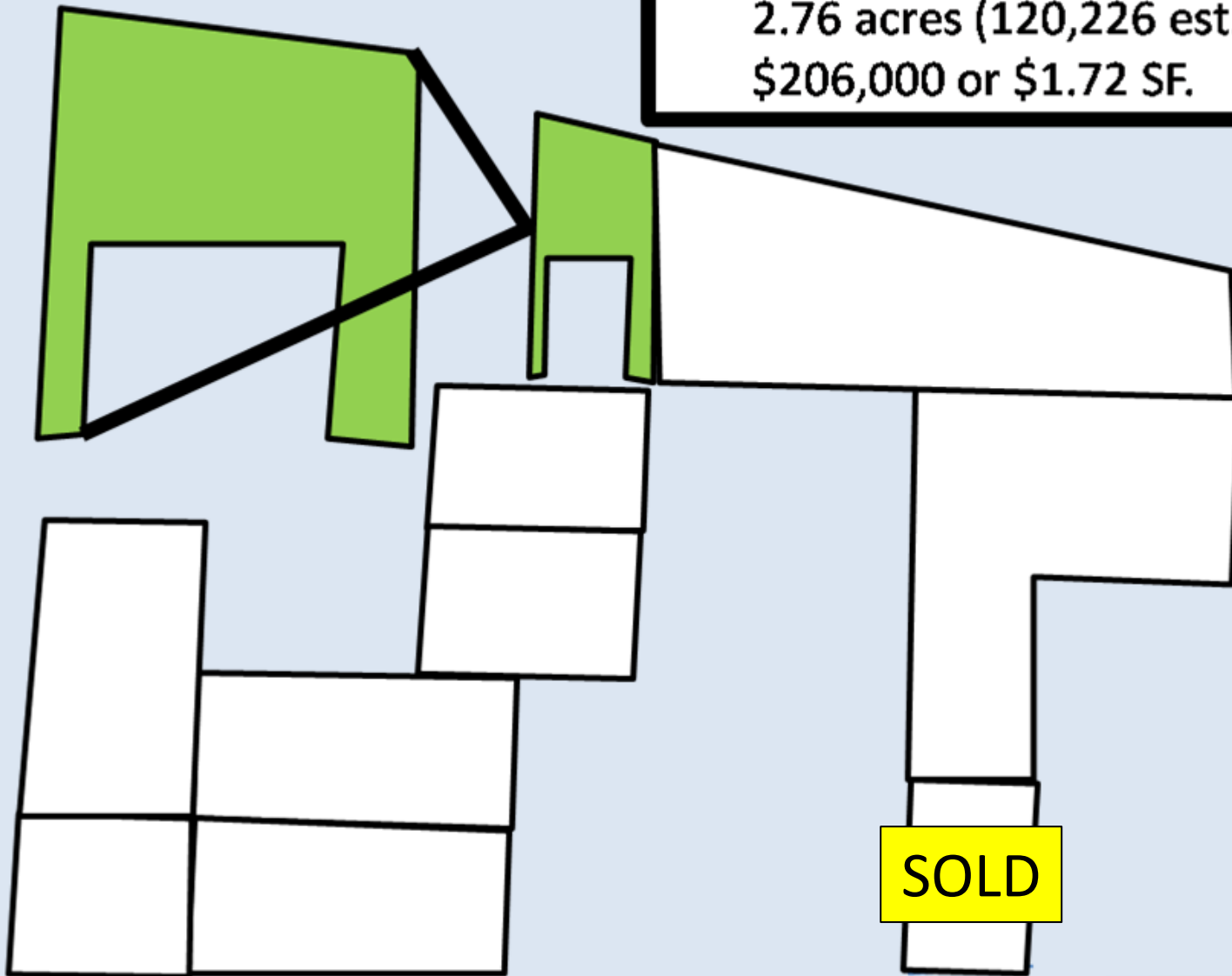

SOLD

Interstate 44 – Chestnut Expressway



REDUCED \$126K

5. Zoned R-TH for 15 duplex lots.
3.17 acres (138,000 est. SF).
REDUCED FROM \$523,500 or
\$3.80 SF to \$397,500 or \$2.88 SF
15 - 80 * 115 minimum lots.
Detention in and off-site.

SOLD

Interstate 44 – Chestnut Expressway



The map displays several land parcels outlined in black. A large blue rectangle in the upper left is connected by a line to a smaller blue rectangle, which in turn points to a callout box. Other parcels are shown in white. A yellow 'SOLD' label is placed on a small parcel near the bottom right. The entire map is set against a light blue background with a tan strip at the bottom.

6. Zoned R-MD.

1.61 acres (70,132 est. SF).

\$239,000 or \$3.41 SF.

Detention in and off-site

48 unit site plan included.

SOLD

Interstate 44 – Chestnut Expressway

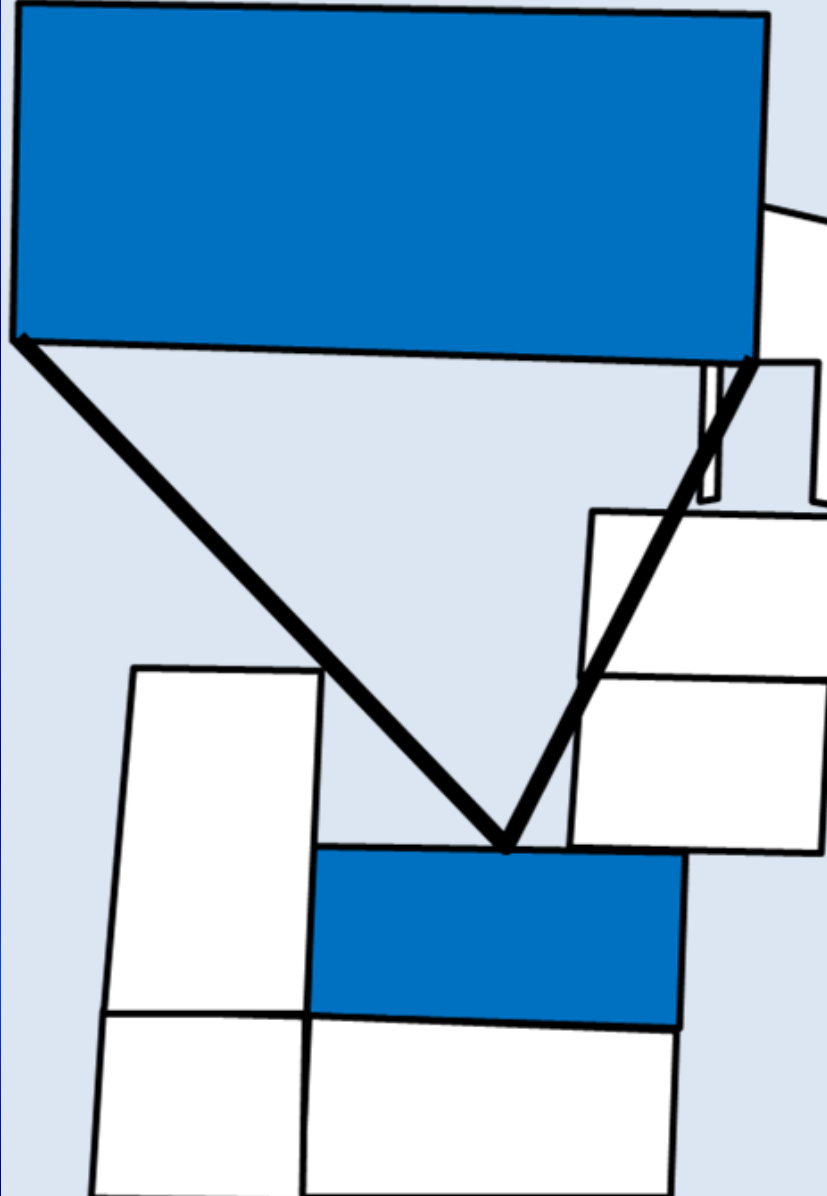

7. Zoned R-MD.

3.69 acres (160,736 est. SF).

\$314,000 or \$1.96 SF.

Detention in and on-site.

SOLD

Interstate 44 – Chestnut Expressway



A map showing several land parcels. A large dark blue parcel at the top left is connected by a line to a callout box. Other parcels are shown in white and dark blue. A yellow 'SOLD' label is on a parcel to the right. A tan bar at the bottom represents Interstate 44.

8. Zoned HC.

481' W Chestnut frontage.

3.80 acres (165,528 est. SF).

\$424,000 or \$2.57 SF.

Detention in and on-site.

SOLD

Interstate 44 – Chestnut Expressway



9. Zoned HC.

336' W Chestnut frontage.

2.09 acres (91,040 est. SF).

\$327,000 or \$3.60 SF.

SOLD

Interstate 44 – Chestnut Expressway

A map of land parcels is shown against a light blue background. A large grey pencil is positioned vertically on the left side, with its tip pointing to a specific parcel. The parcels are represented by various polygons, some of which are shaded grey and others white. The parcel being pointed to is a grey rectangle. To the right of this parcel is a larger white L-shaped parcel. Further to the right is another white parcel. At the bottom of the map is a tan-colored horizontal band representing a highway.

10. Zoned GM.

Self-storage plan included.

5.04 acres (219,542 est. SF).

\$390,000 or \$1.78 SF.

SOLD

Interstate 44 – Chestnut Expressway

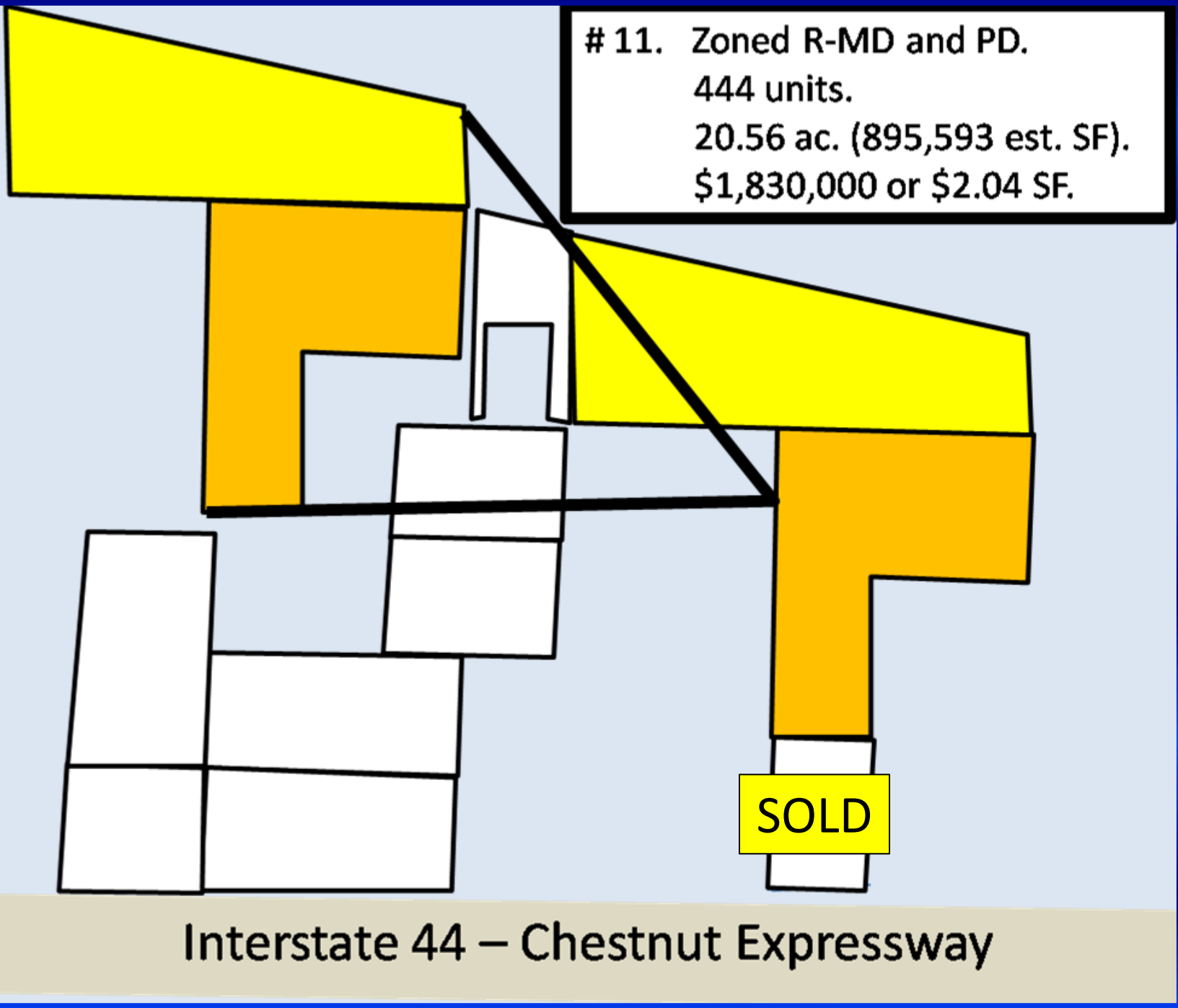

11. Zoned R-MD and PD.
444 units.
20.56 ac. (895,593 est. SF).
\$1,830,000 or \$2.04 SF.

SOLD

Interstate 44 – Chestnut Expressway



12. Zoned HC.

817' W Chestnut frontage.

5.89 acres (256,568 est. SF).

\$751,000 or \$2.29 SF.

SOLD

Interstate 44 – Chestnut Expressway

14. 9 remaining tracts .
817' W Chestnut frontage.
42.72 acres.
\$4,253,500 or \$2.29 SF.

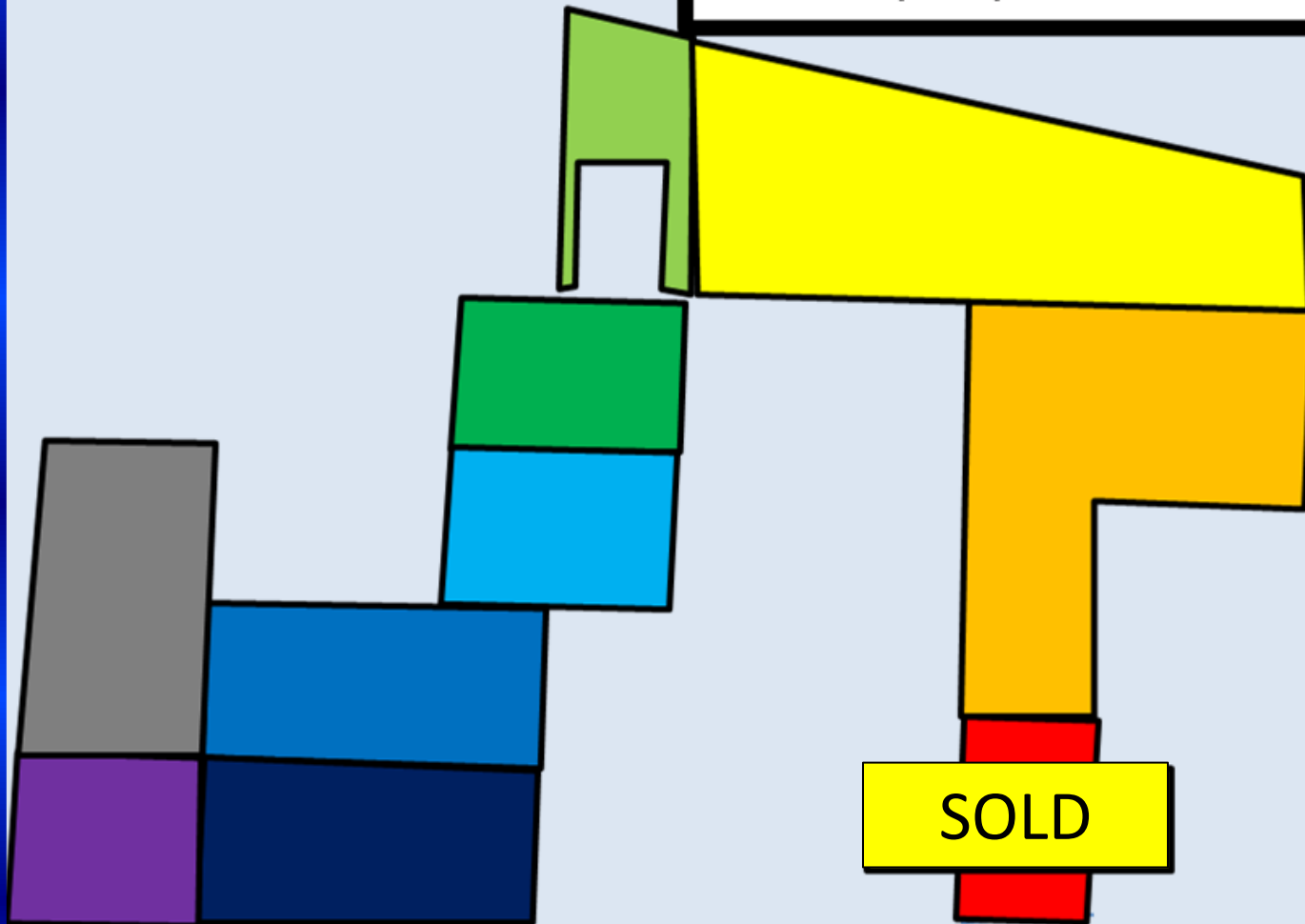

Interstate 44 – Chestnut Expressway

