

LAND FOR SALE

Willisville 33 Tract - +/- 33 Acres

Sec. 23, T14S, R21W

Nevada County, AR

Listing #
1109

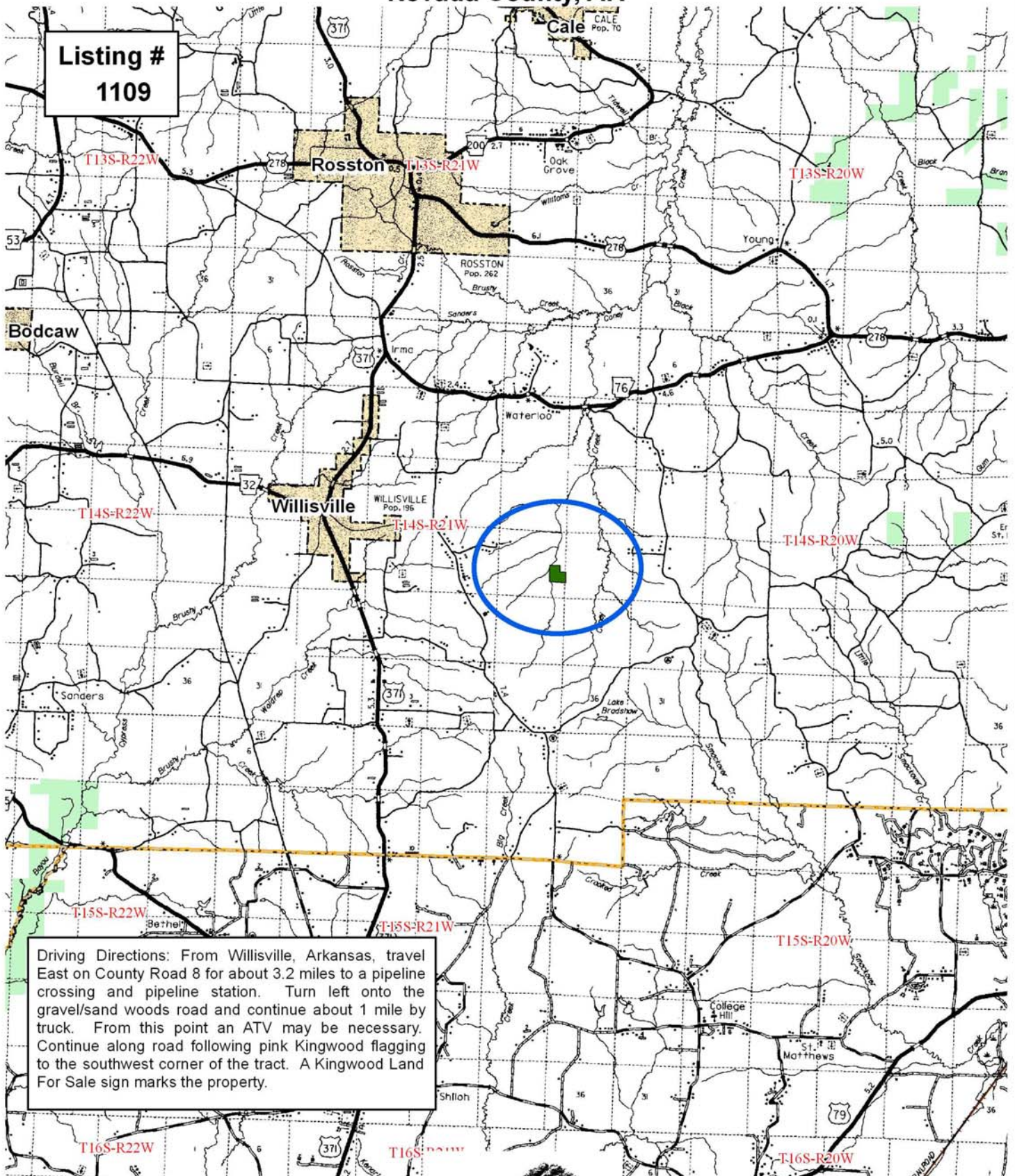

Driving Directions: From Willisville, Arkansas, travel East on County Road 8 for about 3.2 miles to a pipeline crossing and pipeline station. Turn left onto the gravel/sand woods road and continue about 1 mile by truck. From this point an ATV may be necessary. Continue along road following pink Kingwood flagging to the southwest corner of the tract. A Kingwood Land For Sale sign marks the property.