

LAND SALE NOTICE

Lone Pine Road Tract (Listing #4194)
Part of NW 1/4 of Section 15, T11S, R19W,
Clark County, Arkansas,
containing 70 acres, more or less.

LAND SALE NOTICE

Riverfront Tract (Listing #4195)
Part N 1/2 of NW 1/4 of Section 23, T11S, R19W,
Clark County, Arkansas,
containing 26 acres, more or less.

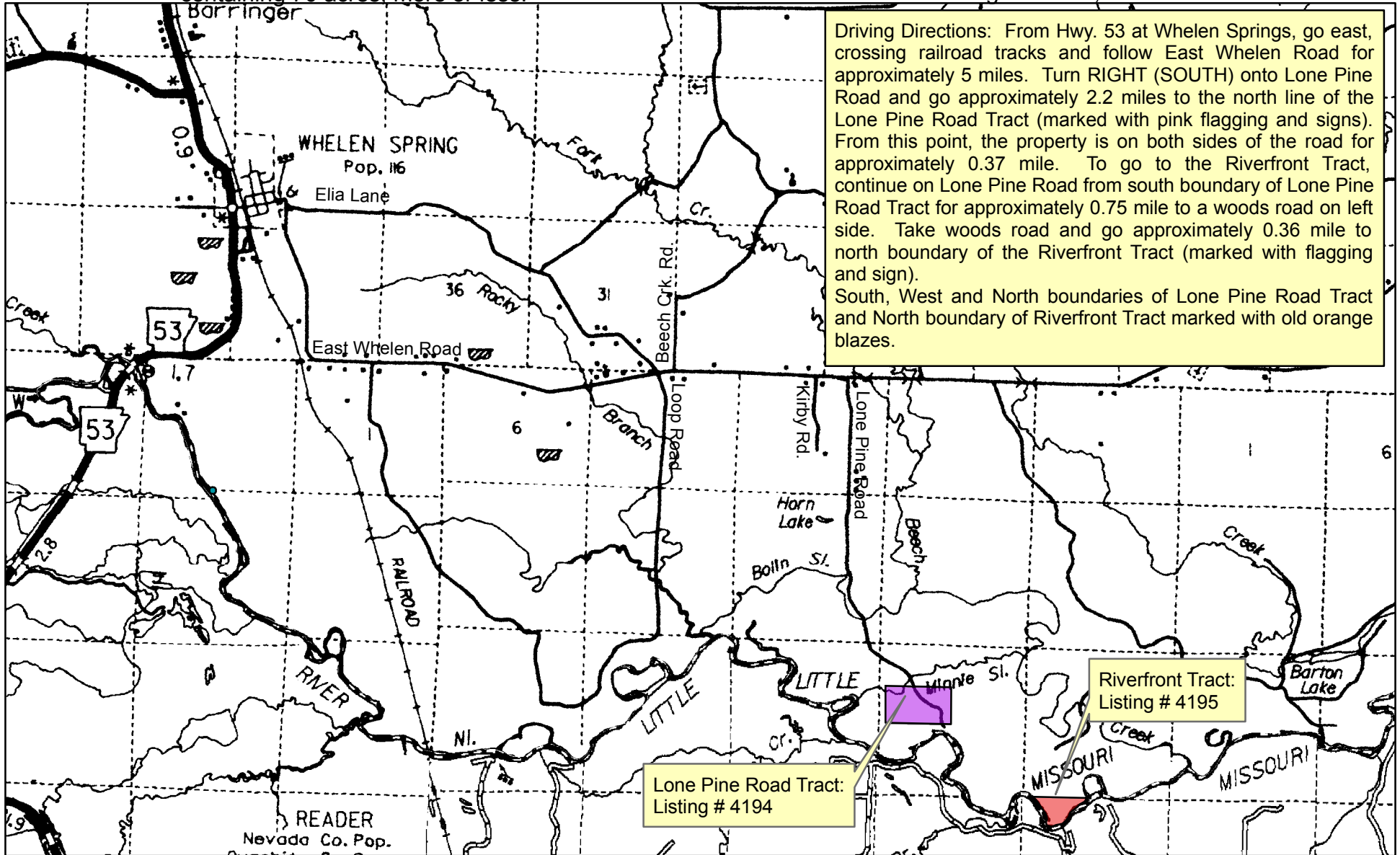

Driving Directions: From Hwy. 53 at Whelen Springs, go east, crossing railroad tracks and follow East Whelen Road for approximately 5 miles. Turn RIGHT (SOUTH) onto Lone Pine Road and go approximately 2.2 miles to the north line of the Lone Pine Road Tract (marked with pink flagging and signs). From this point, the property is on both sides of the road for approximately 0.37 mile. To go to the Riverfront Tract, continue on Lone Pine Road from south boundary of Lone Pine Road Tract for approximately 0.75 mile to a woods road on left side. Take woods road and go approximately 0.36 mile to north boundary of the Riverfront Tract (marked with flagging and sign). South, West and North boundaries of Lone Pine Road Tract and North boundary of Riverfront Tract marked with old orange blazes.

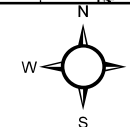
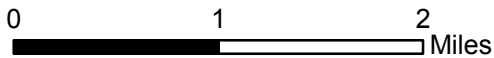

Location
MEC