



*Beautiful  
property only  
1 mile west of  
Ft. Meade*



*Great fishing lake  
on property*



**SAUNDERS  
REAL ESTATE**

*Land · Commercial · Conservation · Property Management*  
5120 S. Lakeland Drive  
Suite 3  
Lakeland, FL 33813

*Owner willing  
to divide into  
3 tracts*

*107 +/- total acres  
Central Florida Lakefront Acreage  
Ft. Meade, Florida*

Toll Free: 1-877-518 LAND · [www.saundersrealestate.com](http://www.saundersrealestate.com)

# *Central Florida Lakefront Acreage*

## *107 Acres · Will Divide Acuff Road, Ft. Meade*



*Owner  
willing to  
Divide into  
3 tracts*



**SAUNDERS  
REAL ESTATE**

*Land · Commercial · Conservation · Property Management*  
5120 S. Lakeland Drive, Suite 3 · Lakeland, FL 33813  
Phone: 863-648-1528 · Toll Free: 1-877-518 LAND  
[www.saundersrealestate.com](http://www.saundersrealestate.com)

# Central Florida Lakefront Acreage

**Acreage:**  
107 +/- acres

**Price:**  
~~\$1,500,000~~  
**NEW PRICE \$9,000 per acre**  
**(\$963,000)**

**Owner willing to divide into**  
**3 tracts---all with lake frontage!**

**Location:**  
Acuff Road; Ft. Meade, Florida  
Polk County

**Road Frontage:**  
Frontage on Acuff Road

**Current Land Use:**  
ARR; Agriculture

**Future Land Use:**  
Residential

**Natural Water on Site:**  
Deep 40-acre Lake

**Fencing:**  
Barbed wire fencing

**S.T.R.:**  
33-31-25

**Parcel #:**  
25313300000043010

***Property is***  
***located 1 mile west***  
***of Ft. Meade***

While every attempt is made to provide as accurate information on this property offering as possible, COLDWELL BANKER COMMERCIAL SAUNDERS REAL ESTATE (CBCSRE) does not guarantee the accuracy thereof. Buyer shall rely entirely on their own information and inspection of property and records. © Copyright Coldwell Banker Commercial Saunders Real Estate, All Rights Reserved, Worldwide: All content inclusive of text, graphics, images, and logos is the property of CBCSRE. You may not copy this material by any means (including electronic copies), reproduce, duplicate, scan, modify, publish, transfer, use on your own website, distribute, or create a derivative work without receiving written permission from CBCSRE.

## Deep 40 Acre Lake

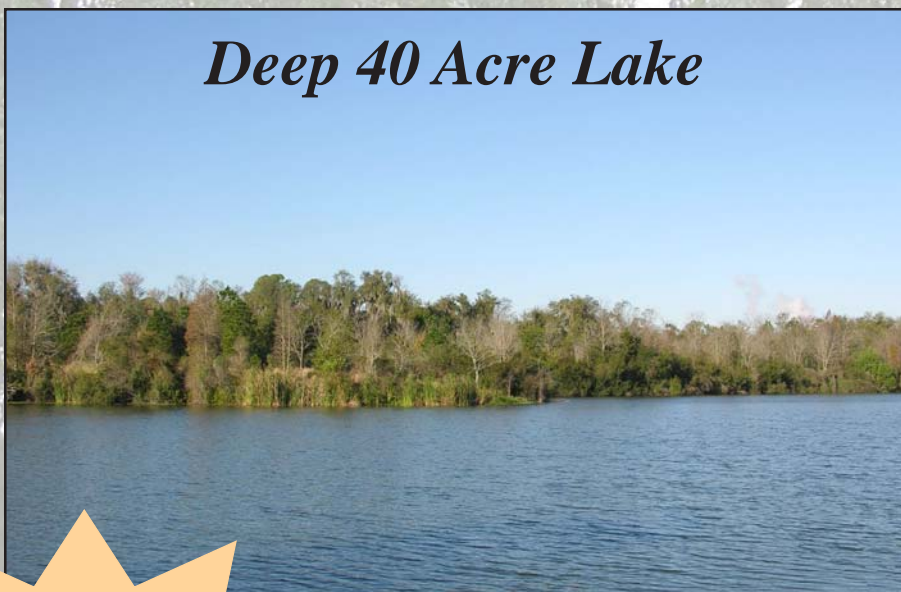

***Beautiful lake on property with***  
***development opportunity!***



***Beautiful private***  
***setting...must see***  
***to appreciate!***



***Proposed***  
***3-way***  
***Split***

### Directions:

- Head west on CR 630 from Ft. Meade
- Continue to New Hope Road
- Go south on New Hope Road to Acuff Road
- Property is on the corner of New Hope and Acuff Roads

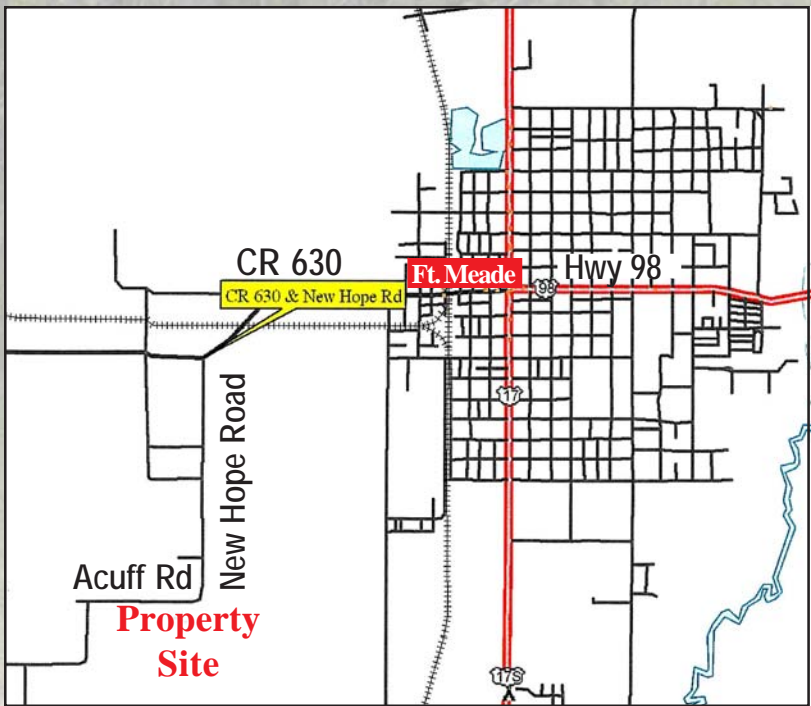

***Located***  
***near the***  
***intersection***  
***of***  
***CR 630 and***  
***New Hope***  
***Road***

