

SURVEY NOTES

1. ALL BEARINGS ARE BASED ON THE LINE AS REFERENCED ON THIS PLAT AND DESCRIBED IN SLIDE NO. 80, COLORADO COUNTY PLAT RECORDS.
2. THIS PROPERTY IS SHOWN TO BE INSIDE (ZONE X) OF THE FLOOD HAZARD BOUNDARY AREA AS SHOWN ON FEMA FIRM MAP NO. 48089C0225 C, EFFECTIVE DATE OF JANUARY 3, 1990.
3. PROPERTY IS SUBJECT TO THOSE RESTRICTIONS, EASEMENTS, ETC., WHICH APPEAR OF RECORD AND DESCRIBED IN SLIDE NO. 80, COLORADO COUNTY PLAT RECORDS AND IN VOLUME 256, PAGE 773, COLORADO COUNTY OFFICIAL RECORDS.
4. APPARENT VISIBLE EASEMENTS HAVE BEEN SHOWN.
5. FIELD NOTES TO ACCOMPANY THIS PLAT.

SURVEY PLAT

OF A SURVEY OF LOT 5, CONTAINING 15.149 ACRES OUT OF SECTION 8 IN OAKRIDGE RANCH SUBDIVISION, COLORADO COUNTY, TEXAS AS PER PLAT RECORDED IN SLIDE NO. 80, OF THE PLAT RECORDS OF COLORADO COUNTY, TEXAS. SAID LOT 5 BEING ALSO THAT SAME PROPERTY DESCRIBED IN A DEED TO JONATHAN W. & MINDY LYNN WROBLISKI, RECORDED IN VOLUME 453, PAGE 724, OF THE OFFICIAL RECORDS OF COLORADO COUNTY, TEXAS.

I, LEONARD W. FRANK, DO HEREBY CERTIFY THAT THIS SURVEY WAS THIS DAY MADE ON THE GROUND, UNDER MY SUPERVISION AND IS TRUE AND CORRECT TO THE BEST OF MY KNOWLEDGE. THIS SURVEY SUBSTANTIALLY COMPLIES WITH THE CURRENT TEXAS SOCIETY OF PROFESSIONAL SURVEYORS STANDARDS AND SPECIFICATIONS FOR A CATEGORY 1A, CONDITION IV SURVEY.

FOR FRANK SURVEYING CO., INC.
BY: LEONARD W. FRANK, RPLS
REGISTRATION NO. 1669
COLORADO COUNTY SURVEYOR

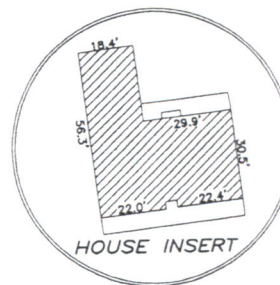

PROPERTY ADDRESS
1076 W. BRANDING IRON
WEIMAR, TEXAS 78962
PROPERTY OWNER
LYNN & JONATHAN WROBLISKI

100 0 100 200 300 400 500 600
SCALE: 1" = 200 FEET

BOUNDARY SURVEY OF LOT 5 OAKRIDGE RANCH - SECTION 8 COLORADO COUNTY, TEXAS

2205 WALNUT STREET
COLUMBUS, TX 78934
979.732.3114

FRANK SURVEYING
COMPANY

COPYRIGHT 2005
ALL RIGHTS RESERVED

DRAWN BY: B HARTLESS

REV:

SCALE: 1" = 200'

PROJECT NO: 05-266

SHEET 1 OF 1

FIELD CREW: PEP/NH

CHECKED BY: MWL COMPUTATION: MWL