

Soils Map

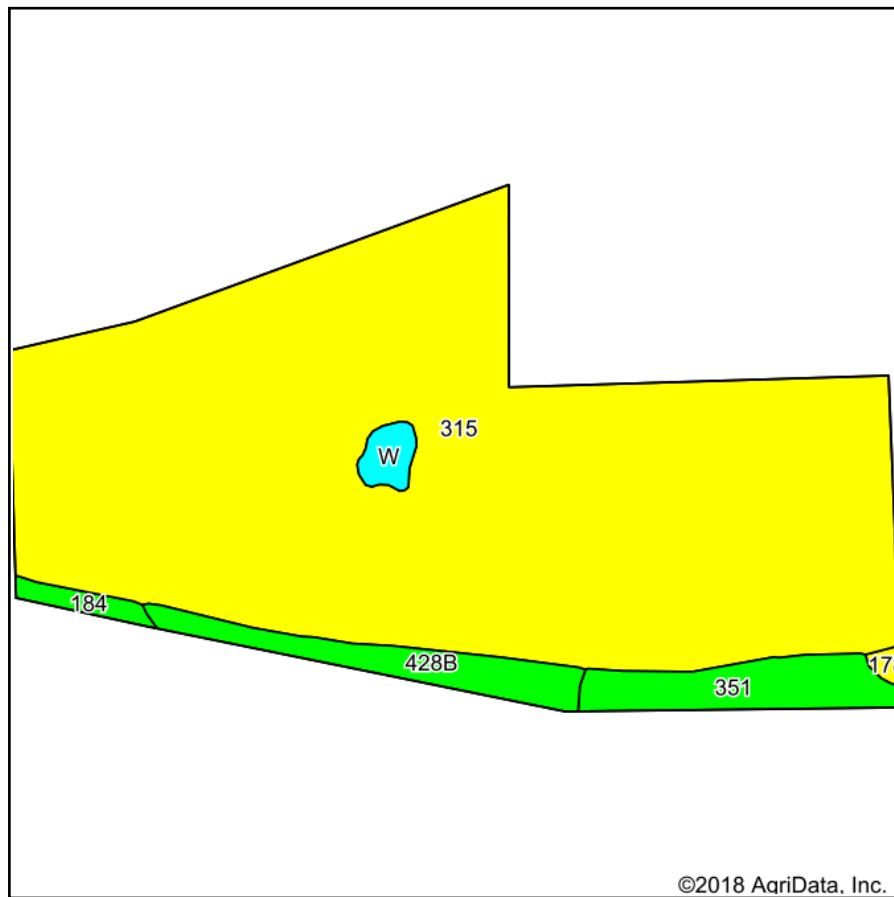

Soils data provided by USDA and NRCS.

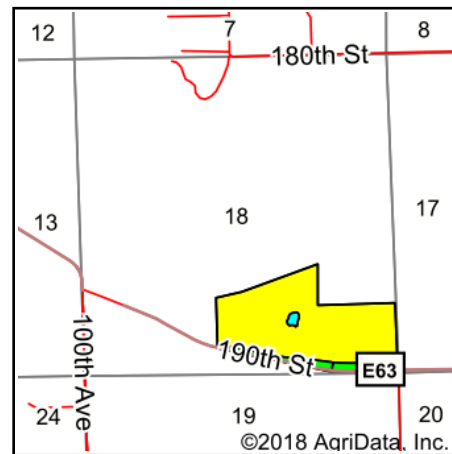

State: **Iowa**
 County: **Clinton**
 Location: **18-82N-1E**
 Township: **Liberty**
 Acres: **83**
 Date: **3/19/2018**

PEOPLES™
 COMPANY
 INNOVATIVE. REAL ESTATE. SOLUTIONS.

Maps Provided By:

surety®
 CUSTOMIZED ONLINE MAPPING
 © AgriData, Inc. 2018 www.AgriDataInc.com



Area Symbol: IA045, Soil Area Version: 23

Code	Soil Description	Acres	Percent of field	CSR2 Legend	Non-Irr Class *c	*i Corn	*i Alfalfa	*i Soybeans	*i Bluegrass	*i Tall Grasses	CSR2**	CSR	NCCPI Overall	NCCPI Corn and Soybeans	NCCPI Small Grains
315	Fluvents-Ambraw complex, 0 to 2 percent slopes	74.02	89.2%		Illw	80	0	23.2	1.4	2.4	59	5	67	63	28
351	Atterberry silt loam, sandy substratum, 0 to 2 percent slopes	3.75	4.5%		lw	224	5.8	65	4	6.7	78	73	98	92	33
428B	Ely silt loam, 2 to 5 percent slopes	3.44	4.1%		lle	220.8	5.7	64	4	6.6	87	88	97	97	66
W	Water	0.79	1.0%			0	0	0	0	0	0	0		0	0
184	Klinger silt loam, 1 to 4 percent slopes	0.75	0.9%		lw	240	6.2	69.6	4.3	7.2	95	95	88	88	30
178	Waukee loam, 0 to 2 percent slopes	0.25	0.3%		lls	80	2.2	23.2	1.4	2.4	69	81	83	83	63
Weighted Average						93	0.6	27	1.6	2.8	60.8	12.5	69.2	65.4	29.7

**IA has updated the CSR values for each county to CSR2.

*i Yield data provided by the ISPAID Database version 8.1.1 developed by IA State University.

*c: Using Capabilities Class Dominant Condition Aggregation Method

Soils data provided by USDA and NRCS.