

# Tillable Soils Map

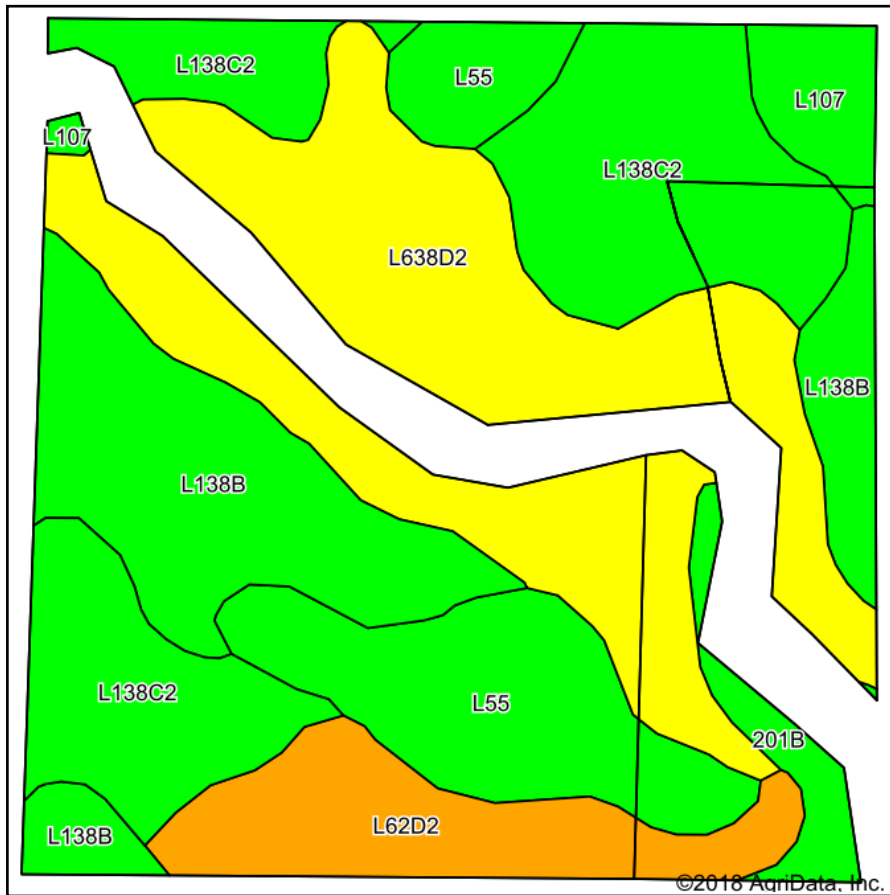

Soils data provided by USDA and NRCS.

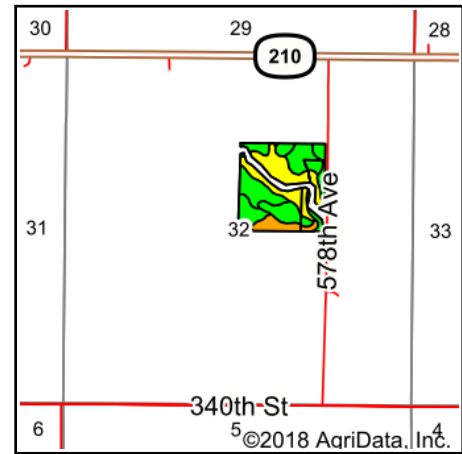

State: **Iowa**  
 County: **Story**  
 Location: **32-82N-23W**  
 Township: **Union**  
 Acres: **35.6**  
 Date: **3/21/2018**

**PEOPLES**™  
 COMPANY  
 INNOVATIVE. REAL ESTATE. SOLUTIONS.

Maps Provided By:

**surety**®  
 CUSTOMIZED ONLINE MAPPING  
 © AgriData, Inc. 2018 www.AgriDataInc.com



Area Symbol: IA169, Soil Area Version: 28

| Code             | Soil Description  | Acres | Percent of field | CSR2 Legend | Non-Irr Class *c | CSR2** | CSR | NCCPI Overall |
|------------------|---|-------|------------------|-------------|------------------|--------|-----|---------------|
| L638D2           | Omsrud-Storden complex, Bemis moraine, 10 to 16 percent slopes, moderately eroded | 10.82 | 30.4%            |             | IVe              | 53     |     | 62            |
| L138C2           | Clarion loam, Bemis moraine, 6 to 10 percent slopes, moderately eroded            | 8.38  | 23.5%            |             | IIIe             | 83     |     | 61            |
| L138B            | Clarion loam, Bemis moraine, 2 to 6 percent slopes                                | 6.42  | 18.0%            |             | Ile              | 88     |     | 77            |
| L55              | Nicollet loam, 1 to 3 percent slopes  | 4.82  | 13.5%            |             | Ie               | 91     |     | 82            |
| L62D2            | Storden loam, Bemis moraine, 10 to 16 percent slopes, moderately eroded           | 3.20  | 9.0%             |             | IVe              | 41     |     | 60            |
| L107             | Webster clay loam, Bemis moraine, 0 to 2 percent slopes                           | 1.08  | 3.0%             |             | IIw              | 88     |     | 80            |
| 201B             | Coland-Terril complex, 1 to 5 percent slopes                                      | 0.88  | 2.5%             |             | IIw              | 76     | 40  | 91            |
| Weighted Average |   |       |                  |             |                  | 72.1   | *-  | 68.3          |

\*\*IA has updated the CSR values for each county to CSR2.

\*- CSR weighted average cannot be calculated on the current soils data, use prior data version for csr values.

\*c: Using Capabilities Class Dominant Condition Aggregation Method

Soils data provided by USDA and NRCS.