

<b>State of Alaska</b> <b>Department of Environmental Conservation</b>  <b>DOCUMENTATION OF CONSTRUCTION</b>	226217 DATE RECEIVED DEC 27 2017 State Of Alaska DEC Wasilla Alaska 99654	ADEC USE ONLY

<b>Legal Description &amp; Physical Address</b>	Lot 6 Block 3 Sherwood Estates	
	Robin Hood Lane	Tax ID # (optional)
<b>Submitted by:</b>	<input checked="" type="checkbox"/> Registered Engineer <input type="checkbox"/> Certified Installer <input type="checkbox"/> Approved Homeowner	<b>Installer Mailing Address &amp; Phone Number:</b> Fischer Brothers; 501 Hallea Lane, Wasilla AK 99654

### Part I – General Information

### Part II – Wastewater Disposal

<b>Onsite Wastewater System serves:</b>	<input checked="" type="checkbox"/> <b>Single Family</b> – Number of bedrooms <u>2</u> <input type="checkbox"/> <b>Duplex</b> – Total number of bedrooms _____ <input type="checkbox"/> <b>Small Commercial Facility</b> (with estimated design flow of less than 500 gpd)		<b>Type of well on property:</b> <input type="checkbox"/> Class A <input type="checkbox"/> Class C <input type="checkbox"/> Class B <input checked="" type="checkbox"/> Private	
	<b>System Installed by:</b> <input type="checkbox"/> Certified Installer – CI #: _____ <input type="checkbox"/> Registered Engineer <input checked="" type="checkbox"/> Inspection by a Registered Engineer <input type="checkbox"/> Approved Homeowner (attach approval letter)		<input checked="" type="checkbox"/> <b>NEW SYSTEM</b> <input type="checkbox"/> <b>REPAIR EXISTING SYSTEM</b> <b>Installation Notification Date:</b> na <b>Date Installed:</b> 10-14-16	
<b>Septic Tank</b>	Size: 1,000	# of compartments: 2	Manufacturer: Anchorage Tank	
<b>Type of Soil Absorption System</b>	<input checked="" type="checkbox"/> Deep Trench <input type="checkbox"/> Shallow Trench	<input type="checkbox"/> Bed <input type="checkbox"/> Seepage Pit	<input type="checkbox"/> Mound (by engineer only) <input type="checkbox"/> Other (specify)	
<b>Soils</b>	Classification: GP/SP	Rating (sq ft/bdrm): 150		
<b>Perc Test Results</b>	Minutes per inch <u>na</u> Performed by:	Sq. ft. per bedroom _____	(Attach results by sealed/signed registered engineer)	
<b>Dimensions</b>	Size of absorption area: 22x7ED		Quantity of rock: 20 yds	
	Thickness/depth of distribution rock: 7ED		Size of rock: 3 - 3/4	
<b>Ground Cover over (ft)</b>	Septic Tank: 4	Absorption Area: 4	Sewer Pipes: 4	
<b>Cleanout Pipes/Caps</b>	Foundation Cleanout: yes	Septic Tank: yes	Monitor Tubes: yes	
<b>Separation Distances</b>	<b>From septic tank or absorption area, whichever is closest, to all nearby:</b> Private drinking water sources within 100': 100+      Nearest water bodies (see 18 AAC 72.020(b)): 100+ Public drinking water sources within 200': 200+      Lot line: survey needed			
	<b>From on-lot sewer lines to drinking water sources:</b>		Public: none	Private: 25+
	<b>From bottom of distribution rock to:</b>		Groundwater Table: 4+	Bedrock: 6+
	<b>From absorption area to slope exceeding 25%: none</b>			
<b>Comments/Recommendations:</b>				
I certify that the above information, and that provided in Section III, is correct:				
<b>Signature:</b>	<b>Printed Name:</b> Archie Giddings			
<b>Title, Reg/Cert #, Inst #:</b> CE 8483	<b>Date:</b> 11/15/16			
NOTE: Must be signed by a Certified Installer, DEC staff or Approved Homeowner. If engineering seal bears printed name, registration number and is signed, these blocks need not be completed for engineered submittals.				

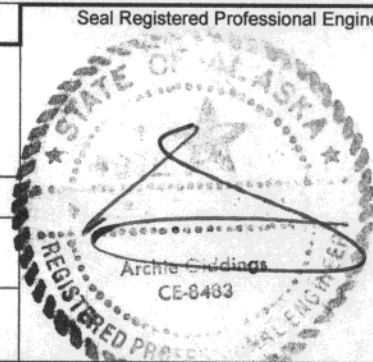

## Part III - Required Diagram of System(s)

1. In a plan view, locate and identify each of the following:

- |                                                |                                                             |                  |                                                |
|------------------------------------------------|-------------------------------------------------------------|------------------|------------------------------------------------|
| a) Well                                        | b) All Structures                                           | c) Septic Tank   | d) Soil Absorption system (include dimensions) |
| e) Surface Water                               | f) Sources of Contamination                                 | g) Property Line | h) Closest well on adjacent property           |
| i) Closest septic tank on an adjacent property | j) Closest edge of an absorption field on adjacent property |                  |                                                |
| k) All Cleanouts and monitor tubes             | l) Testhole location                                        |                  |                                                |

2. Show distances between the well and each of the sources of contamination listed in 1.

3. Show distances between water bodies and each part of the onsite system listed in 1.

4. In a cross section view of the soil absorption area, identify each component and show the depth (thickness) of the following:

- |               |                        |                |            |                    |               |
|---------------|------------------------|----------------|------------|--------------------|---------------|
| a) Soil Cover | b) Absorption Material | c) Water Table | d) Bedrock | e) Discharge Pipes | f) Insulation |
|---------------|------------------------|----------------|------------|--------------------|---------------|

Testhole total depth: 17 ft. Groundwater/Seeps encountered? Y/N at na ft.

Impermeable soil (Silt/Clay/Bedrock) encountered? Y/N at na ft.

### Plan View

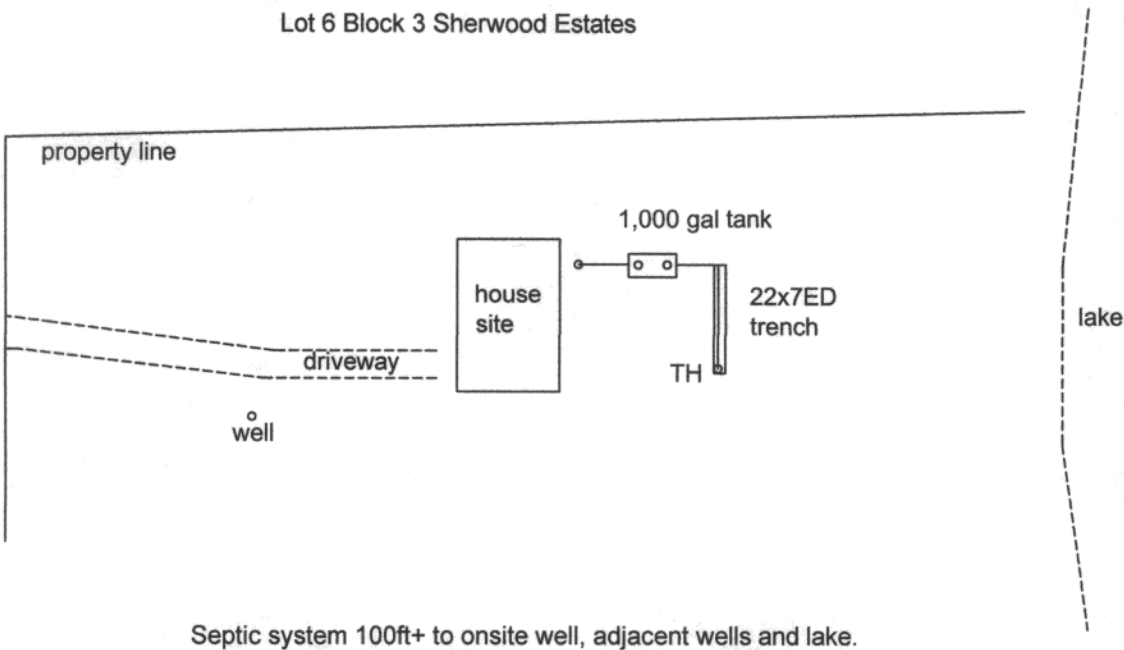

Date 10-14-16

Inspected By  
AG

1ft	Topsoil
2ft	SP/GP
3ft	
4ft	
5ft	
6ft	
7ft	
8ft	
9ft	
10ft	
11ft	
12ft	
13ft	
14ft	
15ft	
16ft	
17ft	
18ft	
19ft	
20ft	
21ft	

### Cross Section

