



TEXAS ASSOCIATION OF REALTORS®
UPDATE TO SELLER'S DISCLOSURE NOTICE

USE OF THIS FORM BY PERSONS WHO ARE NOT MEMBERS OF THE TEXAS ASSOCIATION OF REALTORS® IS NOT AUTHORIZED.
©Texas Association of REALTORS®, Inc. 2018

**UPDATE TO THE SELLER'S DISCLOSURE NOTICE CONCERNING THE PROPERTY AT 3536 Burke Rd
Barn House, Flatonia, TX 78941-5173**

Seller is aware of the following new information regarding the condition of the Property. Section(s) 2 and 10
are changed to read (cite specific sections and copy the applicable language in the sections verbatim, making
any necessary changes): **SECTION 2-Foundation Repair Plan 3536 Burke Rd. Flatonia, TX 78941,**
SLABJACKERS LLC 489 Agnes St Suit 112 Bastrop, TX 78602 512-906-0078

SECTION 10.

Yes I have received Insurance claim Hermann Harvey
main house + Barnhouse, 2017

Yes I have received Insurance claim July 2018
in Barnhouse.

This Update to the Seller's Disclosure Notice was completed by Seller as of the date signed. No person, including the broker(s), has instructed or influenced Seller to provide inaccurate information or to omit any material information. The brokers have relied on this information as true and correct and have no reason to believe it to be false or inaccurate.

Seller acknowledges that the statements in this form are true
to the best of Seller's belief.

Buyer acknowledges receipt of this form.

Signature of Seller

Date

7/25/18

Printed Name: **Gilbert Flores, Jr.**

Signature of Buyer

Date

Printed Name: _____

Signature of Seller

Date

Printed Name: _____

Signature of Buyer

Date

Printed Name: _____

(TAR 1418) 02-01-18

Page 1 of 1



Foundation Repair Plan
3536 Burke Rd.
Flatonia, TX 78941

SLABJACKERS LLC
489 Agnes St Suit 112
Bastrop, TX 78602
512-906-0078

Site Drawing

G

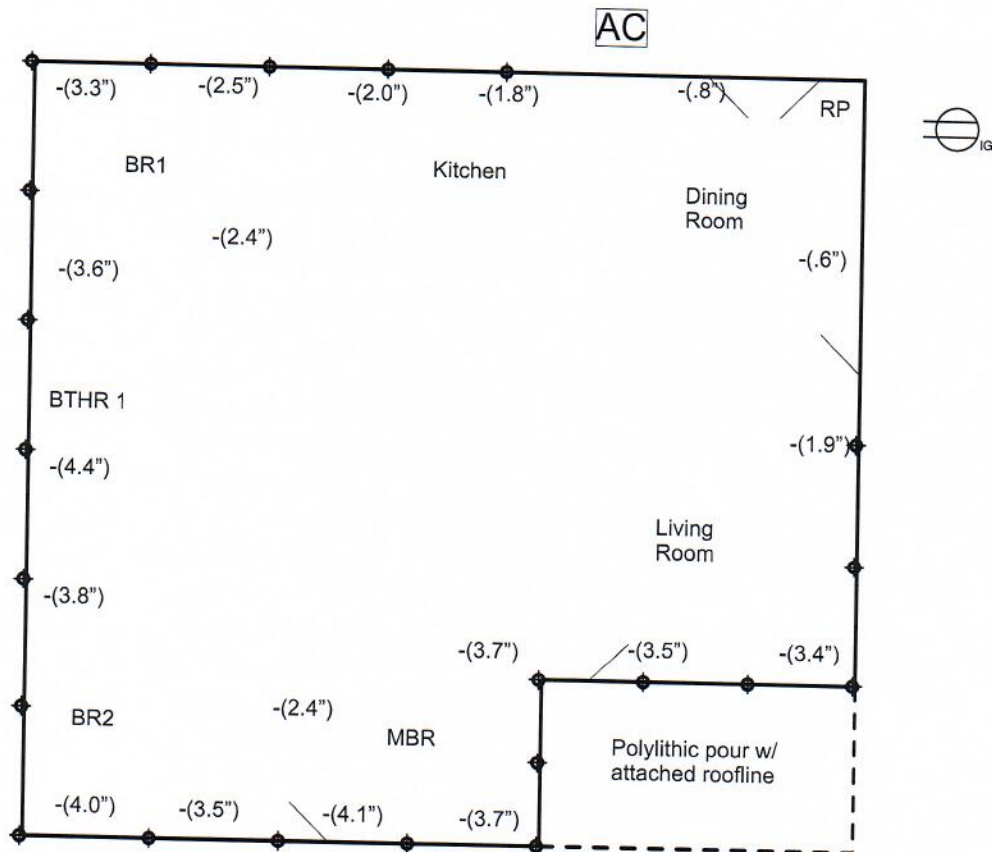

Front of Structure
Slab on grade
single story
residential structure

Prepared by

10 Feet
Created by GraphPad



SLABJACKERS LLC
489 Agnes St Suit 112
Bastrop, TX 78602
512-906-0078

Agreement

This Independent Contractor Agreement ("Agreement") is entered into this _____ day of _____ ("Effective Date") by and between SLABJACKERS LLC and its successors and assigns ("Contractor"), with notice address of 489 Agnes St Suit 112 and Gina ("Owner") with notice address of _____.

WHEREAS, Owner and Contractor agree the Contractor will perform construction work, labor and provide relate equipment and services for Owner at the property located at _____ ("Property");
NOW THEREFORE, the parties hereby agree as follows:

- Contractor's work.** Contractor shall conduct work more fully described and indicated on the Site Drawing attached hereto and made a part hereof. All Contractors' Work will be done in accordance with local and government standards.
- Consideration.** In consideration of the Contractor's Work to be performed by Contractor under this Agreement the Owner will pay Contractor the total cost of \$ 13530.00 ("Total Payment"), of which \$ _____ is due upon the Effective Date ("Initial Payment") and \$ _____ is due upon completion of Contractor's Work ("Completion Payment") (collectively "Payments").
- Personal Property and Damage.** Contractor shall not be liable for any damage to Owner's personal property during the performance of Contractor's Work. If Owner wishes to avoid such damage, Owner must remove all personal property from the area where Contractor will perform Contractor's Work. Contractor shall not be liable for any such damage unless caused by Contractor's gross negligence and/or intentional misconduct.
- Default.** The occurrence of any one or more of the following shall constitute a default of the Agreement by Owner: (i) the failure to make any Payment under Section 2 of this Agreement, or any other payment required to be made by Owner hereunder, and; (ii) failure to meet any of the obligations and/or conditions set forth in this agreement.
- Remedies.** In the event of such uncured default, Contractor may pursue any of the following remedies; (i) terminate this Agreement, (ii) recover actual damages, and (iii) pursue any other remedy available at law or equity.
- Mechanics' liens.** Contractor shall have the right to file a mechanics' lien on the Property due any Owner failure to perform under this Agreement.
- Disputes.** Except for the collection of amounts owed by Owner to Contractor, any other dispute, controversy or lawsuit between the parties to this Agreement shall be resolved by mandatory and binding arbitration administered by the American Arbitration Association ("AAA").
- Attorneys' Fees.** If Contractor brings an action or proceeding to enforce the terms hereof or declare rights hereunder, and prevails in such action, proceeding, trial or appeal, Contractor shall be entitled to its reasonable attorneys' fees to be paid by Owner as fixed by the court.
- Waiver.** Failure to invoke any right, condition, or covenant in this Agreement by either party shall not be deemed to imply or constitute a waiver of any rights, condition, or covenant and neither party may rely on such failure.
- Notice.** Any notice or communication permitted or required by this Agreement shall be deemed delivered upon personal delivery or upon receipt, postage prepaid, in the first class mail of the United States or by a pre-paid nationally recognized overnight courier service properly addressed to the appropriate party at the address set forth above.
- Entire Agreement.** This Agreement constitutes the entire agreement of the parties with regard to the subject matter hereof, and replaces and supersedes all other agreements or understandings, whether written or oral. No amendment or extension of this Agreement shall be binding unless in writing and signed by both parties.
- Governing Law/Severability.** This Agreement shall be governed by the laws of the state where the Property is located. The invalidity or unenforceability of any provision of this Agreement shall not affect the validity or enforceability of any other provision.

NOTICE TO OWNER

FAILURE OF THIS OWNER TO PAY THOSE PERSONS SUPPLYING MAERIAL OR SERVICES TO COMPLETE THIS AGREEMENT CAN RESULT IN THE FILING OF A MECHANICS' LIEN ON THE PROPERTY WHICH IS THE SUBJECT OF THIS AGREEMENT. TO AVOID THIS RESULT, YOU MAY ASK THIS CONTRACTOR FOR "LIEN WAIVERS" FROM ALL PERSONS SUPPLYING MATERIAL OR SERVICES FOR THE WORK DESCRIBED IN THIS AGREEMENT. FAILURE TO SECURE LIEN WAIVERS MAY RESULT IN YOUR PAYING FOR LABOR AND MATERIAL TWICE.

WHEREFORE, the parties have executed this Agreement as of the Effective Date.

Contractor

Owner Gina

By: _____

By: _____



TEXAS ASSOCIATION OF REALTORS® SELLER'S DISCLOSURE NOTICE

©Texas Association of REALTORS®, Inc. 2018

Section 5.008, Property Code requires a seller of residential property of not more than one dwelling unit to deliver a Seller's Disclosure Notice to a buyer on or before the effective date of a contract. **This form complies with and contains additional disclosures which exceed the minimum disclosures required by the Code.**

CONCERNING THE PROPERTY AT _____

**3536 Burke Rd Main House
Flatonia, TX 78941-5173**

THIS NOTICE IS A DISCLOSURE OF SELLER'S KNOWLEDGE OF THE CONDITION OF THE PROPERTY AS OF THE DATE SIGNED BY SELLER AND IS NOT A SUBSTITUTE FOR ANY INSPECTIONS OR WARRANTIES THE BUYER MAY WISH TO OBTAIN. IT IS NOT A WARRANTY OF ANY KIND BY SELLER, SELLER'S AGENTS, OR ANY OTHER AGENT.

Seller ✓ is is not occupying the Property. If unoccupied (by Seller), how long since Seller has occupied the Property? _____ (approximate date) or never occupied the Property

Section 1. The Property has the items marked below: (Mark Yes (Y), No (N), or Unknown (U).)

This notice does not establish the items to be conveyed. The contract will determine which items will & will not convey.

Item	Y	N	U
Cable TV Wiring			
Carbon Monoxide Det.		✓	
Ceiling Fans	✓		
Cooktop	✓		
Dishwasher	✓		
Disposal	✓		
Emergency Escape Ladder(s)			
Exhaust Fans			✓
Fences	✓		
Fire Detection Equip.	✓		
French Drain	✓		
Gas Fixtures	✓		
Natural Gas Lines			✓

Item	Y	N	U
Liquid Propane Gas:			✓
-LP Community (Captive)			✓
-LP on Property			✓
Hot Tub		✓	
Intercom System		✓	
Microwave	✓		
Outdoor Grill		✓	
Patio/Decking	✓		
Plumbing System	✓		
Pool			✓
Pool Equipment			✓
Pool Maint. Accessories			✓
Pool Heater		✓	

Item	Y	N	U
Pump: sump grinder	✓		
Rain Gutters			✓
Range/Stove	✓		
Roof/Attic Vents			✓
Sauna		✓	
Smoke Detector	✓		
Smoke Detector - Hearing Impaired		✓	
Spa		✓	
Trash Compactor			✓
TV Antenna			✓
Washer/Dryer Hookup	✓		
Window Screens	✓		
Public Sewer System			✓

Item	Y	N	U	Additional Information
Central A/C	✓			electric gas number of units: <u> </u>
Evaporative Coolers				number of units: <u> </u>
Wall/Window AC Units				number of units: <u> </u>
Attic Fan(s)				if yes, describe: <u> </u>
Central Heat	✓			electric gas number of units: <u> </u>
Other Heat				if yes, describe: <u> </u>
Oven	✓			number of ovens: <u> </u> electric gas other: <u> </u>
Fireplace & Chimney		✓		wood gas logs mock other: <u> </u>
Carport		✓		attached not attached
Garage		✓		attached not attached
Garage Door Openers		✓		number of units: <u> </u> number of remotes: <u> </u>
Satellite Dish & Controls	✓			owned leased from: <u> </u>
Security System		✓		owned leased from: <u> </u>
Solar Panels		✓		owned leased from: <u> </u>
Water Heater	✓			electric gas other: <u> </u> number of units: <u> </u>
Water Softener		✓		owned leased from: <u> </u>
Other Leased Items(s)				if yes, describe: <u> </u>

(TAR-1406) 02-01-18

Holub Real Estate, 1439 Hanz Dr Suite 100 New Braunfels, TX 78130
Bernadine Kainer

Initialed by: Buyer: _____ and Seller:

Produced with zipForm® by zipLogix 18070 Fifteen Mile Road, Fraser, Michigan 48026 www.zipLogix.com

Phone: 3617725105

Fax: 8302146603

Page 1 of 5
3536 Burke Rd,

Concerning the Property at _____

**3536 Burke Rd Main House
Flatonia, TX 78941-5173**

Underground Lawn Sprinkler	<input checked="" type="checkbox"/>	<input type="checkbox"/>	<input type="checkbox"/>	automatic	manual	areas covered:
Septic / On-Site Sewer Facility	<input checked="" type="checkbox"/>	<input type="checkbox"/>	<input type="checkbox"/>	if yes, attach Information About On-Site Sewer Facility (TAR-1407)		

Water supply provided by: ☐ city ☐ well ☐ MUD ☐ co-op ☐ unknown ☐ other: _____

Was the Property built before 1978? ☐ yes ☒ no ☐ unknown

(If yes, complete, sign, and attach TAR-1906 concerning lead-based paint hazards).

Roof Type: Asphalt Age: 10 yrs (approximate)

Is there an overlay roof covering on the Property (shingles or roof covering placed over existing shingles or roof covering)? ☐ yes ☒ no ☐ unknown

Are you (Seller) aware of any of the items listed in this Section 1 that are not in working condition, that have defects, or are need of repair? ☐ yes ☒ no If yes, describe (attach additional sheets if necessary): _____

Section 2. Are you (Seller) aware of any defects or malfunctions in any of the following?: (Mark Yes (Y) if you are aware and No (N) if you are not aware.)

Item	Y	N
Basement	<input type="checkbox"/>	<input checked="" type="checkbox"/>
Ceilings	<input type="checkbox"/>	<input checked="" type="checkbox"/>
Doors	<input type="checkbox"/>	<input checked="" type="checkbox"/>
Driveways	<input type="checkbox"/>	<input checked="" type="checkbox"/>
Electrical Systems	<input type="checkbox"/>	<input checked="" type="checkbox"/>
Exterior Walls	<input type="checkbox"/>	<input checked="" type="checkbox"/>

Item	Y	N
Floors	<input type="checkbox"/>	<input checked="" type="checkbox"/>
Foundation / Slab(s)	<input type="checkbox"/>	<input checked="" type="checkbox"/>
Interior Walls	<input type="checkbox"/>	<input checked="" type="checkbox"/>
Lighting Fixtures	<input type="checkbox"/>	<input checked="" type="checkbox"/>
Plumbing Systems	<input type="checkbox"/>	<input checked="" type="checkbox"/>
Roof	<input type="checkbox"/>	<input checked="" type="checkbox"/>

Item	Y	N
Sidewalks	<input type="checkbox"/>	<input checked="" type="checkbox"/>
Walls / Fences	<input type="checkbox"/>	<input checked="" type="checkbox"/>
Windows	<input type="checkbox"/>	<input checked="" type="checkbox"/>
Other Structural Components	<input type="checkbox"/>	<input checked="" type="checkbox"/>

If the answer to any of the items in Section 2 is yes, explain (attach additional sheets if necessary): Structures needs repair in main house

Section 3. Are you (Seller) aware of any of the following conditions: (Mark Yes (Y) if you are aware and No (N) if you are not aware.)

Condition	Y	N
Aluminum Wiring	<input type="checkbox"/>	<input checked="" type="checkbox"/>
Asbestos Components	<input type="checkbox"/>	<input checked="" type="checkbox"/>
Diseased Trees: <u>oak wilt</u>	<input type="checkbox"/>	<input checked="" type="checkbox"/>
Endangered Species/Habitat on Property	<input type="checkbox"/>	<input checked="" type="checkbox"/>
Fault Lines	<input type="checkbox"/>	<input checked="" type="checkbox"/>
Hazardous or Toxic Waste	<input type="checkbox"/>	<input checked="" type="checkbox"/>
Improper Drainage	<input type="checkbox"/>	<input checked="" type="checkbox"/>
Intermittent or Weather Springs	<input type="checkbox"/>	<input checked="" type="checkbox"/>
Landfill	<input type="checkbox"/>	<input checked="" type="checkbox"/>
Lead-Based Paint or Lead-Based Pt. Hazards	<input type="checkbox"/>	<input checked="" type="checkbox"/>
Encroachments onto the Property	<input type="checkbox"/>	<input checked="" type="checkbox"/>
Improvements encroaching on others' property	<input type="checkbox"/>	<input checked="" type="checkbox"/>
Located in 100-year Floodplain	<input type="checkbox"/>	<input checked="" type="checkbox"/>
(If yes, attach TAR-1414)	<input type="checkbox"/>	<input checked="" type="checkbox"/>
Located in Floodway (If yes, attach TAR-1414)	<input type="checkbox"/>	<input checked="" type="checkbox"/>
Present Flood Ins. Coverage	<input type="checkbox"/>	<input checked="" type="checkbox"/>
(If yes, attach TAR-1414)	<input type="checkbox"/>	<input checked="" type="checkbox"/>
Previous Flooding into the Structures	<input type="checkbox"/>	<input checked="" type="checkbox"/>
Previous Flooding onto the Property	<input type="checkbox"/>	<input checked="" type="checkbox"/>
Located in Historic District	<input type="checkbox"/>	<input checked="" type="checkbox"/>

Condition	Y	N
Previous Foundation Repairs	<input type="checkbox"/>	<input checked="" type="checkbox"/>
Previous Roof Repairs	<input type="checkbox"/>	<input checked="" type="checkbox"/>
Previous Other Structural Repairs	<input type="checkbox"/>	<input checked="" type="checkbox"/>
Radon Gas	<input type="checkbox"/>	<input checked="" type="checkbox"/>
Settling	<input type="checkbox"/>	<input checked="" type="checkbox"/>
Soil Movement	<input type="checkbox"/>	<input checked="" type="checkbox"/>
Subsurface Structure or Pits	<input type="checkbox"/>	<input checked="" type="checkbox"/>
Underground Storage Tanks	<input type="checkbox"/>	<input checked="" type="checkbox"/>
Unplatted Easements	<input type="checkbox"/>	<input checked="" type="checkbox"/>
Unrecorded Easements	<input type="checkbox"/>	<input checked="" type="checkbox"/>
Urea-formaldehyde Insulation	<input type="checkbox"/>	<input checked="" type="checkbox"/>
Water Penetration	<input type="checkbox"/>	<input checked="" type="checkbox"/>
Wetlands on Property	<input type="checkbox"/>	<input checked="" type="checkbox"/>
Wood Rot	<input type="checkbox"/>	<input checked="" type="checkbox"/>
Active infestation of termites or other wood destroying insects (WDI)	<input type="checkbox"/>	<input checked="" type="checkbox"/>
Previous treatment for termites or WDI	<input type="checkbox"/>	<input checked="" type="checkbox"/>
Previous termite or WDI damage repaired	<input type="checkbox"/>	<input checked="" type="checkbox"/>
Previous Fires	<input type="checkbox"/>	<input checked="" type="checkbox"/>

(TAR-1406) 02-01-18

Initialed by: Buyer: _____, _____ and Seller: [Signature]

Concerning the Property at _____

**3536 Burke Rd Main House
Flatonia, TX 78941-5173**

Historic Property Designation	<input checked="" type="checkbox"/>
Previous Use of Premises for Manufacture of Methamphetamine	<input checked="" type="checkbox"/>
Termite or WDI damage needing repair	<input checked="" type="checkbox"/>
Single Blockable Main Drain in Pool/Hot Tub/Spa*	<input checked="" type="checkbox"/>

If the answer to any of the items in Section 3 is yes, explain (attach additional sheets if necessary): _____

*A single blockable main drain may cause a suction entrapment hazard for an individual.

Section 4. Are you (Seller) aware of any item, equipment, or system in or on the Property that is in need of repair, which has not been previously disclosed in this notice? ☒ yes ☒ no If yes, explain (attach additional sheets if necessary): _____

Section 5. Are you (Seller) aware of any of the following (Mark Yes (Y) if you are aware. Mark No (N) if you are not aware.)

Y N

☒ Room additions, structural modifications, or other alterations or repairs made without necessary permits, with unresolved permits, or not in compliance with building codes in effect at the time.

☒ Homeowners' associations or maintenance fees or assessments. If yes, complete the following:

Name of association: _____

Manager's name: _____

Phone: _____

Fees or assessments are: \$ _____ per _____ and are: ☒ mandatory ☒ voluntary

Any unpaid fees or assessment for the Property? ☒ yes (\$ _____) ☒ no

If the Property is in more than one association, provide information about the other associations below or attach information to this notice.

☒ Any common area (facilities such as pools, tennis courts, walkways, or other) co-owned in undivided interest with others. If yes, complete the following:

Any optional user fees for common facilities charged? ☒ yes ☒ no If yes, describe: _____

☒ Any notices of violations of deed restrictions or governmental ordinances affecting the condition or use of the Property.

☒ Any lawsuits or other legal proceedings directly or indirectly affecting the Property. (Includes, but is not limited to: divorce, foreclosure, heirship, bankruptcy, and taxes.)

☒ Any death on the Property except for those deaths caused by: natural causes, suicide, or accident unrelated to the condition of the Property.

☒ Any condition on the Property which materially affects the health or safety of an individual.

☒ Any repairs or treatments, other than routine maintenance, made to the Property to remediate environmental hazards such as asbestos, radon, lead-based paint, urea-formaldehyde, or mold.

If yes, attach any certificates or other documentation identifying the extent of the remediation (for example, certificate of mold remediation or other remediation).

☒ Any rainwater harvesting system located on the Property that is larger than 500 gallons and that uses a public water supply as an auxiliary water source.

☒ The Property is located in a propane gas system service area owned by a propane distribution system retailer.

☒ Any portion of the Property that is located in a groundwater conservation district or a subsidence district.

Concerning the Property at _____

**3536 Burke Rd Main House
Flatonia, TX 78941-5173**

If the answer to any of the items in Section 5 is yes, explain (attach additional sheets if necessary): _____

Section 6. Seller ☒ has ☒ has not attached a survey of the Property.

Section 7. Within the last 4 years, have you (Seller) received any written inspection reports from persons who regularly provide inspections and who are either licensed as inspectors or otherwise permitted by law to perform inspections? ☒ yes ☒ no If yes, attach copies and complete the following:

Inspection Date	Type	Name of Inspector	No. of Pages

Note: A buyer should not rely on the above-cited reports as a reflection of the current condition of the Property. A buyer should obtain inspections from inspectors chosen by the buyer.

Section 8. Check any tax exemption(s) which you (Seller) currently claim for the Property:

☐ Homestead
☐ Wildlife Management
☐ Other: _____

☒ Senior Citizen
☒ Agricultural

☐ Disabled
☐ Disabled Veteran
☐ Unknown

Section 9. Have you (Seller) ever filed a claim for damage to the Property with any insurance provider? ☒ yes ☒ no

Section 10. Have you (Seller) ever received proceeds for a claim for damage to the Property (for example, an insurance claim or a settlement or award in a legal proceeding) and not used the proceeds to make the repairs for which the claim was made? ☒ yes ☒ no If yes, explain: _____

Section 11. Does the Property have working smoke detectors installed in accordance with the smoke detector requirements of Chapter 766 of the Health and Safety Code? ☒ unknown ☐ no ☐ yes. If no or unknown, explain. (Attach additional sheets if necessary): _____

**Chapter 766 of the Health and Safety Code requires one-family or two-family dwellings to have working smoke detectors installed in accordance with the requirements of the building code in effect in the area in which the dwelling is located, including performance, location, and power source requirements. If you do not know the building code requirements in effect in your area, you may check unknown above or contact your local building official for more information.*

A buyer may require a seller to install smoke detectors for the hearing impaired if: (1) the buyer or a member of the buyer's family who will reside in the dwelling is hearing-impaired; (2) the buyer gives the seller written evidence of the hearing impairment from a licensed physician; and (3) within 10 days after the effective date, the buyer makes a written request for the seller to install smoke detectors for the hearing-impaired and specifies the locations for installation. The parties may agree who will bear the cost of installing the smoke detectors and which brand of smoke detectors to install.

Seller acknowledges that the statements in this notice are true to the best of Seller's belief and that no person, including the broker(s), has instructed or influenced Seller to provide inaccurate information or to omit any material information.

Signature of Seller _____

Date

Signature of Seller _____

Date

Printed Name: _____

Printed Name: _____

(TAR-1406) 02-01-18

Initialed by: Buyer: _____

and Seller: _____

Concerning the Property at _____

3536 Burke Rd Main House
Flatonia, TX 78941-5173

ADDITIONAL NOTICES TO BUYER:

- (1) The Texas Department of Public Safety maintains a database that the public may search, at no cost, to determine if registered sex offenders are located in certain zip code areas. To search the database, visit www.txdps.state.tx.us. For information concerning past criminal activity in certain areas or neighborhoods, contact the local police department.
- (2) If the Property is located in a coastal area that is seaward of the Gulf Intracoastal Waterway or within 1,000 feet of the mean high tide bordering the Gulf of Mexico, the Property may be subject to the Open Beaches Act or the Dune Protection Act (Chapter 61 or 63, Natural Resources Code, respectively) and a beachfront construction certificate or dune protection permit may be required for repairs or improvements. Contact the local government with ordinance authority over construction adjacent to public beaches for more information.
- (3) If the Property is located in a seacoast territory of this state designated as a catastrophe area by the Commissioner of the Texas Department of Insurance, the Property may be subject to additional requirements to obtain or continue windstorm and hail insurance. A certificate of compliance may be required for repairs or improvements to the Property. For more information, please review *Information Regarding Windstorm and Hail Insurance for Certain Properties* (TAR 2518) and contact the Texas Department of Insurance or the Texas Windstorm Insurance Association.
- (4) This Property may be located near a military installation and may be affected by high noise or air installation compatible use zones or other operations. Information relating to high noise and compatible use zones is available in the most recent Air Installation Compatible Use Zone Study or Joint Land Use Study prepared for a military installation and may be accessed on the Internet website of the military installation and of the county and any municipality in which the military installation is located.
- (5) If you are basing your offers on square footage, measurements, or boundaries, you should have those items independently measured to verify any reported information.
- (6) The following providers currently provide service to the Property:

Electric: Suzette Electric

Sewer: _____

Water: Suzette Electric

Cable: Direct TV

Trash: _____

Natural Gas: _____

Phone Company: _____

Propane: Lix Propane Schulenburg

Internet: _____

phone #: _____

phone #: _____

phone #: _____

phone #: _____

phone #: _____

phone #: _____

phone #: _____

phone #: _____

phone #: _____

- (7) This Seller's Disclosure Notice was completed by Seller as of the date signed. The brokers have relied on this notice as true and correct and have no reason to believe it to be false or inaccurate. YOU ARE ENCOURAGED TO HAVE AN INSPECTOR OF YOUR CHOICE INSPECT THE PROPERTY.

The undersigned Buyer acknowledges receipt of the foregoing notice.

Signature of Buyer _____

Date _____

Signature of Buyer _____

Date _____

Printed Name: _____

Printed Name: _____

(TAR-1406) 02-01-18

Initialed by: Buyer: _____, _____ and Seller: L, _____

Page 5 of 5



APPROVED BY THE TEXAS REAL ESTATE COMMISSION
**ADDENDUM FOR SELLER'S DISCLOSURE OF INFORMATION
ON LEAD-BASED PAINT AND LEAD-BASED PAINT HAZARDS
AS REQUIRED BY FEDERAL LAW**

10-10-11

CONCERNING THE PROPERTY AT 3536 Burke Rd Main House Flatonina
(Street Address and City)

A. LEAD WARNING STATEMENT: "Every purchaser of any interest in residential real property on which a residential dwelling was built prior to 1978 is notified that such property may present exposure to lead from lead-based paint that may place young children at risk of developing lead poisoning. Lead poisoning in young children may produce permanent neurological damage, including learning disabilities, reduced intelligence quotient, behavioral problems, and impaired memory. Lead poisoning also poses a particular risk to pregnant women. The seller of any interest in residential real property is required to provide the buyer with any information on lead-based paint hazards from risk assessments or inspections in the seller's possession and notify the buyer of any known lead-based paint hazards. A risk assessment or inspection for possible lead-paint hazards is recommended prior to purchase."

NOTICE: Inspector must be properly certified as required by federal law.

B. SELLER'S DISCLOSURE:

1. PRESENCE OF LEAD-BASED PAINT AND/OR LEAD-BASED PAINT HAZARDS (check one box only):
☐ (a) Known lead-based paint and/or lead-based paint hazards are present in the Property (explain): _____
☒ (b) Seller has no actual knowledge of lead-based paint and/or lead-based paint hazards in the Property.
2. RECORDS AND REPORTS AVAILABLE TO SELLER (check one box only):
☐ (a) Seller has provided the purchaser with all available records and reports pertaining to lead-based paint and/or lead-based paint hazards in the Property (list documents): _____
☒ (b) Seller has no reports or records pertaining to lead-based paint and/or lead-based paint hazards in the Property.

C. BUYER'S RIGHTS (check one box only):

- ☐ 1. Buyer waives the opportunity to conduct a risk assessment or inspection of the Property for the presence of lead-based paint or lead-based paint hazards.
- ☐ 2. Within ten days after the effective date of this contract, Buyer may have the Property inspected by inspectors selected by Buyer. If lead-based paint or lead-based paint hazards are present, Buyer may terminate this contract by giving Seller written notice within 14 days after the effective date of this contract, and the earnest money will be refunded to Buyer.

D. BUYER'S ACKNOWLEDGMENT (check applicable boxes):

- ☐ 1. Buyer has received copies of all information listed above.
- ☐ 2. Buyer has received the pamphlet *Protect Your Family from Lead in Your Home*.

E. BROKERS' ACKNOWLEDGMENT: Brokers have informed Seller of Seller's obligations under 42 U.S.C. 4852d to: (a) provide Buyer with the federally approved pamphlet on lead poisoning prevention; (b) complete this addendum; (c) disclose any known lead-based paint and/or lead-based paint hazards in the Property; (d) deliver all records and reports to Buyer pertaining to lead-based paint and/or lead-based paint hazards in the Property; (e) provide Buyer a period of up to 10 days to have the Property inspected; and (f) retain a completed copy of this addendum for at least 3 years following the sale. Brokers are aware of their responsibility to ensure compliance.

F. CERTIFICATION OF ACCURACY: The following persons have reviewed the information above and certify, to the best of their knowledge, that the information they have provided is true and accurate.

Buyer _____ Date _____

Seller
Gilbert Flores, Jr.

6.23.18
Date

Buyer _____ Date _____

Seller _____ Date _____

Other Broker _____ Date _____

Listing Broker
Bernadine Kainer
6-23-18
Date

The form of this addendum has been approved by the Texas Real Estate Commission for use only with similarly approved or promulgated forms of contracts. Such approval relates to this contract form only. TREC forms are intended for use only by trained real estate licensees. No representation is made as to the legal validity or adequacy of any provision in any specific transactions. It is not suitable for complex transactions. Texas Real Estate Commission, P.O. Box 12188, Austin, TX 78711-2188, 512-936-3000 (<http://www.trec.texas.gov>)

(TAR 1906) 10-10-11

Holub Real Estate, 1439 Hanz Dr Suite 100 New Braunfels, TX 78130
Bernadine Kainer

Produced with zipForm® by zipLogix 18070 Fifteen Mile Road, Fraser, Michigan 48026 www.ziplogix.com

Phone: 3617725105

Fax: 8302146603

TREC No. OP-L

3536 Burke Rd,



TEXAS ASSOCIATION OF REALTORS®
INFORMATION ABOUT ON-SITE SEWER FACILITY
USE OF THIS FORM BY PERSONS WHO ARE NOT MEMBERS OF THE TEXAS ASSOCIATION OF REALTORS® IS NOT AUTHORIZED.
 ©Texas Association of REALTORS®, Inc., 2004

CONCERNING THE PROPERTY AT

**3536 Burke Rd Main House
 Flatonia, TX 78941-5173**

A. DESCRIPTION OF ON-SITE SEWER FACILITY ON PROPERTY:

- (1) Type of Treatment System: ☒ Septic Tank ☐ Aerobic Treatment ☐ Unknown
- (2) Type of Distribution System: _____ ☐ Unknown
- (3) Approximate Location of Drain Field or Distribution System: _____ ☐ Unknown
- _____
- _____
- (4) Installer: _____ ☐ Unknown
- (5) Approximate Age: _____ ☐ Unknown

B. MAINTENANCE INFORMATION:

- (1) Is Seller aware of any maintenance contract in effect for the on-site sewer facility? ☐ Yes ☒ No
 If yes, name of maintenance contractor: _____
 Phone: _____ contract expiration date: _____
Maintenance contracts must be in effect to operate aerobic treatment and certain non-standard on-site sewer facilities.)
- (2) Approximate date any tanks were last pumped? Dec 2017
- (3) Is Seller aware of any defect or malfunction in the on-site sewer facility? ☐ Yes ☒ No
 If yes, explain: _____
- _____
- _____
- (4) Does Seller have manufacturer or warranty information available for review? ☐ Yes ☒ No

C. PLANNING MATERIALS, PERMITS, AND CONTRACTS:

- (1) The following items concerning the on-site sewer facility are attached:
☐ planning materials ☐ permit for original installation ☐ final inspection when OSSF was installed
☐ maintenance contract ☐ manufacturer information ☐ warranty information ☐ _____
- (2) "Planning materials" are the supporting materials that describe the on-site sewer facility that are submitted to the permitting authority in order to obtain a permit to install the on-site sewer facility.
- (3) **It may be necessary for a buyer to have the permit to operate an on-site sewer facility transferred to the buyer.**

(TAR-1407) 1-7-04

Initialed for Identification by Buyer _____, _____ and Seller _____, _____

Page 1 of 2

Holub Real Estate, 1439 Hanz Dr Suite 100 New Braunfels, TX 78130
 Bernadine Kainer

Produced with zipForm® by zipLogix 18070 Fifteen Mile Road, Fraser, Michigan 48026 www.zipLogix.com

Phone: 3617725105

Fax: 8302146603

3536 Burke Rd,

D. INFORMATION FROM GOVERNMENTAL AGENCIES: Pamphlets describing on-site sewer facilities are available from the Texas Agricultural Extension Service. Information in the following table was obtained from Texas Commission on Environmental Quality (TCEQ) on 10/24/2002. The table estimates daily wastewater usage rates. Actual water usage data or other methods for calculating may be used if accurate and acceptable to TCEQ.

<u>Facility</u>	<u>Usage (gal/day) without water- saving devices</u>	<u>Usage (gal/day) with water- saving devices</u>
Single family dwelling (1-2 bedrooms; less than 1,500 sf)	225	180
Single family dwelling (3 bedrooms; less than 2,500 sf)	300	240
Single family dwelling (4 bedrooms; less than 3,500 sf)	375	300
Single family dwelling (5 bedrooms; less than 4,500 sf)	450	360
Single family dwelling (6 bedrooms; less than 5,500 sf)	525	420
Mobile home, condo, or townhouse (1-2 bedroom)	225	180
Mobile home, condo, or townhouse (each add'l bedroom)	75	60

This document is not a substitute for any inspections or warranties. This document was completed to the best of Seller's knowledge and belief on the date signed. Seller and real estate agents are not experts about on-site sewer facilities. Buyer is encouraged to have the on-site sewer facility inspected by an inspector of Buyer's choice.

Signature of Seller
Gilbert Flores, Jr.

6-23-18
Date

Signature of Seller

Date

Receipt acknowledged by:

Signature of Buyer

Date

Signature of Buyer

Date



TEXAS ASSOCIATION OF REALTORS® SELLER'S DISCLOSURE NOTICE

©Texas Association of REALTORS®, Inc. 2018

Section 5.008, Property Code requires a seller of residential property of not more than one dwelling unit to deliver a Seller's Disclosure Notice to a buyer on or before the effective date of a contract. This form complies with and contains additional disclosures which exceed the minimum disclosures required by the Code.

CONCERNING THE PROPERTY AT

**3536 Burke Rd Barn House
Flatonia, TX 78941-5173**

THIS NOTICE IS A DISCLOSURE OF SELLER'S KNOWLEDGE OF THE CONDITION OF THE PROPERTY AS OF THE DATE SIGNED BY SELLER AND IS NOT A SUBSTITUTE FOR ANY INSPECTIONS OR WARRANTIES THE BUYER MAY WISH TO OBTAIN. IT IS NOT A WARRANTY OF ANY KIND BY SELLER, SELLER'S AGENTS, OR ANY OTHER AGENT.

Seller ✓ is ✓ is not occupying the Property. If unoccupied (by Seller), how long since Seller has occupied the Property? _____ (approximate date) or _____ never occupied the Property

Section 1. The Property has the items marked below: (Mark Yes (Y), No (N), or Unknown (U).)

This notice does not establish the items to be conveyed. The contract will determine which items will & will not convey.

Item	Y	N	U
Cable TV Wiring	✓		
Carbon Monoxide Det.		✓	
Ceiling Fans	✓		
Cooktop		✓	
Dishwasher		✓	
Disposal		✓	
Emergency Escape Ladder(s)		✓	
Exhaust Fans		✓	
Fences	✓		
Fire Detection Equip.	✓		
French Drain	✓		
Gas Fixtures		✓	
Natural Gas Lines		✓	

Item	Y	N	U
Liquid Propane Gas:		✓	
-LP Community (Captive)		✓	
-LP on Property		✓	
Hot Tub		✓	
Intercom System		✓	
Microwave		✓	
Outdoor Grill		✓	
Patio/Decking		✓	
Plumbing System	✓		
Pool		✓	
Pool Equipment		✓	
Pool Maint. Accessories		✓	
Pool Heater		✓	

Item	Y	N	U
Pump: sump grinder		✓	
Rain Gutters		✓	
Range/Stove		✓	
Roof/Attic Vents		✓	
Sauna		✓	
Smoke Detector	✓		
Smoke Detector - Hearing Impaired		✓	
Spa		✓	
Trash Compactor		✓	
TV Antenna		✓	
Washer/Dryer Hookup		✓	
Window Screens	✓		
Public Sewer System		✓	

Item	Y	N	U	Additional Information
Central A/C	✓			✓ electric gas number of units: 1
Evaporative Coolers		✓		number of units: _____
Wall/Window AC Units		✓		number of units: _____
Attic Fan(s)		✓		if yes, describe: _____
Central Heat	✓			✓ electric gas number of units: 1
Other Heat		✓		if yes, describe: _____
Oven		✓		number of ovens: _____ electric gas other: _____
Fireplace & Chimney		✓		wood gas logs mock other: _____
Carport		✓		attached not attached _____
Garage		✓		attached not attached _____
Garage Door Openers		✓		number of units: _____ number of remotes: _____
Satellite Dish & Controls	✓			owned leased from: Dish
Security System		✓		owned leased from: _____
Solar Panels		✓		owned leased from: _____
Water Heater	✓			✓ electric gas other: _____ number of units: 1
Water Softener		✓		owned leased from: _____
Other Leased Items(s)		✓		if yes, describe: _____

(TAR-1406) 02-01-18

Holub Real Estate, 1439 Hanz Dr Suite 100 New Braunfels, TX 78130
Bernadine Kainer

Initialed by: Buyer: _____, _____ and Seller: K

Produced with zipForm® by zipLogix 18070 Fifteen Mile Road, Fraser, Michigan 48026 Phone: 3617725105 Fax: 8302146603
www.zipLogix.com

Page 1 of 5
3536 Burke Rd,

**3536 Burke Rd Barn House
Flatonia, TX 78941-5173**

Concerning the Property at _____

Underground Lawn Sprinkler	<input type="checkbox"/>	<input checked="" type="checkbox"/>	automatic	manual	areas covered:
Septic / On-Site Sewer Facility	<input type="checkbox"/>	<input checked="" type="checkbox"/>	if yes, attach Information About On-Site Sewer Facility (TAR-1407)		

Water supply provided by: city well MUD co-op unknown other: _____

Was the Property built before 1978? yes no unknown

(If yes, complete, sign, and attach TAR-1906 concerning lead-based paint hazards).

Roof Type: Metal Age: New (approximate)

Is there an overlay roof covering on the Property (shingles or roof covering placed over existing shingles or roof covering)? yes no unknown

Are you (Seller) aware of any of the items listed in this Section 1 that are not in working condition, that have defects, or are need of repair? yes no If yes, describe (attach additional sheets if necessary): _____

Section 2. Are you (Seller) aware of any defects or malfunctions in any of the following?: (Mark Yes (Y) if you are aware and No (N) if you are not aware.)

Item	Y	N
Basement	<input type="checkbox"/>	<input checked="" type="checkbox"/>
Ceilings	<input type="checkbox"/>	<input checked="" type="checkbox"/>
Doors	<input type="checkbox"/>	<input checked="" type="checkbox"/>
Driveways	<input type="checkbox"/>	<input checked="" type="checkbox"/>
Electrical Systems	<input checked="" type="checkbox"/>	<input type="checkbox"/>
Exterior Walls	<input type="checkbox"/>	<input checked="" type="checkbox"/>

Item	Y	N
Floors	<input type="checkbox"/>	<input checked="" type="checkbox"/>
Foundation / Slab(s)	<input type="checkbox"/>	<input checked="" type="checkbox"/>
Interior Walls	<input type="checkbox"/>	<input checked="" type="checkbox"/>
Lighting Fixtures	<input type="checkbox"/>	<input checked="" type="checkbox"/>
Plumbing Systems	<input type="checkbox"/>	<input checked="" type="checkbox"/>
Roof	<input type="checkbox"/>	<input checked="" type="checkbox"/>

Item	Y	N
Sidewalks	<input type="checkbox"/>	<input checked="" type="checkbox"/>
Walls / Fences	<input type="checkbox"/>	<input checked="" type="checkbox"/>
Windows	<input type="checkbox"/>	<input checked="" type="checkbox"/>
Other Structural Components	<input type="checkbox"/>	<input checked="" type="checkbox"/>

If the answer to any of the items in Section 2 is yes, explain (attach additional sheets if necessary): _____

Master Bedroom needs Septic System

Section 3. Are you (Seller) aware of any of the following conditions: (Mark Yes (Y) if you are aware and No (N) if you are not aware.)

Condition	Y	N
Aluminum Wiring	<input type="checkbox"/>	<input checked="" type="checkbox"/>
Asbestos Components	<input type="checkbox"/>	<input checked="" type="checkbox"/>
Diseased Trees: <u>oak wilt</u>	<input type="checkbox"/>	<input checked="" type="checkbox"/>
Endangered Species/Habitat on Property	<input type="checkbox"/>	<input checked="" type="checkbox"/>
Fault Lines	<input type="checkbox"/>	<input checked="" type="checkbox"/>
Hazardous or Toxic Waste	<input type="checkbox"/>	<input checked="" type="checkbox"/>
Improper Drainage	<input type="checkbox"/>	<input checked="" type="checkbox"/>
Intermittent or Weather Springs	<input type="checkbox"/>	<input checked="" type="checkbox"/>
Landfill	<input type="checkbox"/>	<input checked="" type="checkbox"/>
Lead-Based Paint or Lead-Based Pt. Hazards	<input type="checkbox"/>	<input checked="" type="checkbox"/>
Encroachments onto the Property	<input type="checkbox"/>	<input checked="" type="checkbox"/>
Improvements encroaching on others' property	<input type="checkbox"/>	<input checked="" type="checkbox"/>
Located in 100-year Floodplain (If yes, attach TAR-1414)	<input type="checkbox"/>	<input checked="" type="checkbox"/>
Located in Floodway (If yes, attach TAR-1414)	<input type="checkbox"/>	<input checked="" type="checkbox"/>
Present Flood Ins. Coverage (If yes, attach TAR-1414)	<input type="checkbox"/>	<input checked="" type="checkbox"/>
Previous Flooding into the Structures	<input type="checkbox"/>	<input checked="" type="checkbox"/>
Previous Flooding onto the Property	<input type="checkbox"/>	<input checked="" type="checkbox"/>
Located in Historic District	<input type="checkbox"/>	<input checked="" type="checkbox"/>

Condition	Y	N
Previous Foundation Repairs	<input type="checkbox"/>	<input checked="" type="checkbox"/>
Previous Roof Repairs	<input checked="" type="checkbox"/>	<input type="checkbox"/>
Previous Other Structural Repairs	<input type="checkbox"/>	<input checked="" type="checkbox"/>
Radon Gas	<input type="checkbox"/>	<input checked="" type="checkbox"/>
Settling	<input type="checkbox"/>	<input checked="" type="checkbox"/>
Soil Movement	<input type="checkbox"/>	<input checked="" type="checkbox"/>
Subsurface Structure or Pits	<input type="checkbox"/>	<input checked="" type="checkbox"/>
Underground Storage Tanks	<input type="checkbox"/>	<input checked="" type="checkbox"/>
Unplatted Easements	<input type="checkbox"/>	<input checked="" type="checkbox"/>
Unrecorded Easements	<input type="checkbox"/>	<input checked="" type="checkbox"/>
Urea-formaldehyde Insulation	<input type="checkbox"/>	<input checked="" type="checkbox"/>
Water Penetration	<input type="checkbox"/>	<input checked="" type="checkbox"/>
Wetlands on Property	<input type="checkbox"/>	<input checked="" type="checkbox"/>
Wood Rot	<input type="checkbox"/>	<input checked="" type="checkbox"/>
Active infestation of termites or other wood destroying insects (WDI)	<input type="checkbox"/>	<input checked="" type="checkbox"/>
Previous treatment for termites or WDI	<input type="checkbox"/>	<input checked="" type="checkbox"/>
Previous termite or WDI damage repaired	<input type="checkbox"/>	<input checked="" type="checkbox"/>
Previous Fires	<input type="checkbox"/>	<input checked="" type="checkbox"/>

(TAR-1406) 02-01-18

Initialed by: Buyer: _____ and Seller: 4

Concerning the Property at _____

**3536 Burke Rd Barn House
Flatonia, TX 78941-5173**

Historic Property Designation	<input checked="" type="checkbox"/>	Termite or WDI damage needing repair	<input checked="" type="checkbox"/>
Previous Use of Premises for Manufacture of Methamphetamine	<input checked="" type="checkbox"/>	Single Blockable Main Drain in Pool/Hot Tub/Spa*	<input checked="" type="checkbox"/>

If the answer to any of the items in Section 3 is yes, explain (attach additional sheets if necessary):

The roof was replaced due to hurricane

*A single blockable main drain may cause a suction entrapment hazard for an individual.

Section 4. Are you (Seller) aware of any item, equipment, or system in or on the Property that is in need of repair, which has not been previously disclosed in this notice? ☒ yes ☒ no If yes, explain (attach additional sheets if necessary):

Section 5. Are you (Seller) aware of any of the following (Mark Yes (Y) if you are aware. Mark No (N) if you are not aware.)

☒ Y ☒ N

Room additions, structural modifications, or other alterations or repairs made without necessary permits, with unresolved permits, or not in compliance with building codes in effect at the time.

Homeowners' associations or maintenance fees or assessments. If yes, complete the following:

Name of association: _____

Manager's name: _____

Phone: _____

Fees or assessments are: \$ _____ per _____ and are: ☐ mandatory ☐ voluntary

Any unpaid fees or assessment for the Property? ☐ yes (\$ _____) ☒ no

If the Property is in more than one association, provide information about the other associations below or attach information to this notice.

Any common area (facilities such as pools, tennis courts, walkways, or other) co-owned in undivided interest with others. If yes, complete the following:

Any optional user fees for common facilities charged? ☐ yes ☒ no If yes, describe: _____

Any notices of violations of deed restrictions or governmental ordinances affecting the condition or use of the Property.

Any lawsuits or other legal proceedings directly or indirectly affecting the Property. (Includes, but is not limited to: divorce, foreclosure, heirship, bankruptcy, and taxes.)

Any death on the Property except for those deaths caused by: natural causes, suicide, or accident unrelated to the condition of the Property.

Any condition on the Property which materially affects the health or safety of an individual.

Any repairs or treatments, other than routine maintenance, made to the Property to remediate environmental hazards such as asbestos, radon, lead-based paint, urea-formaldehyde, or mold.

If yes, attach any certificates or other documentation identifying the extent of the remediation (for example, certificate of mold remediation or other remediation).

Any rainwater harvesting system located on the Property that is larger than 500 gallons and that uses a public water supply as an auxiliary water source.

The Property is located in a propane gas system service area owned by a propane distribution system retailer.

Any portion of the Property that is located in a groundwater conservation district or a subsidence district.

Concerning the Property at _____

**3536 Burke Rd Barn House
Flatonia, TX 78941-5173**

If the answer to any of the items in Section 5 is yes, explain (attach additional sheets if necessary): _____

Section 6. Seller ☒ has ☐ has not attached a survey of the Property.

Section 7. Within the last 4 years, have you (Seller) received any written inspection reports from persons who regularly provide inspections and who are either licensed as inspectors or otherwise permitted by law to perform inspections? ☒ yes ☐ no If yes, attach copies and complete the following:

Inspection Date	Type	Name of Inspector	No. of Pages

Note: A buyer should not rely on the above-cited reports as a reflection of the current condition of the Property. A buyer should obtain inspections from inspectors chosen by the buyer.

Section 8. Check any tax exemption(s) which you (Seller) currently claim for the Property:

☐ Homestead
☐ Wildlife Management
☐ Other: _____

☒ Senior Citizen
☒ Agricultural

☐ Disabled
☐ Disabled Veteran
☐ Unknown

Section 9. Have you (Seller) ever filed a claim for damage to the Property with any insurance provider? ☒ yes ☐ no

Section 10. Have you (Seller) ever received proceeds for a claim for damage to the Property (for example, an insurance claim or a settlement or award in a legal proceeding) and not used the proceeds to make the repairs for which the claim was made? ☒ yes ☐ no If yes, explain: _____

Section 11. Does the Property have working smoke detectors installed in accordance with the smoke detector requirements of Chapter 766 of the Health and Safety Code? ☒ unknown ☐ no ☐ yes. If no or unknown, explain. (Attach additional sheets if necessary): _____

**Chapter 766 of the Health and Safety Code requires one-family or two-family dwellings to have working smoke detectors installed in accordance with the requirements of the building code in effect in the area in which the dwelling is located, including performance, location, and power source requirements. If you do not know the building code requirements in effect in your area, you may check unknown above or contact your local building official for more information.*

A buyer may require a seller to install smoke detectors for the hearing impaired if: (1) the buyer or a member of the buyer's family who will reside in the dwelling is hearing-impaired; (2) the buyer gives the seller written evidence of the hearing impairment from a licensed physician; and (3) within 10 days after the effective date, the buyer makes a written request for the seller to install smoke detectors for the hearing-impaired and specifies the locations for installation. The parties may agree who will bear the cost of installing the smoke detectors and which brand of smoke detectors to install.

Seller acknowledges that the statements in this notice are true to the best of Seller's belief and that no person, including the broker(s), has instructed or influenced Seller to provide inaccurate information or to omit any material information.

Signature of Seller _____

Date 6.23.18

Signature of Seller _____

Date _____

Printed Name: _____

Printed Name: _____

(TAR-1406) 02-01-18

Initialed by: Buyer: _____

and Seller: J

Concerning the Property at _____

**3536 Burke Rd Barn House
Flatonia, TX 78941-5173**

ADDITIONAL NOTICES TO BUYER:

- (1) The Texas Department of Public Safety maintains a database that the public may search, at no cost, to determine if registered sex offenders are located in certain zip code areas. To search the database, visit www.txdps.state.tx.us. For information concerning past criminal activity in certain areas or neighborhoods, contact the local police department.
- (2) If the Property is located in a coastal area that is seaward of the Gulf Intracoastal Waterway or within 1,000 feet of the mean high tide bordering the Gulf of Mexico, the Property may be subject to the Open Beaches Act or the Dune Protection Act (Chapter 61 or 63, Natural Resources Code, respectively) and a beachfront construction certificate or dune protection permit may be required for repairs or improvements. Contact the local government with ordinance authority over construction adjacent to public beaches for more information.
- (3) If the Property is located in a seacoast territory of this state designated as a catastrophe area by the Commissioner of the Texas Department of Insurance, the Property may be subject to additional requirements to obtain or continue windstorm and hail insurance. A certificate of compliance may be required for repairs or improvements to the Property. For more information, please review *Information Regarding Windstorm and Hail Insurance for Certain Properties* (TAR 2518) and contact the Texas Department of Insurance or the Texas Windstorm Insurance Association.
- (4) This Property may be located near a military installation and may be affected by high noise or air installation compatible use zones or other operations. Information relating to high noise and compatible use zones is available in the most recent Air Installation Compatible Use Zone Study or Joint Land Use Study prepared for a military installation and may be accessed on the Internet website of the military installation and of the county and any municipality in which the military installation is located.
- (5) If you are basing your offers on square footage, measurements, or boundaries, you should have those items independently measured to verify any reported information.
- (6) The following providers currently provide service to the Property:

Electric: Singletts electric
Sewer: _____
Water: _____
Cable: Direct TV
Trash: _____
Natural Gas: X
Phone Company: _____
Propane: Tex Propane Schumacher
Internet: Direct TV

phone #: _____
phone #: _____
phone #: _____
phone #: _____
phone #: _____
phone #: _____
phone #: _____
phone #: _____

- (7) This Seller's Disclosure Notice was completed by Seller as of the date signed. The brokers have relied on this notice as true and correct and have no reason to believe it to be false or inaccurate. YOU ARE ENCOURAGED TO HAVE AN INSPECTOR OF YOUR CHOICE INSPECT THE PROPERTY.

The undersigned Buyer acknowledges receipt of the foregoing notice.

Signature of Buyer _____
Printed Name: _____

Date _____
Signature of Buyer _____
Printed Name: _____

(TAR-1406) 02-01-18

Initialed by: Buyer: _____, _____ and Seller: L, _____