

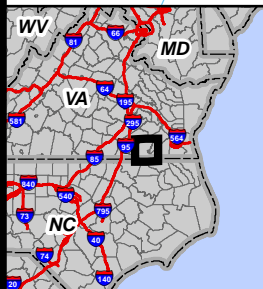

0 1,320 Feet

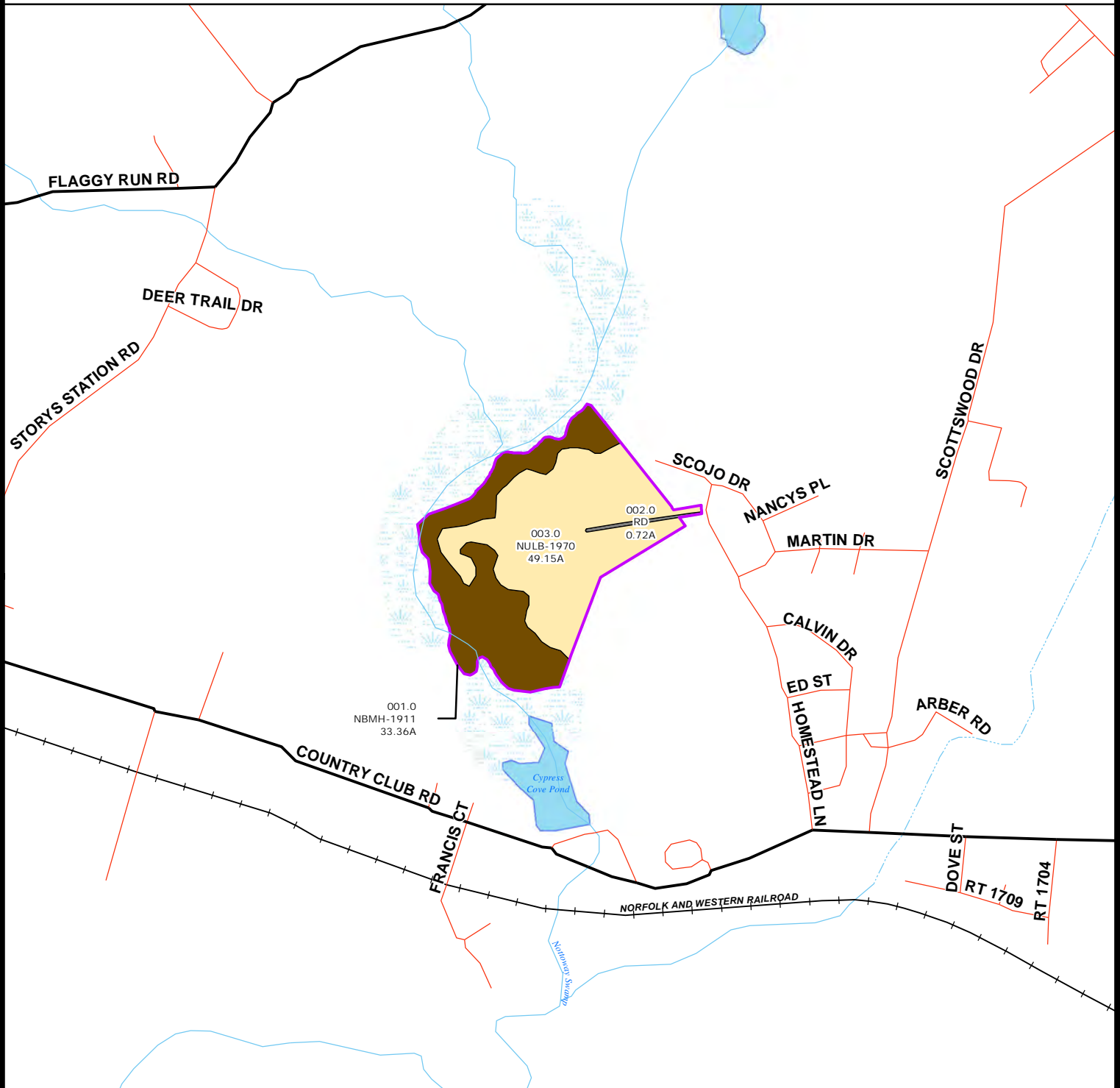

Stand Nomenclature	
Stand # Description Acres	
Stand Origin	(N) (B) (MH) / (MP) - (74)
Land Type	
Dominant Species	
Secondary Species	
Year of Origin	

**Note:**

1. Road polygons are not annotated
2. Stand type acres report restricted to compartment area of interest
3. Road data is not digitized & has been provided via ESRI data & maps 9.3.1 datasets.

Stand Types	
Cutover	Natural Upland (49.15 ac.)
Natural Bottomland (33.36 ac.)	Non Forested
Natural Irrigated	Non Timbered (0.72 ac.)
Natural Lowland	Planted Lowland
Natural Slope	Planted Upland
	Thinned (0 ac.)
	Gate

