

# Soils Map

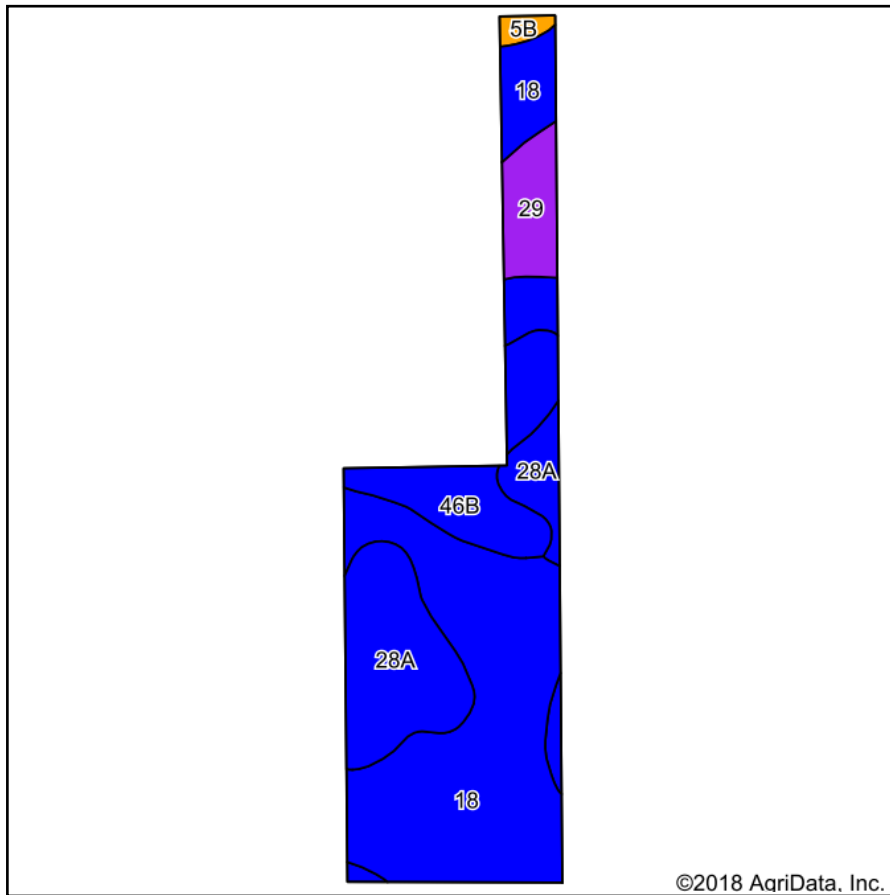

Soils data provided by USDA and NRCS.

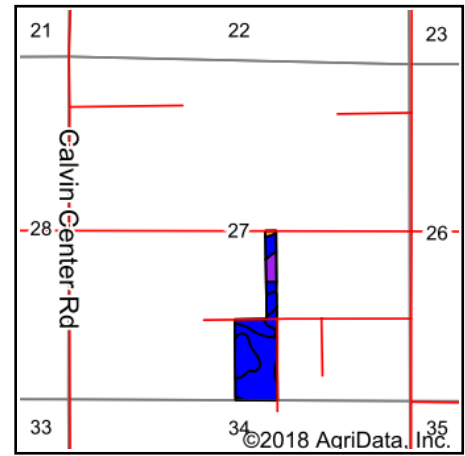

State: **Michigan**  
 County: **Cass**  
 Location: **27-7S-14W**  
 Township: **Calvin**  
 Acres: **24**  
 Date: **8/24/2018**



Maps Provided By:



## Area Symbol: MI027, Soil Area Version: 14

Code	Soil Description	Acres	Percent of field	Non-Irr Class Legend	Non-Irr Class *c	Irr Class *c	Alfalfa hay	Brome grass alfalfa hay	Corn	Corn silage	Oats	Soybeans	Sugar beets	Winter wheat
18	Barry loam, 0 to 2 percent slopes	12.65	52.7%		IIw									
28A	Teasdale fine sandy loam, 0 to 3 percent slopes	6.24	26.0%		IIw		4.5		115	19	90	33	19	50
46B	Cassopolis fine sandy loam, 3 to 6 percent slopes	3.28	13.7%		Ile		4.6	4	115	18		40		46
29	Palms muck, 0 to 1 percent slopes	1.56	6.5%		Vw									
5B	Spinks loamy sand, 0 to 6 percent slopes	0.27	1.1%		IIIIs	IIIIs								
Weighted Average							1.8	0.5	45.6	7.4	23.4	14	4.9	19.3

\*c: Using Capabilities Class Dominant Condition Aggregation Method

Soils data provided by USDA and NRCS.