

Soils Map

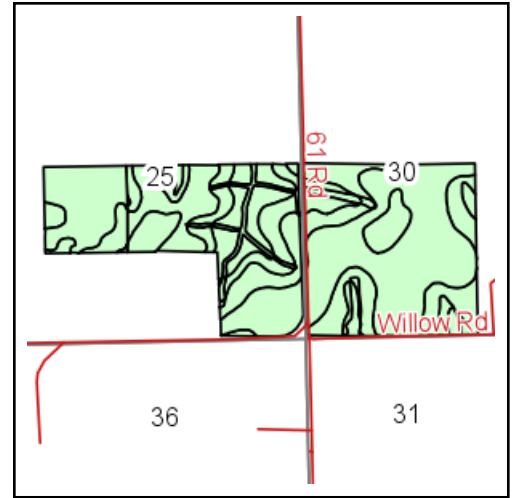

State: **Nebraska**
 County: **Gage**
 Location: **25-1N-5E**
 Township: **Glenwood**
 Acres: **318.9**
 Date: **4/10/2013**

Field borders provided by Farm Service Agency as of 5/21/2008.
 Soils data provided by USDA and NRCS.

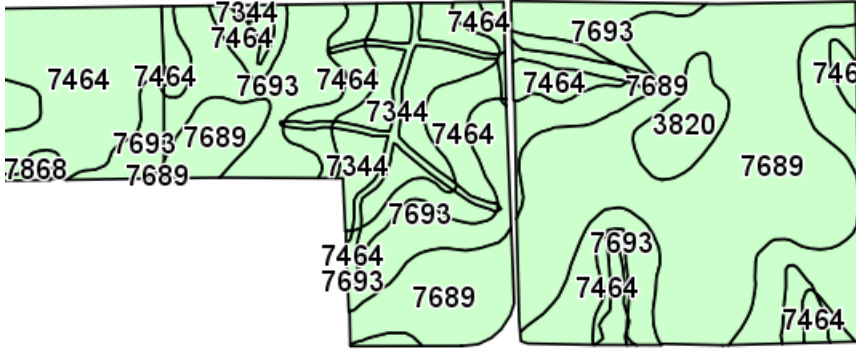
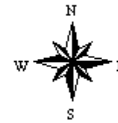

Maps provided by:



Code	Soil Description	Acres	Percent of field	Non-Irr Class	Irr Class	SRPG	Alfalfa hay	Corn	Grain sorghum	Oats	Soybeans	Winter wheat
7689	Wymore silty clay loam, 0 to 2 percent slopes	113.2	35.5%	Ils	Ils	72						
7693	Wymore silty clay loam, 2 to 6 percent slopes	93.2	29.2%	IIle	IIle	69						
7464	Otoe silty clay loam, 6 to 11 percent slopes, eroded	75	23.5%	IVe	IVe	66	3.5	44	52	42		29
7344	Malmo, eroded-Pawnee complex, 6 to 11 percent slopes	27.1	8.5%	IVe	IVe	52	2	50	50		18	25
3820	Butler silt loam, 0 to 1 percent slopes	9	2.8%	IIw	IIw	67						
7868	Nodaway silt loam, channeled, occasionally flooded	1.4	0.4%	VIw		74						
Weighted Average						67.8	1	14.6	16.5	9.9	1.5	8.9