

**Parcel Information**

Parcel #: 27871

Alternate ID: 0510074110000100000

Account #: 7N4W1100 1000

Site Address:  
Clatskanie OR 97016Owner: Clifford Family Limited Partnership  
1350 S Conyers Creek Rd  
Clatskanie OR 97016

Twn/Range/Section: T: 7N R: 4W S: 11

Parcel Size: 6.41 Acres (279,220 SqFt)

Lot/Block: /

Census Tract/Block: 970200/3111

Levy Code: 0510

Levy Rate: 12.5072 (2017)

Market Land Value: \$29,140

Market Impr Value: \$0

Market Total Value: \$29,140 (2017)

Assessed Land Value: \$2,898

Assessed Impr Value: \$0

Assessed Total Value: \$2,898 (2017)

**Tax Information**

Tax Year	Annual Tax
2017	\$46.37
2016	\$45.64
2015	\$44.79

**Legal****Land**Land Use: 641 - IMPRVD H&B USE TRACT FOREST/WLO, DESIGNATED,  
ZONING NOT SIGNIFICANT

Zoning: SM - Surface Mining

School Dist: 340 - Clatskanie School District

Watershed: 1708000304 - Beaver Creek-Frontal  
Columbia River

Waterfront Name:

**Improvement**

Year Built: 0

Fireplaces: 0

Bldg Use: 401 - H &amp; B Use Rural Tract Improved

Bedrooms: 0

Total Baths: 0.00

Full/Half Baths: 0 / 0

Finished Area: 0 SqFt

Floor 1: 0 SqFt

Floor 2: 0 SqFt

Garage: 0 SqFt

Carport: 0 SqFt

Heat:

Bldg/Dwelling Count: 0 / 0

Bldg Name:

Bldg Type:

**Transfer Information**

Rcrdg Date:	09/24/98	Sale Price:		Doc Num:	F9812208	Doc Type:	Grant Deed
Owner:	CLIFFORD FAMILY LIMITED PARTNERSHIP TRUST			Grantor:	OWNER NAME UNAVAILABLE		

Sentry Dynamics, Inc. and its customers make no representations, warranties or conditions, express or implied, as to the accuracy or completeness of information contained in this report.

**STATEMENT OF TAX ACCOUNT**  
**COLUMBIA COUNTY TAX COLLECTOR**  
**230 STRAND STREET**  
**ST. HELENS, OR 97051**  
**(503) 397-0060**

24-Jan-2018

CLIFFORD FAMILY LIMITED PARTNERSHIP  
1350 S CONYERS CREEK RD  
CLATSKANIE, OR 97016

Tax Account #	27871	Lender Name	
Account Status	A	Loan Number	
Roll Type	Real	Property ID	0510
Situs Address		Interest To	Feb 15, 2018

**Tax Summary**

Tax Year	Tax Type	Total Due	Current Due	Interest Due	Discount Available	Original Due	Due Date	Prev Disc
2017	ADVALOREM	\$0.00	\$0.00	\$0.00	\$0.00	\$46.37	Nov 15, 2017	\$1.39
2016	ADVALOREM	\$0.00	\$0.00	\$0.00	\$0.00	\$45.64	Nov 15, 2016	\$1.37
2015	ADVALOREM	\$0.00	\$0.00	\$0.00	\$0.00	\$44.79	Nov 15, 2015	\$1.34
2014	ADVALOREM	\$0.00	\$0.00	\$0.00	\$0.00	\$43.95	Nov 15, 2014	\$1.32
2013	ADVALOREM	\$0.00	\$0.00	\$0.00	\$0.00	\$41.55	Nov 15, 2013	\$1.25
2012	ADVALOREM	\$0.00	\$0.00	\$0.00	\$0.00	\$40.56	Nov 15, 2012	\$1.22
2011	ADVALOREM	\$0.00	\$0.00	\$0.00	\$0.00	\$43.83	Nov 15, 2011	\$1.31
2010	ADVALOREM	\$0.00	\$0.00	\$0.00	\$0.00	\$43.36	Nov 15, 2010	\$1.30
2009	ADVALOREM	\$0.00	\$0.00	\$0.00	\$0.00	\$41.92	Nov 15, 2009	\$1.26
2008	ADVALOREM	\$0.00	\$0.00	\$0.00	\$0.00	\$43.29	Nov 15, 2008	\$1.30
2007	ADVALOREM	\$0.00	\$0.00	\$0.00	\$0.00	\$40.05	Nov 15, 2007	\$1.20
2006	ADVALOREM	\$0.00	\$0.00	\$0.00	\$0.00	\$39.99	Nov 15, 2006	\$1.20
2005	ADVALOREM	\$0.00	\$0.00	\$0.00	\$0.00	\$39.53	Nov 15, 2005	\$1.19
2004	ADVALOREM	\$0.00	\$0.00	\$0.00	\$0.00	\$38.94	Nov 15, 2004	\$1.17
2003	ADVALOREM	\$0.00	\$0.00	\$0.00	\$0.00	\$24.18	Nov 15, 2003	\$0.73
2002	ADVALOREM	\$0.00	\$0.00	\$0.00	\$0.00	\$23.99	Nov 15, 2002	\$0.72
2001	ADVALOREM	\$0.00	\$0.00	\$0.00	\$0.00	\$23.80	Nov 15, 2001	\$0.71
<b>Total</b>		\$0.00	\$0.00	\$0.00	\$0.00	\$665.74		



This map has been copied from the public records and is provided solely for the purpose of assisting in locating the premises. No liabilities are assumed for inaccuracies contained herein or for variations, if any, in dimensions, area or location of the premises or the location of improvements ascertained by actual survey.

THIS MAP WAS PREPARED FOR  
ASSESSMENT PURPOSE ONLY



SECTION 11 T.7N. R.4W. W.M.  
COLUMBIA COUNTY

1" = 400'

07 04 11 00  
& INDEX

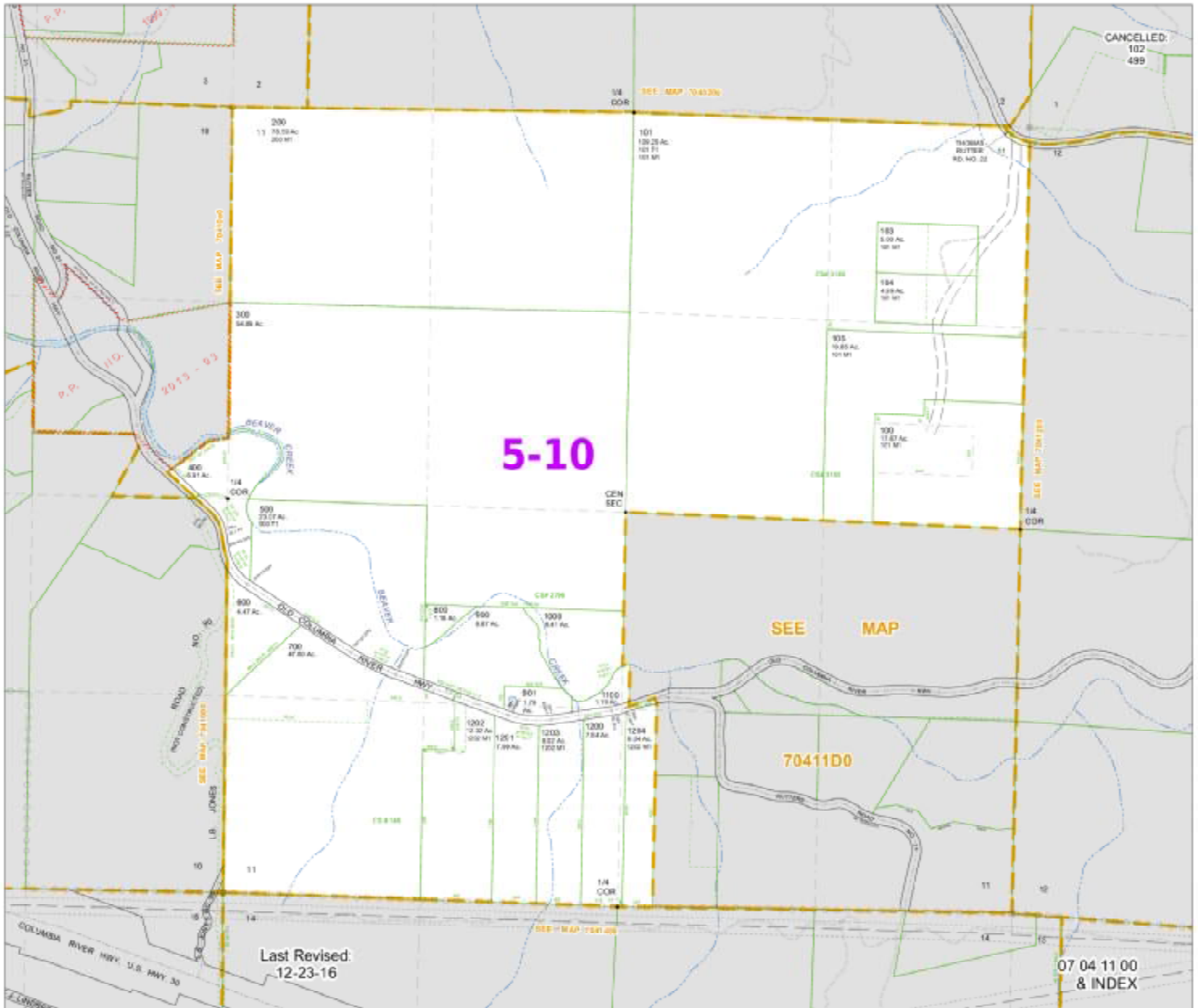

This map has been copied from the public records and is provided solely for the purpose of assisting in locating the premises. No liabilities are assumed for inaccuracies contained herein or for variations, if any, in dimensions, area or location of the premises or the location of improvements ascertained by actual survey.