

Soils Map

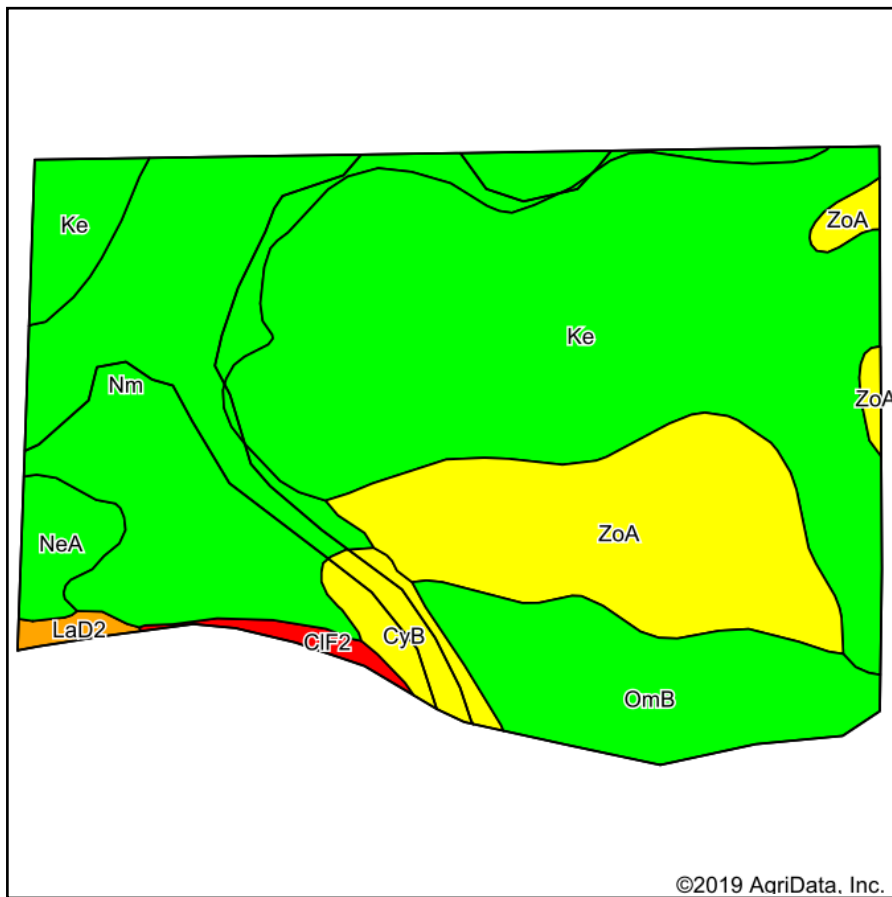

Soils data provided by USDA and NRCS.

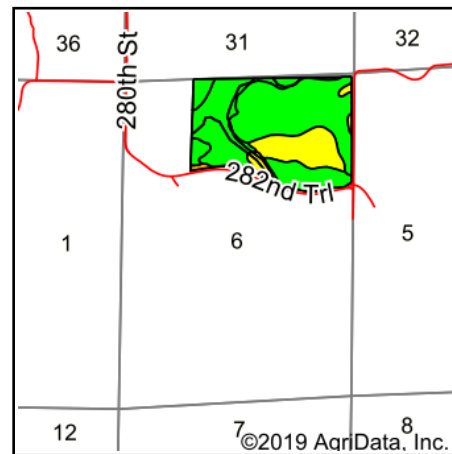

State: **Iowa**
 County: **Madison**
 Location: **6-74N-26W**
 Township: **Ohio**
 Acres: **96.99**
 Date: **1/23/2019**

PEOPLES™
COMPANY
 INNOVATIVE. REAL ESTATE. SOLUTIONS.

Maps Provided By:



Area Symbol: IA121, Soil Area Version: 22

Code	Soil Description	Acres	Percent of field	CSR2 Legend	CSR2**	CSR
Ke	Kennebec silt loam, 0 to 2 percent slopes, occasionally flooded	41.21	42.5%		91	86
Nm	Nodaway silt loam, 0 to 2 percent slopes, occasionally flooded	23.00	23.7%		82	85
ZoA	Zook silty clay loam, 0 to 2 percent slopes, occasionally flooded	16.08	16.6%		67	70
OmB	Olmitz loam, 2 to 5 percent slopes	10.49	10.8%		89	72
CyB	Colo-Ely silty clay loams, gullied, 2 to 5 percent slopes	2.73	2.8%		57	10
NeA	Nevin silty clay loam, 0 to 2 percent slopes, rarely flooded	2.15	2.2%		95	90
CIF2	Clanton silt loam, 14 to 25 percent slopes, moderately eroded	0.75	0.8%		5	5
LaD2	Ladoga silt loam, 9 to 14 percent slopes, eroded	0.58	0.6%		49	52
Weighted Average					82.9	78.7

**IA has updated the CSR values for each county to CSR2.

*c: Using Capabilities Class Dominant Condition Aggregation Method

Soils data provided by USDA and NRCS.