

Soils Map

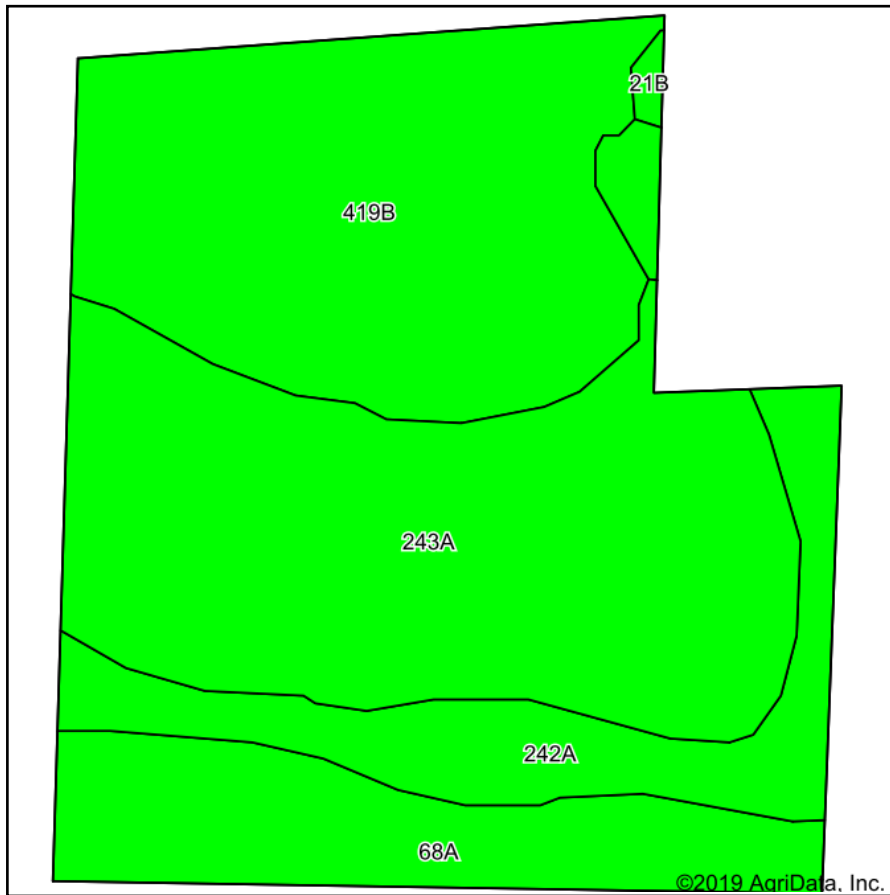

Soils data provided by USDA and NRCS.

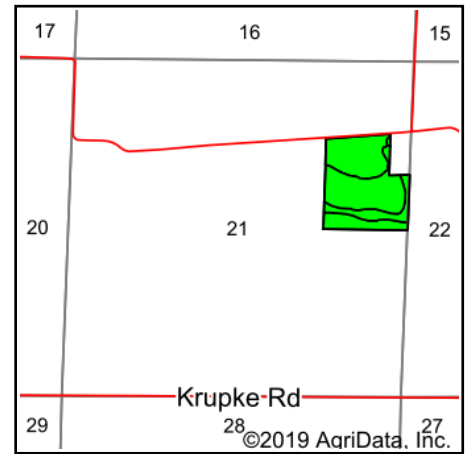

State: **Illinois**
 County: **Boone**
 Location: **21-46N-3E**
 Township: **Manchester**
 Acres: **40.21**
 Date: **3/12/2019**

PEOPLES™
COMPANY
 INNOVATIVE. REAL ESTATE. SOLUTIONS.

Maps Provided By:
surety®
 CUSTOMIZED ONLINE MAPPING
 © AgriData, Inc. 2019 www.AgriDataInc.com



Area Symbol: IL007, Soil Area Version: 12

Code	Soil Description	Acres	Percent of field	Il. State Productivity Index Legend	Corn Bu/A	Soybeans Bu/A	Wheat Bu/A	Oats Bu/A b	Alfalfa d hay, T/A	Crop productivity index for optimum management
243A	St. Charles silt loam, 0 to 2 percent slopes	15.83	39.4%		168	52	65	87	5.14	122
**419B	Flagg silt loam, 2 to 5 percent slopes	12.95	32.2%		**160	**51	**62	**82	**4.97	**118
68A	Sable silty clay loam, 0 to 2 percent slopes	5.70	14.2%		192	63	74	99	0.00	143
242A	Kendall silt loam, 0 to 2 percent slopes	5.57	13.9%		172	53	66	89	0.00	125
**21B	Pecatonica silt loam, 2 to 5 percent slopes	0.16	0.4%		**152	**49	**59	**76	**4.47	**112
Weighted Average					169.3	53.4	65.4	87.3	3.64	124.1

Table: Optimum Crop Productivity Ratings for Illinois Soil by K.R. Olson and J.M. Lang, Office of Research, ACES, University of Illinois at Champaign-Urbana. Version: 1/2/2012 Amended Table S2 B811

Crop yields and productivity indices for optimum management (B811) are maintained at the following NRES web site: <http://soilproductivity.nres.illinois.edu/>

** Indexes adjusted for slope and erosion according to Bulletin 811 Table S3

b Soils in the southern region were not rated for oats and are shown with a zero "0".

d Soils in the poorly drained group were not rated for alfalfa and are shown with a zero "0".

Soils data provided by USDA and NRCS. Soils data provided by University of Illinois at Champaign-Urbana.

*c: Using Capabilities Class Dominant Condition Aggregation Method