

Soils Map

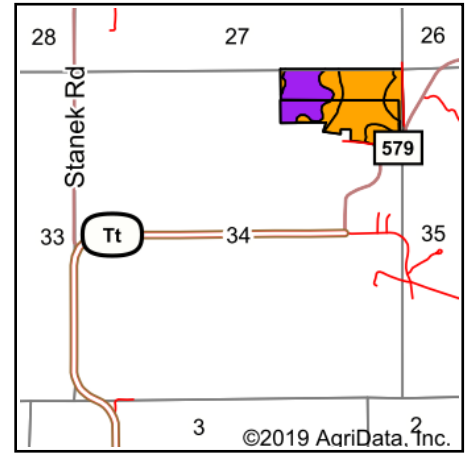

State: **Missouri**
 County: **Lincoln**
 Location: **34-50N-2W**
 Township: **Millwood**
 Acres: **48.27**
 Date: **4/12/2019**

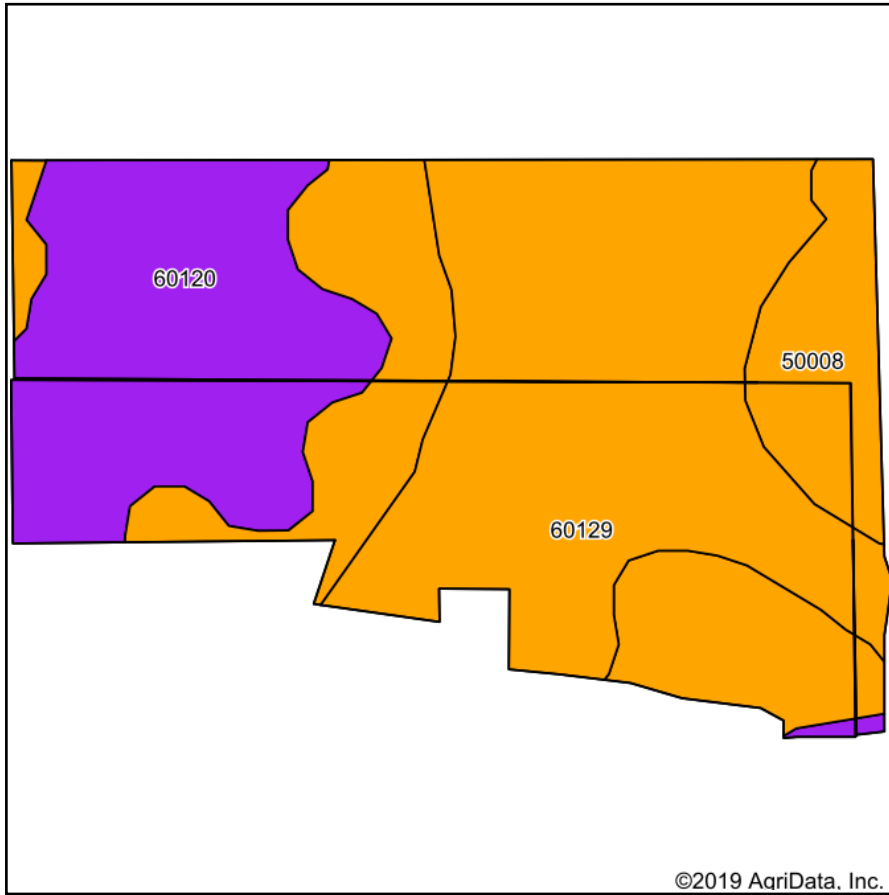

Area Symbol: MO113, Soil Area Version: 19

Code	Soil Description	Acres	Percent of field	Non-Irr Class Legend	Non-Irr Class *c	Alfalfa hay	Caucasian bluestem	Common bermudagrass	Orchardgrass red clover	Tall fescue	Warm season grasses	*n NCCPI Soybeans
60129	Hatton silt loam, 5 to 9 percent slopes	20.60	42.7%		IIIe	3	6	4	5	5	6	54
50008	Keswick silt loam, 5 to 9 percent slopes, eroded	14.40	29.8%		IIIe							45
60120	Goss-Gasconade-Brussels complex, 9 to 70 percent slopes, very stony	13.27	27.5%		VIIe							2
Weighted Average						1.3	2.6	1.7	2.1	2.1	2.6	*n 37

*n: The aggregation method is "Weighted Average using major components"

*c: Using Capabilities Class Dominant Condition Aggregation Method

Soils data provided by USDA and NRCS.