

LAND FOR SALE

Paschetta Pivots

~Lincoln County, NE~



Location:

1 mile north of Hwy 23 on US Hwy. 83 to west Nelson Rd. 1/4 mile west to property. Approximately 19 miles south of North Platte or 7 miles north of Wellfleet, Nebraska.

Legal

Description:

Two surveyed tracts in S1/2 Section 7 and S1/2 Section 8-T10N-R30W of the 6th P.M., Lincoln County, NE.

Acres & Taxes:

366.7 tax assessed acres; 2018 tax payable in 2019 - \$16,348.98; Occupation Tax - \$3,367

Land Use:

336.7 acres pivot irrigated by two electric wells and two pivots, 30 acres range corners.

FSA Info:

359.0 acres cropland; Bases: Corn 293.3 acres at 126 Bu; Soybeans 42.6 acres at 45 Bu.

Water:

Two irrigation wells: G-033108 (west), G-029832 (east)
Respective pumping levels 204 and 220 ft. at 1100 and 1500 gpm. Middle Republican NRD certified acres: 170.4 (west), 165.5 (east). 63" remaining through 2022.

Soils:

Primarily Valentine sand, 20% Dundy-Hersh soils.

Improvements & Equipment:

West: 10 tower Zimmatic, impact sprinklers with 150 HP High Thrust electric motor;
East: 9 tower Zimmatic (new in 2012), drops with 150 HP US Electric motor.

Price:

\$1,300,000 or \$3,861/Irrigated Acre

Comments:

Great county road access to two center pivots with excellent water factors. Very good terrain and productivity on 335.9 Certified Irrigated Acres.

Contact:

Mike Polk; Co-Listing Agent
308-539-4446 or mike@agriaffiliates.com
John Childears; Co-Listing Agent
308-539-4450 or john@agriaffiliates.com
Bruce Dodson, Brian Reynolds, Chase Dodson,
Don Walker, Tony Eggleston



Mike Polk,
Co-Listing Agent



John Childears,
Co-Listing Agent

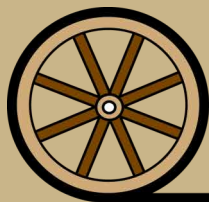

Offered Exclusively By:

AGRI AFFILIATES, INC.
Providing Farm - Ranch Real Estate Services

Information contained herein was obtained from sources deemed reliable. We have no reason to doubt the accuracy, but the information is not guaranteed. Prospective Buyers should verify all information. All maps provided by Agri Affiliates, Inc. are approximations only, to be used as a general guideline, and not intended as survey accurate. As with any agricultural land, this property may include noxious weeds. Agri Affiliates, Inc. and all agents are acting as Agent of the Seller.

NORTH PLATTE OFFICE

P.O. Box 1166
401 Halligan Drive
North Platte, NE 69103
www.agriaffiliates.com

(308) 534-9240

Fax (308) 534-9244





Offered by-



agriaffiliates.com 308.534.9240

AGRI AFFILIATES, INC.
Providing Farm - Ranch Real Estate Services

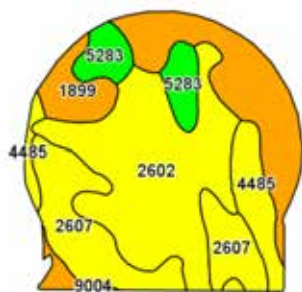
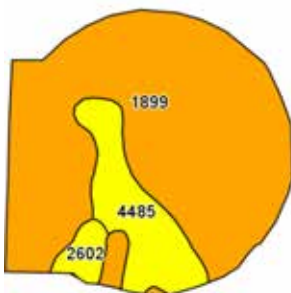
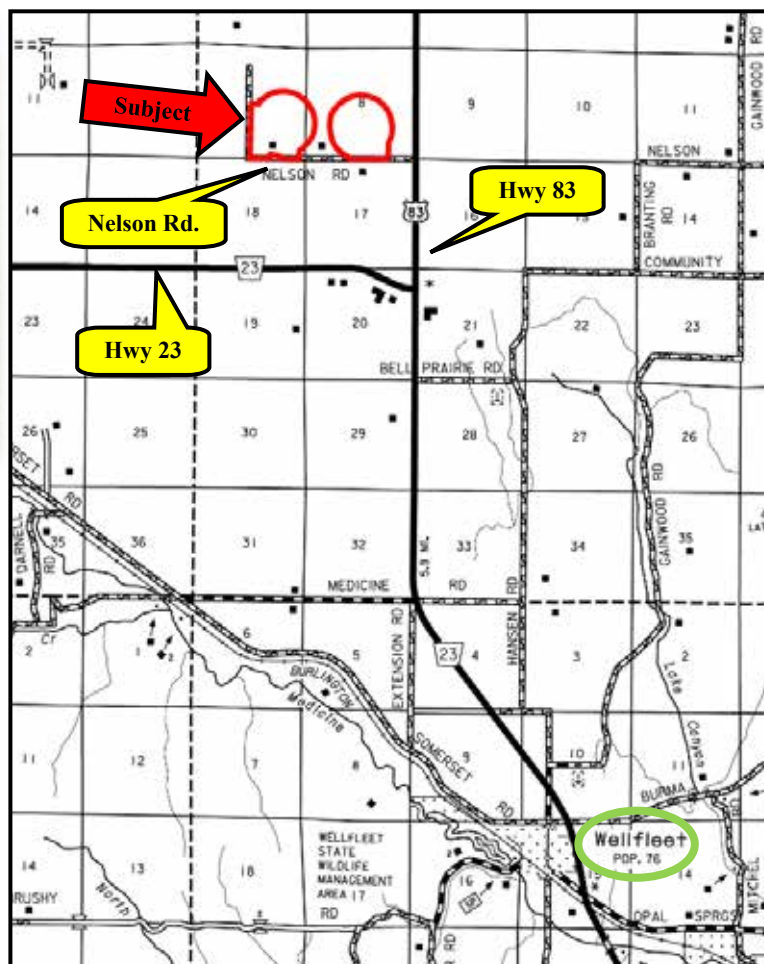

Code	Soil Description	Acres	Percent of field	Non-Irr Class Legend	Non-Irr Class °c	Irr Class °c
1899	Valent sand, rolling	193.07	53.8%		Ive	Ive
2602	Hersh soils, 6 to 11 percent slopes	71.16	19.8%		Ive	Ive
4485	Dunday loamy fine sand, 0 to 3 percent slopes	44.51	12.4%		Ive	Ille
2607	Hersh-Valentine loamy fine sands, 0 to 6 percent slopes	36.04	10.0%		Ive	Ive
5283	Vetal fine sandy loam, loamy substratum, 0 to 3 percent slopes	13.49	3.8%		Ille	Ille
9004	Anselmo fine sandy loam, 3 to 6 percent slopes	0.76	0.2%		Ille	Ille