

Soils Map

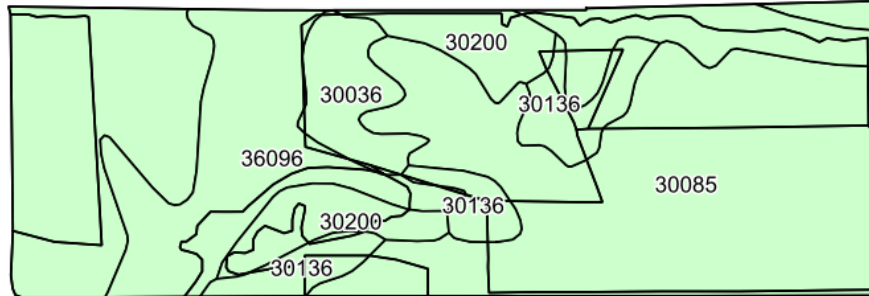

©2019 AgriData, Inc.

Soils data provided by USDA and NRCS.

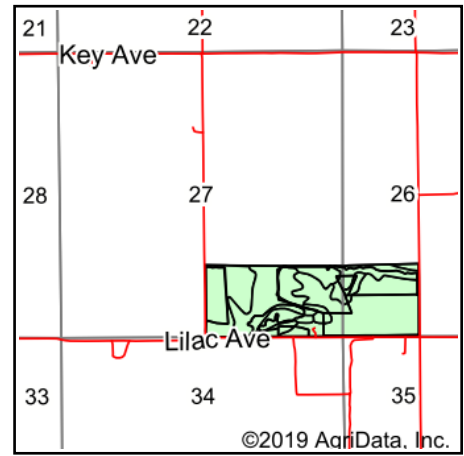

State: **Missouri**
 County: **Daviess**
 Location: **27-60N-27W**
 Township: **Grand River**
 Acres: **120.73**
 Date: **7/1/2019**

Maps Provided By:

 CUSTOMIZED ONLINE MAPPING
 © AgriData, Inc. 2019 www.AgriDataInc.com



Area Symbol: MO061. Soil Area Version: 20

Code	Soil Description	Acres	Percent of field	Non-Irr Class *c	*n NCCPI Soybeans
30085	Grundy silt loam, 2 to 5 percent slopes	70.85	58.7%	Ile	64
36096	Zook silty clay loam, 1 to 5 percent slopes, frequently flooded	25.62	21.2%	IIIw	60
30200	Shelby loam, 9 to 14 percent slopes	9.34	7.7%	IIIe	63
30136	Lamoni loam, 5 to 9 percent slopes	9.16	7.6%	IIIe	57
30036	Armstrong loam, 5 to 9 percent slopes	5.76	4.8%	IIIe	52
Weighted Average					*n 62

*n: The aggregation method is "Weighted Average using major components"

*c: Using Capabilities Class Dominant Condition Aggregation Method

Soils data provided by USDA and NRCS.