

Soils Map

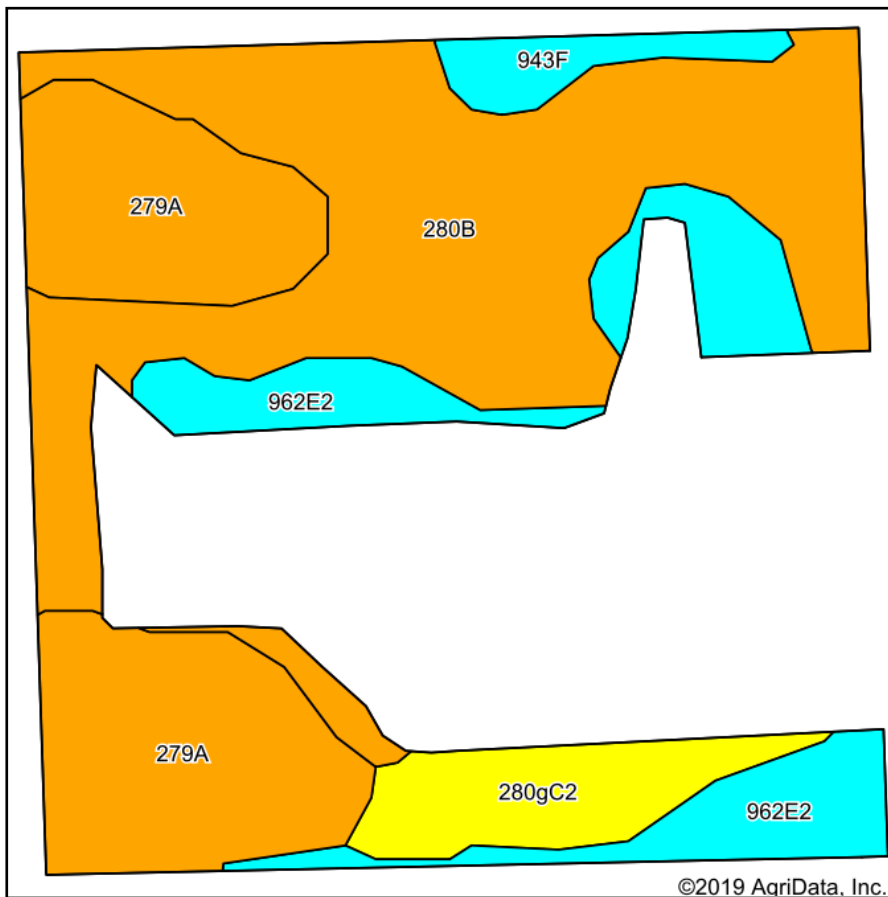

Soils data provided by USDA and NRCS.

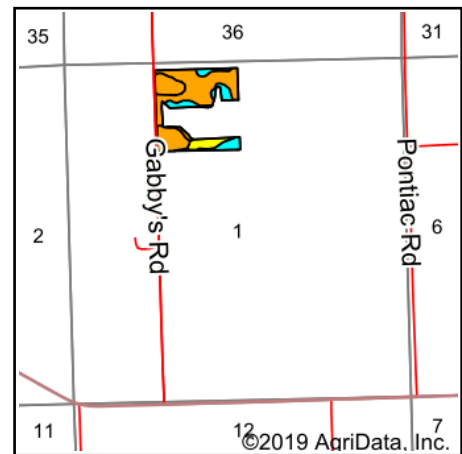

State: **Illinois**
 County: **Cass**
 Location: **1-18N-9W**
 Township: **Panther Creek**
 Acres: **24.53**
 Date: **5/23/2019**



Maps Provided By:

 CUSTOMIZED ONLINE MAPPING
 © AgriData, Inc. 2019 www.AgriDataInc.com



Area Symbol: IL017, Soil Area Version: 14

Code	Soil Description	Acres	Percent of field	Il. State Productivity Index Legend	Subsoil rooting a	Corn Bu/A	Soybeans Bu/A	Wheat Bu/A	Oats Bu/A b	Sorghum Bu/A c	Alfalfa d hay, T/A	Grass-le gume e hay, T/A	Crop productivity index for optimum management
**280B	Fayette silt loam, glaciated, 2 to 5 percent slopes	11.22	45.7%		FAV	**165	**52	**65	**84	0	**5.22	0.00	**121
279A	Rozetta silt loam, 0 to 2 percent slopes	6.66	27.2%		FAV	164	51	65	84	0	5.27	0.00	120
**962E2	Sylvan-Bold silt loams, 18 to 25 percent slopes, eroded	3.88	15.8%		FAV	**115	**35	**44	**53	0	0.00	**3.12	**83
**280gC2	Fayette silt loam, glaciated, 5 to 10 percent slopes, eroded	1.96	8.0%		FAV	**155	**49	**61	**79	0	**4.90	0.00	**113
**943F	Seaton-Timula silt loams, 18 to 35 percent slopes	0.81	3.3%		FAV	**115	**36	**44	**57	0	**2.99	0.00	**84
Weighted Average						154.4	48.3	60.7	77.8	*-	4.31	0.49	112.9

Table: Optimum Crop Productivity Ratings for Illinois Soil by K.R. Olson and J.M. Lang, Office of Research, ACES, University of Illinois at Champaign-Urbana. Version: 1/2/2012 Amended Table S2 B811

Crop yields and productivity indices for optimum management (B811) are maintained at the following NRES web site: <http://soilproductivity.nres.illinois.edu/>

** Indexes adjusted for slope and erosion according to Bulletin 811 Table S3

a UNF = unfavorable; FAV = favorable

b Soils in the southern region were not rated for oats and are shown with a zero "0".

c Soils in the northern region or in both regions were not rated for grain sorghum and are shown with a zero "0".

d Soils in the poorly drained group were not rated for alfalfa and are shown with a zero "0".

e Soils in the well drained group were not rated for grass-legume and are shown with a zero "0".

Soils data provided by USDA and NRCS. Soils data provided by University of Illinois at Champaign-Urbana.

*c: Using Capabilities Class Dominant Condition Aggregation Method