



DWIGHT L. STEWART, JR. AND ASSOCIATES, LLC
CONSULTING FORESTERS
26 E. BOYCE STREET
MANNING, SOUTH CAROLINA 29102
(803) 435-2301

REGISTERED FORESTERS

DWIGHT L. STEWART, JR.
G. WARD GATLIN
T. HARVEY BELSER

REAL ESTATE

DWIGHT L. STEWART, JR.
G. WARD GATLIN

LAND FOR SALE

DREW TIMBERLANDS, LLC

LOCATION: Aiken COUNTY, SC
TAX MAP # 217-00-12-002

ACREAGE SUMMARY: Upland pine **70 acres (+-)**

FINANCIAL TERMS: Cash at Closing

SALES PRICE: \$129,500.00 (\$1,850/acre)

COMMENTS:

The tract is located about 3 miles southwest of I-20 and Hwy. 39 (mile marker 33). The tract has road frontage along Grady Pond Road and Harness Road. The timber was harvested several years ago and the tract has a mixed stand of pine and hardwood regeneration. The property will make an excellent hunting and outdoor recreation tract that is located conveniently to Aiken, Augusta and Columbia.

The above information is considered correct, but is not guaranteed. Acreage information was taken from existing plats and tax assessor's records. Buyer should have a routine title examination performed by an attorney. Dwight L. Stewart, Jr. is a licensed real estate broker representing himself as part owner of the tract.

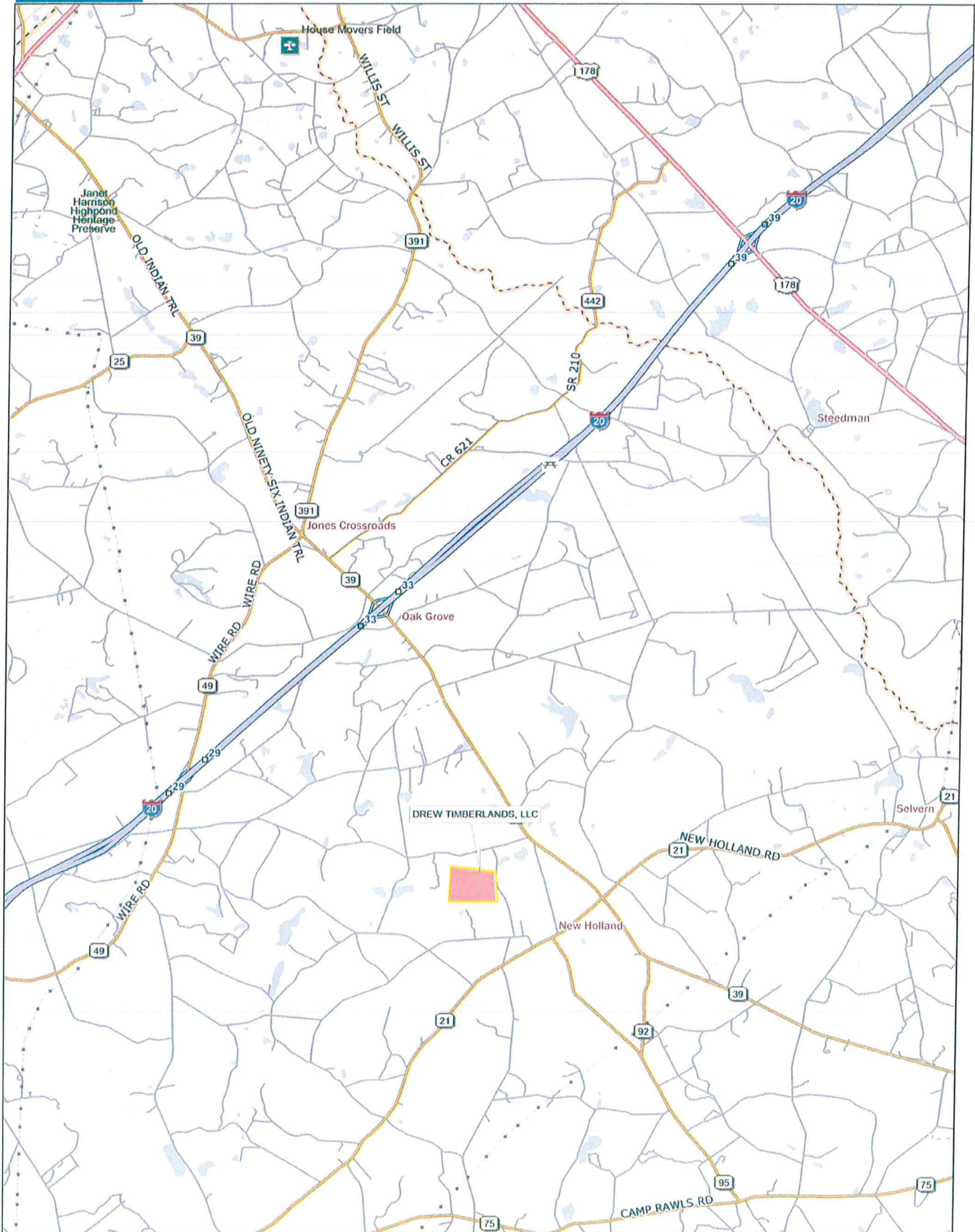

Data use subject to license.

© DeLorme. DeLorme Street Atlas USA® 2015.

www.delorme.com

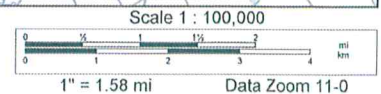

Data Zoom 11-0

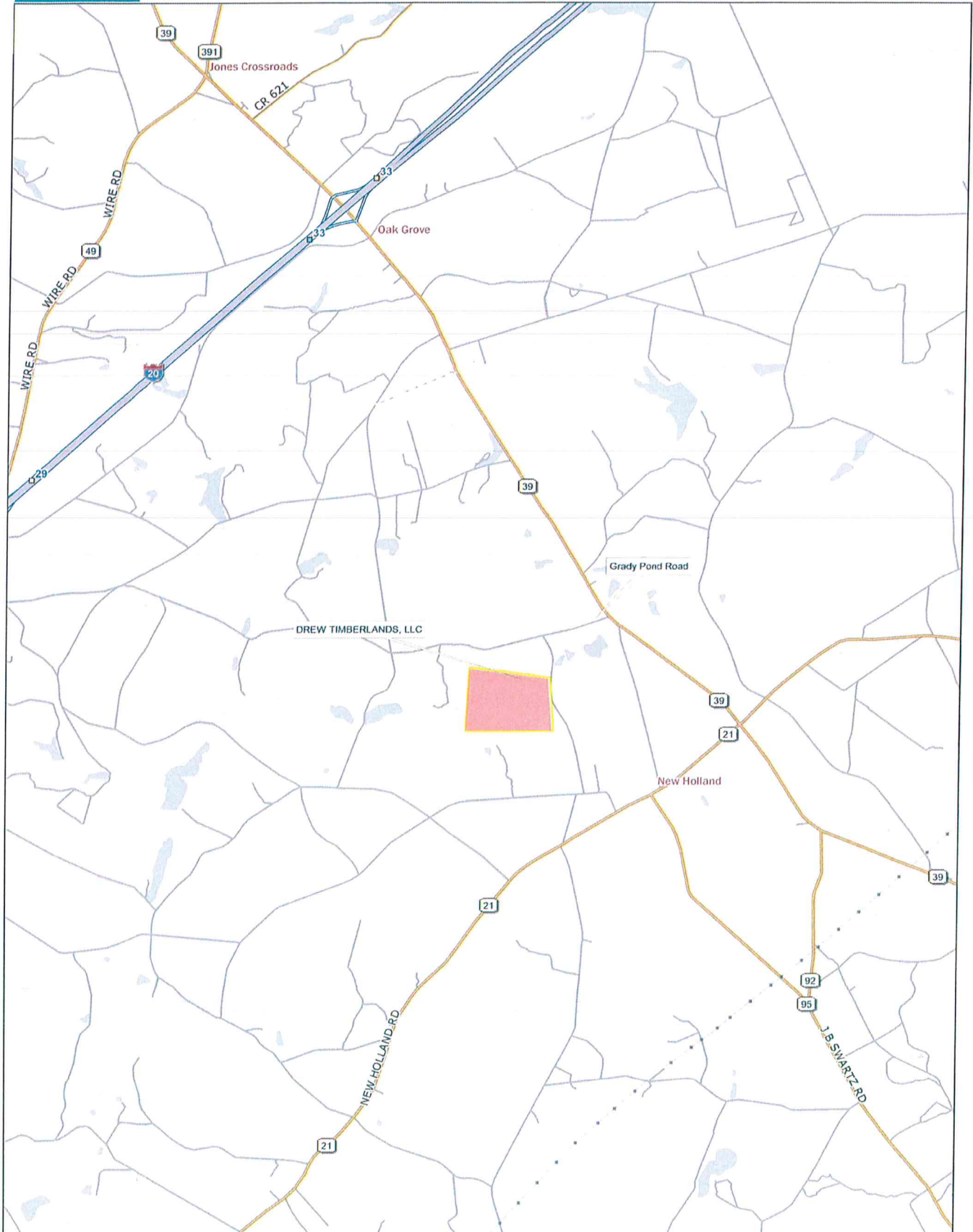

Data use subject to license.

© DeLorme, DeLorme Street Atlas USA® 2015.

www.delorme.com

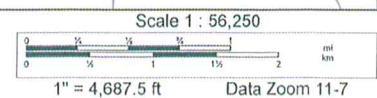

Drew Timberlands, LLC

Aiken County, SC

Approx. 70 acres

January 7, 2019

Property Lines are approx.

Legend

 50 foot road frontage

