

Soils Map

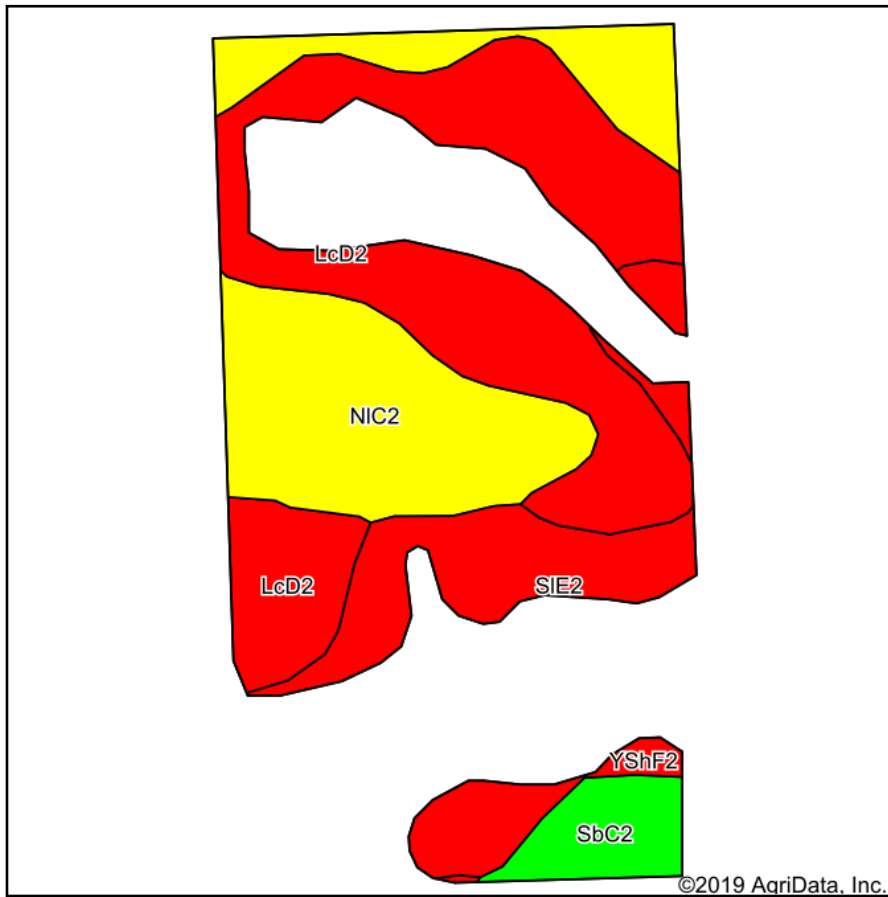

Soils data provided by USDA and NRCS.

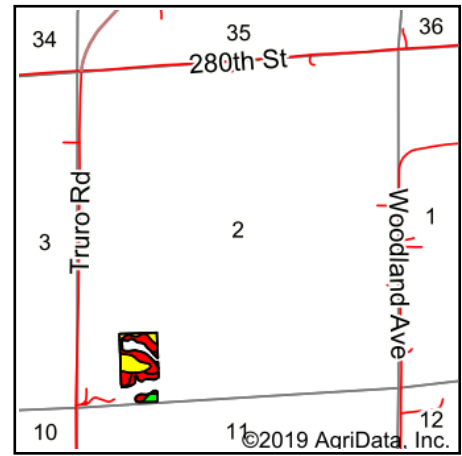

State: **Iowa**
 County: **Madison**
 Location: **2-74N-26W**
 Township: **Ohio**
 Acres: **10.62**
 Date: **9/3/2019**

PC PEOPLES
 COMPANY
 INNOVATIVE. REAL ESTATE. SOLUTIONS.

Maps Provided By:
surety
 CUSTOMIZED ONLINE MAPPING
 © AgriData, Inc. 2019 www.AgriDataInc.com



Area Symbol: IA121, Soil Area Version: 22													
Code	Soil Description	Acres	Percent of field	CSR2 Legend	Non-Irr Class *c	*i Corn	*i Soybeans	CSR2**	CSR	*n NCCPI Overall	*n NCCPI Corn	*n NCCPI Soybeans	
LcD2	Lamoni clay loam, 9 to 14 percent slopes, moderately eroded	4.51	42.5%		IVe	100.8	29.2	10	15	52	52	45	
NIC2	Nira silty clay loam, dissected till plain, 5 to 9 percent slopes, eroded	3.40	32.0%		IIIe	187.2	54.3	68	64	80	80	68	
SIE2	Shelby-Lamoni complex, 14 to 18 percent slopes, moderately eroded	1.99	18.7%		Vle	88	25.5	27	10	59	59	46	
SbC2	Sharpsburg silty clay loam, 5 to 9 percent slopes, eroded	0.62	5.8%		IIIe	204.8	59.4	80	67	71	71	63	
YShF2	Shelby clay loam, dissected till plain, 18 to 25 percent slopes, eroded	0.10	0.9%		Vle	0	0	20		49	49	35	
Weighted Average						131.2	38	35.9	*	*n 63.4	*n 63.4	*n 53.5	

**IA has updated the CSR values for each county to CSR2.

*- CSR weighted average cannot be calculated on the current soils data, use prior data version for csr values.

*i Yield data provided by the ISPAID Database version 8.1.1 developed by IA State University.

*n: The aggregation method is "Weighted Average using major components"

*c: Using Capabilities Class Dominant Condition Aggregation Method

Soils data provided by USDA and NRCS.