

# T.II.S.R.I W.W.M.

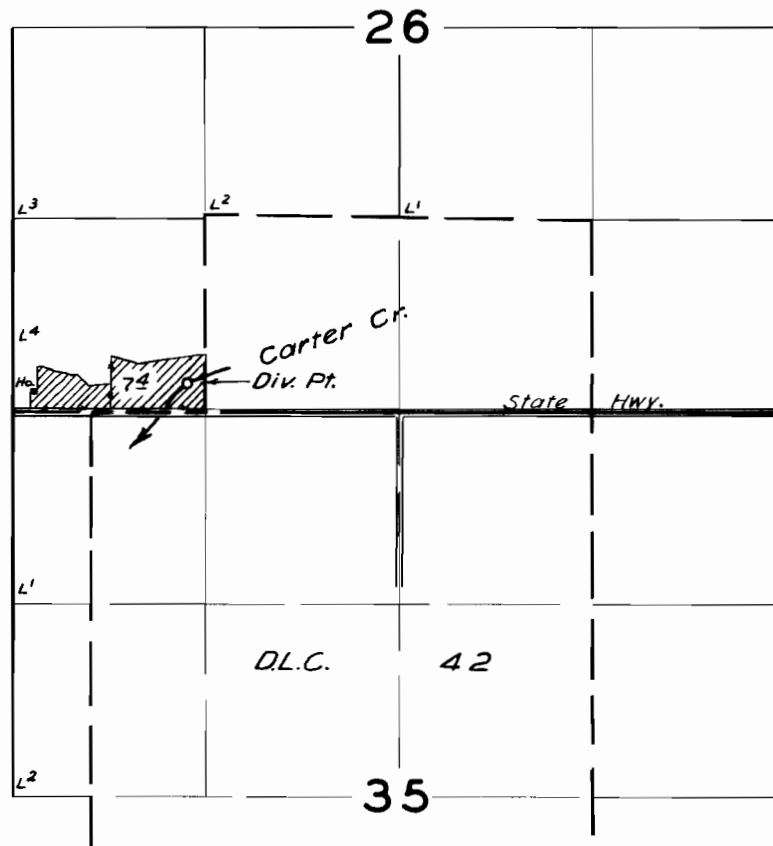

## FINAL PROOF SURVEY UNDER

Application No. 24096 Permit No. 18974  
IN NAME OF

Clifford & J.E. Mork

Surveyed June 7, 1957, by m. Rich

## \* APPLICATION FOR PERMIT

CERTIFICATE NO. 24201

## To Appropriate the Public Waters of the State of Oregon

I, Clifford Mork and J. E. Mork  
(Name of applicant)  
 of Star Rt#1, Lebanon  
(Mailing address)  
 State of Ore., do hereby make application for a permit to appropriate the following described public waters of the State of Oregon, **SUBJECT TO EXISTING RIGHTS:**

If the applicant is a corporation, give date and place of incorporation

1. The source of the proposed appropriation is Carter Creek  
(Name of stream)

, a tributary of Bever Creek

2. The amount of water which the applicant intends to apply to beneficial use is 0.25  
 cubic feet per second.  
(If water is to be used from more than one source, give quantity from each)

\*\*3. The use to which the water is to be applied is Irrigation  
(Irrigation, power, mining, manufacturing, domestic supplies, etc.)

4. The point of diversion is located ft. and ft. from the  
(N. or S.) (E. or W.)  
~~corner of~~ at any point where Carter Creek  
(Section or subdivision)  
touches property described herein

(If preferable, give distance and bearing to section corner)

(If there is more than one point of diversion, each must be described. Use separate sheet if necessary)  
 being within the S.W. 1/4 S.W. 1/4 of Sec. 26, Tp. 11-S  
(Give smallest legal subdivision) (N. or S.)

R. 1-W, W. M., in the county of Linn  
(E. or W.)

5. The to be  
(Main ditch, canal or pipe line) (Miles or feet)  
 in length, terminating in the of Sec. , Tp. ,  
(Smallest legal subdivision) (N. or S.)  
 R. W. M., the proposed location being shown throughout on the accompanying map.  
(E. or W.)

## DESCRIPTION OF WORKS

## Diversion Works—

6. (a) Height of dam feet, length on top feet, length at bottom feet; material to be used and character of construction (Loose rock, concrete, masonry, rock and brush, timber crib, etc., wasteway over or around dam)

(b) Description of headgate (Timber, concrete, etc., number and size of openings)

(c) If water is to be pumped give general description 2 in. portable pump  
(Size and type of pump)

9 HP gas engine  
(Size and type of engine or motor to be used, total head water is to be lifted, etc.)

18 - 8 1/2 gpm sprinklers

\* A different form of application is provided where storage works are contemplated.

\*\* Application for permits to appropriate water for the generation of electricity, with the exception of municipalities, must be made to the Hydroelectric Commission. Either of the above forms may be secured, without cost, together with instructions by addressing the State Engineer, Salem, Oregon.

## Canal System or Pipe Line—

7. (a) Give dimensions at each point of canal where materially changed in size, stating miles from headgate. At headgate: width on top (at water line) ..... feet; width on bottom ..... feet; depth of water ..... feet; grade ..... feet fall per one thousand feet.

(b) At ..... miles from headgate: width on top (at water line) ..... feet; width on bottom ..... feet; depth of water ..... feet; grade ..... feet fall per one thousand feet.

(c) Length of pipe, ..... ft.; size at intake, ..... in.; size at ..... ft. from intake ..... in.; size at place of use ..... in.; difference in elevation between intake and place of use, ..... ft. Is grade uniform? ..... Estimated capacity, ..... sec. ft.

## 8. Location of area to be irrigated, or place of use .....

Township	Range	Section	Forty-acre Tract	Number Acres To Be Irrigated
11-S	1-W	26	S.W. $\frac{1}{4}$ S.W. $\frac{1}{4}$	20

(If more space required, attach separate sheet)

(a) Character of soil ..... Clay loam .....(b) Kind of crops raised ..... corn grain garden products .....

## Power or Mining Purposes—

9. (a) Total amount of power to be developed ..... theoretical horsepower.

(b) Quantity of water to be used for power ..... sec. ft.

(c) Total fall to be utilized ..... feet.  
(Head)

(d) The nature of the works by means of which the power is to be developed .....

(e) Such works to be located in ..... of Sec. ....  
(Legal Subdivision)Tp. ...., R. ...., W. M.  
(No. N. or S.) (No. E. or W.)(f) Is water to be returned to any stream? .....  
(Yes or No)

(g) If so, name stream and locate point of return .....

....., Sec. ...., Tp. ...., R. ...., W. M.  
(No. N. or S.) (No. E. or W.)

(h) The use to which power is to be applied is .....

(i) The nature of the mines to be served .....

## Municipal or Domestic Supply—

10. (a) To supply the city of .....

..... County, having a present population of .....

and an estimated population of ..... in 19.....

(b) If for domestic use state number of families to be supplied .....

(Answer questions 11, 12, 13, and 14 in all cases)

11. Estimated cost of proposed works, \$ 750.00

12. Construction work will begin on or before One year after approval

13. Construction work will be completed on or before Two years " "

14. The water will be completely applied to the proposed use on or before 3 yrs. " " .....

(Sgd) Clifford Mork

(Signature of applicant)

(Sgd) J. E. Mork

By Clifford Mork

Remarks: .....

STATE OF OREGON, }  
County of Marion, } ss.

*This is to certify that I have examined the foregoing application, together with the accompanying maps and data, and return the same for .....*

In order to retain its priority, this application must be returned to the State Engineer, with corrections on or before \_\_\_\_\_, 19\_\_\_\_\_.

WITNESS my hand this ..... day of ....., 19.....

STATE ENGINEER

Application No. 24096

Permit No. 18974

PERMIT  
TO APPROPRIATE THE PUBLIC  
WATERS OF THE STATE  
OF OREGON

Division No. District No.

This instrument was first received in the  
office of the State Engineer at Salem, Oregon,  
on the 9th day of September,  
1949, at 2:00 o'clock P. M.

Returned to applicant:

Corrected application received:

Approved:

March 15, 1950

Recorded in book No. 46 of  
Permits on page 18974

CHAS. E. STRICKLIN

STATE ENGINEER

Drainage Basin No. 2 Page 44

Fees Paid \$15.00

PERMIT

STATE OF OREGON, }  
County of Marion, } ss.

This is to certify that I have examined the foregoing application and do hereby grant the same,  
SUBJECT TO EXISTING RIGHTS and the following limitations and conditions:

The right herein granted is limited to the amount of water which can be applied to beneficial use  
and shall not exceed 0.25 cubic feet per second measured at the point of diversion from the  
stream, or its equivalent in case of rotation with other water users, from Carter Creek

The use to which this water is to be applied is irrigation

If for irrigation, this appropriation shall be limited to 1/80th of one cubic foot per  
second or its equivalent for each acre irrigated and shall be further limited to a  
diversion of not to exceed 2 1/2 acre feet per acre for each acre irrigated during the  
irrigation season of each year,

and shall be subject to such reasonable rotation system as may be ordered by the proper state officer.

The priority date of this permit is September 9, 1949

Actual construction work shall begin on or before March 15, 1951 and shall  
thereafter be prosecuted with reasonable diligence and be completed on or before

October 1, 1952  
Extended to Oct 1, 1954

Complete application of the water to the proposed use shall be made on or before

October 1, 1953  
Extended to Oct 1, 1954

WITNESS my hand this 15th day of March, 1950

CHAS. E. STRICKLIN

STATE ENGINEER

Permits for power development are subject to the payment of annual fees as provided in sections 1 and 2, chapter 74, Oregon Laws 1933.

## STATE OF OREGON

COUNTY OF LINN

## CERTIFICATE OF WATER RIGHT

This Is to Certify, That CLIFFORD and J. E. MORK

of Star Route 1, Lebanon, State of Oregon, has made proof to the satisfaction of the STATE ENGINEER of Oregon, of a right to the use of the waters of Carter Creek

a tributary of Beaver Creek for the purpose of irrigation of 7.4 acres

under Permit No. 18974 of the State Engineer, and that said right to the use of said waters has been perfected in accordance with the laws of Oregon; that the priority of the right hereby confirmed dates from September 9, 1949,

that the amount of water to which such right is entitled and hereby confirmed, for the purposes aforesaid, is limited to an amount actually beneficially used for said purposes, and shall not exceed 0.09 cubic foot per second,

or its equivalent in case of rotation, measured at the point of diversion from the stream. The point of diversion is located in the Lot 4 (SW $\frac{1}{4}$  SW $\frac{1}{4}$ ), Section 26, Township 11 South, Range 1 West, W.M.

The amount of water used for irrigation, together with the amount secured under any other right existing for the same lands, shall be limited to one-eightieth of one cubic foot per second per acre or its equivalent for each acre irrigated and shall be further limited to a diversion of not to exceed 2 $\frac{1}{2}$  acre feet per acre for each acre irrigated during the irrigation season of each year,

and shall conform to such reasonable rotation system as may be ordered by the proper state officer.

A description of the place of use under the right hereby confirmed, and to which such right is appurtenant, is as follows:

7.4 acres Lot 4 (SW $\frac{1}{4}$  SW $\frac{1}{4}$ )  
Section 26  
Township 11 South, Range 1 West, W.M.

The right to the use of the water for the purposes aforesaid is restricted to the lands or place of use herein described.

WITNESS the signature of the State Engineer, affixed

this 31st day of July, 1958.

LEWIS A. STANLEY

State Engineer